

MEGACUT

CATALOGO

CIRCULAR SAW - T.C.T. HOLE SAW - BROACHING TOOL

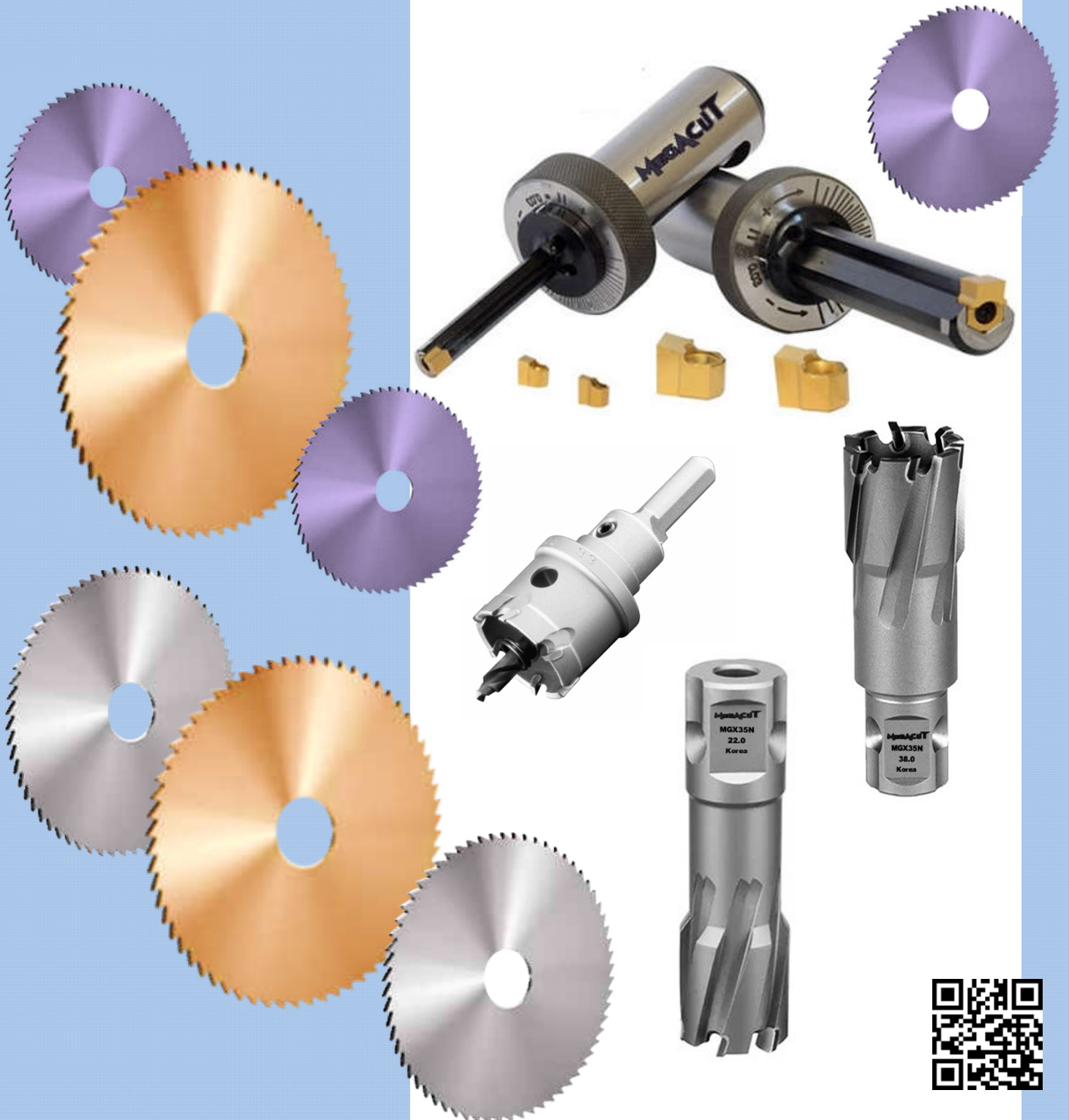



MEGACUT

Chiave di lettura catalogo | Key to catalogue | Katalogsleseschlüssel | Légende
 catalogue Leyenda del catálogo

02

SEGHE CIRCOLARI CON DENTATURA FINE E GROSSA

CIRCULAR SAW BLADES WITH FINE AND COARSE TEETH | KREISSÄGEBLÄTTER FEIN UND GROSSVERZAHNT
 FRAISES SCIES DENTURE FINE ET LARGE | SIERRAS CIRCULARES DENTADO FINO Y GRUESO

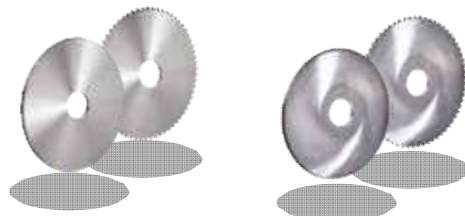

MGS01	HM	DIN 1837		03÷27
MGS02	HM	DIN 1838		03÷27
MGS03	HSS-Co5	DIN 1837		03÷27
MGS04	HSS-Co5	DIN 1838		03÷27

SEGHE CIRCOLARI PER TRONCATRICI

CIRCULAR SAW BLADES FOR CUT-OFF MACHINES | MASCHINENKREISSÄGEBLÄTTER
 FRAISES SCIES CIRCULAIRES POUR MACHINES A TRONCONNER | SIERRAS CIRCULARES PARA MÁQUINAS TRONZADORAS



MGS05	HSS-Co5			28
-------	---------	--	--	----

GUIDA TECNICA

TECHNICAL GUIDE | TECHNISCHE DATEN | GUIDE TECHNIQUE | GUÍA TÉCNICA

Parametri di taglio consigliati | Cutting parameters suggested | Formule -
 Calculation average chip thickness (hm) | Calculation average chip thickness (hm)

30-33

RIVESTIMENTI E AFFILATURE SPECIALI A RICHIESTA

SPECIAL COATINGS AND SHARPENINGS ON REQUEST | BESCHICHTUNGEN UND SONDERSCHEIFEN AUF ANFRAGE
 REVÊTEMENTS ET AFFÛTAGES SPÉCIAUX SUR DEMANDE | RECUBRIMIENTOS Y AFILADOS ESPECIALES BAJO DEMANDA

T.C.T. HOLE SAW



34-47

BROACHING TOOL

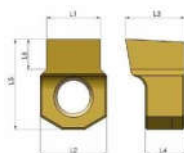

48-60



CHIAVE DILETTURA CATALOGO

KEY TO CATALOGUE | KATALOGSLESESCHLÜSSEL
LÉGENDE CATALOGUE | LEYENDA DELCATÁLOGO

10
SEGHE CIRCOLARI CON DENTATURA FINE E GROSSA
CIRCULAR SAW BLADES WITH FINE AND COARSE TEETH | KREISSÄGEBLÄTTER FEIN UND GROSSVERZAHNT
FRAISES SCIÉS DENTURE FINE ET LARGE | SIERRAS CIRCULARES DENTADO FINO Y GRUESO

2 (HM) | 3 (HSS-Co5) | 4 (DIN 1837) | 5 (DIN 1838)

6

7

D x b	d ₁	d	MGS01		MGS02		MGS03		MGS04		8
			DIN 1837	DIN 1838	DIN 1837	DIN 1838	DIN 1837	DIN 1838	DIN 1837	DIN 1838	
			Z	HM	C	Z	C	Z	C		
30X1.2	8	-	48	20	46,80	48	32	16,65			
30X1.3	8	-	48	20	48,60	-	-	-			
30X1.4	8	-	48	20	49,90	-	-	-			
30X1.5	8	-	48	20	51,10	48	32	17,55			
30X1.6	8	-	48	20	54,80	48	32	17,70			
30X1.7	8	-	48	20	54,80	-	-	-			
30X1.8	8	-	48	20	58,60	-	-	-			
30X1.9	8	-	48	20	60,40	-	-	-			
30X2	8	-	48	20	62,30	48	32	20,50			
30X2.5	8	-	40	20	70,40	40	24	23,05			
30X3	8	-	40	18	81,00	40	24	27,45			
30X3.5	8	-	-	-	-	40	24	32,65			
30X4	8	-	-	-	-	-	-	35,40			
30X5	8	-	-	-	-	-	-	-			

● **Tipologia utensile** | Tool type
Werkzeugtyp | Typologie de l'outil
Tipología herramienta

2 **(HM)** | **Metallo duro** | Solid carbide
Vollhartmetall | Carbure monobloc
Metal duro

3 **(HSS-Co5)** | **Acciaio super rapido**
High speed steel | Hochleistungsschnittstahl
Acier rapide | Acero rapido

4 **(DIN 1837)**
Seghe circolari con dentatura fine
Circular saw blades with fine teeth
Kreissägeblätter feinverzahnt
Fraises sciés denture fine
Sierras circulares dentado fino

5 **(DIN 1838)**
Seghe circolari con dentatura grossa
Circular saw blades with coarse teeth
Kreissägeblätter großverzahnt
Fraises sciés denture large
Sierras circulares dentado grueso

6 **Disegno tecnico** | Technical drawing
Technische Zeichnung | Plan technique
Dibujo técnico

7 **Quote dimensionali** | Dimensional quotes
Abmessungen | Valeurs dimensionnelles
Tamaño

8 **Codice prodotto** | Item code
Katalognummer | Référence produit
Código referencia

1 (D) | 2 (d) | 3 (d1) | 4 (b)

MGS01	MGS02	MGS

1 **(D)** | **Diametro utensile** | Tool diameter
Werkzeugsdurchmesser | Diamètre de l'outil
Diametro de la herramienta

2 **(d)** | **Diametro mozzo** | Hub diameter
Bund Durchmesser | Diamètre du moyeu
Diametro del anillo

3 **(d₁)** | **Diametro foro** | Central hole diameter
Bohrung Durchmesser | Diamètre de l'alesage
Diametro de l'eje

4 **(b)** | **Spessore utensile** | Tool thickness
Werkzeugsbreite | Épaisseur de l'outil
Espesor de la herramienta



SEGHE CIRCOLARI CON DENTATURA FINE E GROSSA

CIRCULAR SAW BLADES WITH FINE AND COARSE TEETH | KREISSÄGEBLÄTTER FEIN UND GROSSVERZAHNT
 FRAISES SCIÉS DENTURE FINE ET LARGE | SIERRAS CIRCULARES DENTADO FINO Y GRUESO

HM	HSS-Co5	DIN 1837	DIN 1838
----	---------	----------	----------

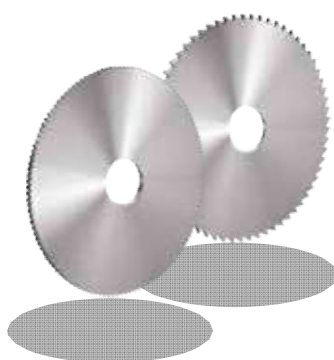
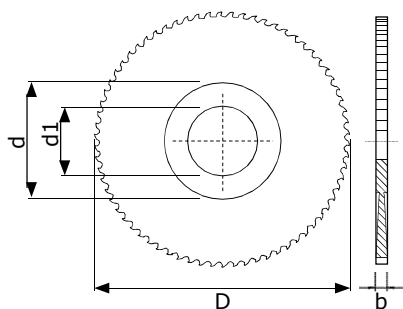

		*MGS03 *MGS04	HM		HSS-Co5			
			MGS01 DIN 1837	MGS02 DIN 1838	MGS03 DIN 1837	MGS04 DIN 1838		
D x b	d ₁	d	Z		€	Z		€

12X0.2	5	-	48	16	22,40	-	-	-
12X0.25	5	-	48	16	22,40	-	-	-
12X0.3	5	-	48	16	22,40	-	-	-
12X0.35	5	-	48	16	23,30	-	-	-
12X0.4	5	-	48	16	23,30	-	-	-
12X0.45	5	-	40	16	23,30	-	-	-
12X0.5	5	-	40	16	24,10	-	-	-
12X0.6	5	-	40	16	25,80	-	-	-
12X0.7	5	-	40	16	28,30	-	-	-
12X0.8	5	-	32	16	28,30	-	-	-
12X0.9	5	-	32	16	29,05	-	-	-
12X1	5	-	32	16	30,70	-	-	-
12X1.1	5	-	32	16	30,70	-	-	-
12X1.2	5	-	32	16	32,40	-	-	-
12X1.3	5	-	32	16	32,40	-	-	-
12X1.4	5	-	32	12	34,00	-	-	-
12X1.5	5	-	32	12	35,65	-	-	-
12X1.6	5	-	32	12	37,40	-	-	-

Esempio d'ordine | Ordering example | Bestellbeispiel | Exemple de commande | Ejemplo de pedido: **MGS01 - (D x b)**

* Mozzo presente solo nelle seghe in HSS-Co5 | Hub present only in the HSS-Co5 saws | Bund ist nur in den HSS-Co5 Sägeblätter vorhanden | Epaulement présent seulement sur les fraises sciés en Hss-Co5 | Anillo presente solamente en las sierras in Hss Hss-Co5



SEGHE CIRCOLARI CON DENTATURA FINE E GROSSA

CIRCULAR SAW BLADES WITH FINE AND COARSE TEETH | KREISSÄGEBLÄTTER FEIN UND GROSSVERZAHNT
 FRAISES SCIÉS DENTURE FINE ET LARGE | SIERRAS CIRCULARES DENTADO FINO Y GRUESO

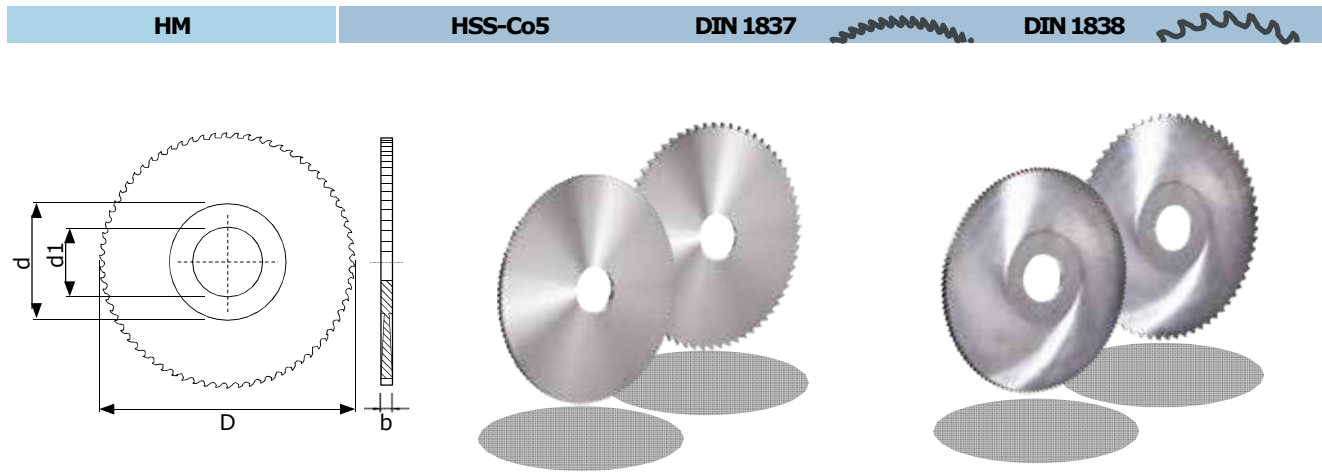

		*MGS03 *MGS04	HM		€	HSS-Co5		€
			MGS01 DIN 1837	MGS02 DIN 1838		MGS03 DIN 1837	MGS04 DIN 1838	
D x b	d ₁	d	Z			Z		

12X1.7	5	-	24	12	39,00	-	-	-
12X1.8	5	-	24	12	40,70	-	-	-
12X1.9	5	-	24	12	40,70	-	-	-
12X2	5	-	24	12	42,30	-	-	-
12X2.5	5	-	24	12	57,30	-	-	-
12X3	5	-	24	12	64,00	-	-	-
12X4	5	-	20	12	90,60	-	-	-
12X5	5	-	20	12	107,00	-	-	-
12X6	5	-	20	12	132,50	-	-	-

15X0.2	5	-	64	24	23,30	-	-	-
15X0.25	5	-	64	24	23,30	-	-	-
15X0.3	5	-	64	24	23,30	-	-	-
15X0.35	5	-	64	24	24,10	-	-	-
15X0.4	5	-	64	24	24,10	-	-	-
15X0.45	5	-	48	20	24,10	-	-	-
15X0.5	5	-	48	20	24,90	-	-	-
15X0.6	5	-	48	20	26,60	-	-	-

Esempio d'ordine | Ordering example | Bestellbeispiel | Exemple de commande | Ejemplo de pedido: **MGS01 - (D x b)**

* Mozzo presente solo nelle seghe in HSS-Co5 | Hub present only in the HSS-Co5 saws | Bund ist nur in den HSS-Co5 Sägeblätter vorhanden | Epaulement présent seulement sur les fraises sciés en Hss-Co5 | Anillo presente solamente en las sierras en Hss Hss-Co5



SEGHE CIRCOLARI CON DENTATURA FINE E GROSSA

CIRCULAR SAW BLADES WITH FINE AND COARSE TEETH | KREISSÄGEBLÄTTER FEIN UND GROSSVERZAHNT
 FRAISES SCIÉS DENTURE FINE ET LARGE | SIERRAS CIRCULARES DENTADO FINO Y GRUESO

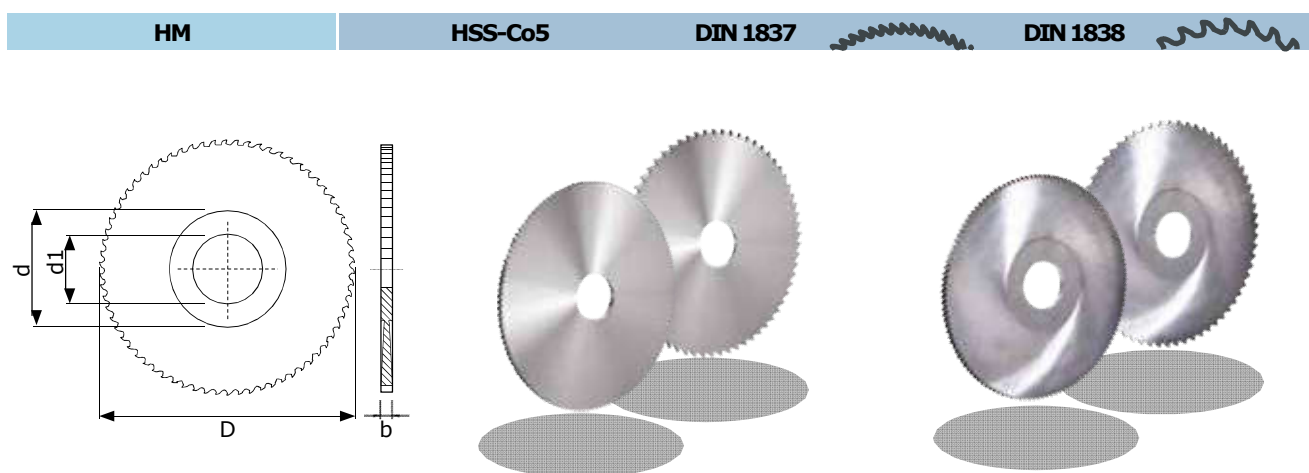

		*MGS03 *MGS04	HM		€	HSS-Co5		€
			MGS01 DIN 1837	MGS02 DIN 1838		MGS03 DIN 1837	MGS04 DIN 1838	
D x b	d ₁	d	Z			Z		

15X0.7	5	-	48	20	29,05	-	-	-
15X0.8	5	-	40	20	29,05	-	-	-
15X0.9	5	-	40	16	29,95	-	-	-
15X1	5	-	40	16	31,50	-	-	-
15X1.1	5	-	40	16	31,50	-	-	-
15X1.2	5	-	40	16	33,20	-	-	-
15X1.3	5	-	40	16	33,20	-	-	-
15X1.4	5	-	40	16	34,90	-	-	-
15X1.5	5	-	40	16	36,60	-	-	-
15X1.6	5	-	40	16	38,20	-	-	-
15X1.7	5	-	28	16	39,85	-	-	-
15X1.8	5	-	28	12	41,60	-	-	-
15X1.9	5	-	28	12	41,60	-	-	-
15X2	5	-	28	12	43,30	-	-	-
15X2.5	5	-	28	12	58,20	-	-	-
15X3	5	-	28	12	64,80	-	-	-
15X4	5	-	24	12	91,40	-	-	-
15X5	5	-	24	12	108,00	-	-	-
15X6	5	-	24	12	133,00	-	-	-

Esempio d'ordine | Ordering example | Bestellbeispiel | Exemple de commande | Ejemplo de pedido: **MGS01 - (D x b)**

*Mozzo presente solo nelle seghe in HSS-Co5 | Hub present only in the HSS-Co5 saws | Bund ist nur in den HSS-Co5 Sägeblätter vorhanden
 Epaulement présent seulement sur les fraises sciés en Hss-Co5 | Anillo presente solamente en las sierras en Hss Hss-Co5



SEGHE CIRCOLARI CON DENTATURA FINE E GROSSA

CIRCULAR SAW BLADES WITH FINE AND COARSE TEETH | KREISSÄGEBLÄTTER FEIN UND GROSSVERZAHNT
 FRAISES SCIÉS DENTURE FINE ET LARGE | SIERRAS CIRCULARES DENTADO FINO Y GRUESO

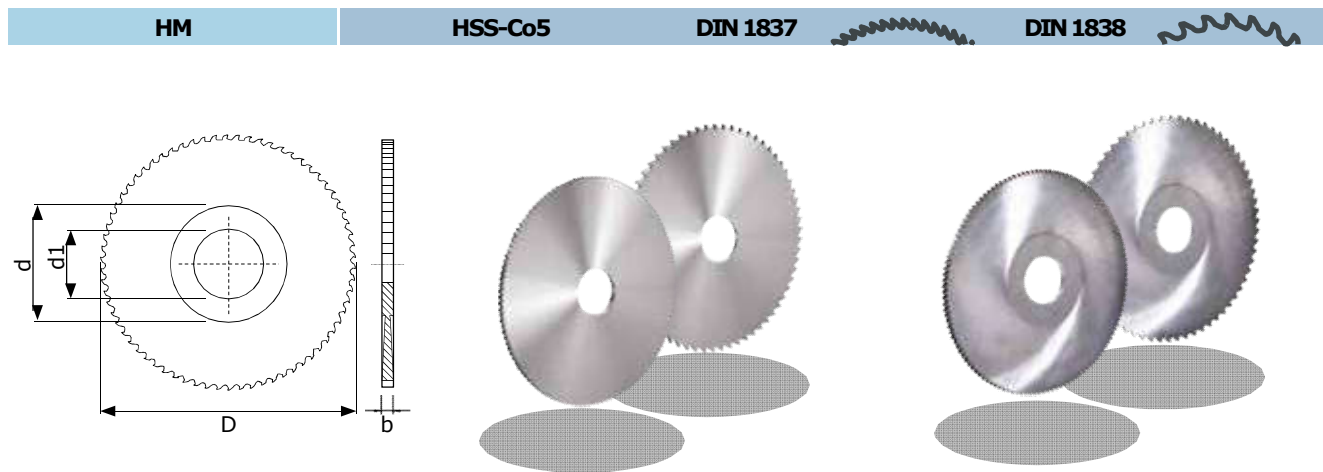

		*MGS03 *MGS04	HM		€	HSS-Co5		€
			MGS01 DIN 1837	MGS02 DIN 1838		MGS03 DIN 1837	MGS04 DIN 1838	
D x b	d_1	d	Z			Z		
20X0.2	5	-	80	32	26,60	-	-	-
20X0.25	5	-	64	32	24,90	-	-	-
20X0.3	5	10	64	32	26,60	64	-	19,55
20X0.35	5	-	64	32	27,40	-	-	-
20X0.4	5	10	64	32	27,40	64	-	19,55
20X0.45	5	-	48	24	28,30	-	-	-
20X0.5	5	10	48	24	29,05	48	-	18,00
20X0.6	5	10	48	24	29,95	48	-	18,70
20X0.7	5	-	48	24	32,40	-	-	-
20X0.8	5	10	40	24	34,00	48	-	17,75
20X0.9	5	-	40	20	37,40	-	-	-
20X1	5	10	40	20	38,20	40	-	18,10
20X1.1	5	-	40	20	39,00	-	-	-
20X1.2	5	10	40	20	39,85	40	-	19,60
20X1.3	5	-	40	20	42,30	-	-	-
20X1.4	5	-	40	20	44,00	-	-	-

Esempio d'ordine | Ordering example | Bestellbeispiel | Exemple de commande | Ejemplo de pedido: **MGS01 - (D x b)**

* Mozzo presente solo nelle seghe in HSS-Co5 | Hub present only in the HSS-Co5 saws | Bund ist nur in den HSS-Co5 Sägeblättern vorhanden | Epaulement présent seulement sur les fraises sciés en Hss-Co5 | Anillo presente solamente en las sierras en Hss Hss-Co5





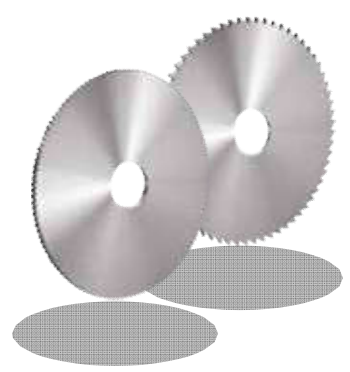
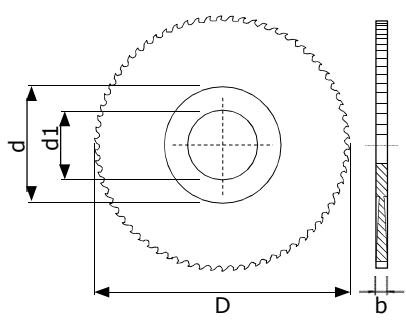

SEGHE CIRCOLARI CON DENTATURA FINE E GROSSA

CIRCULAR SAW BLADES WITH FINE AND COARSE TEETH | KREISSÄGEBLÄTTER FEIN UND GROSSVERZAHNT
 FRAISES SCIÉS DENTURE FINE ET LARGE | SIERRAS CIRCULARES DENTADO FINO Y GRUESO

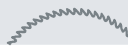
HM	HSS-Co5	DIN 1837		DIN 1838	
----	---------	----------	--	----------	---

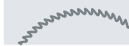

		*MGS03 *MGS04						
			MGS01	MGS02		MGS03	MGS04	
			DIN 1837	DIN 1838		DIN 1837	DIN 1838	
			HM			HSS-Co5		
D x b	d ₁	d	Z		€	Z		€

20X1.5	5	-	40	20	44,00	-	-	-
20X1.6	5	10	40	20	46,50	40	-	20,85
20X1.7	5	-	32	20	48,20	-	-	-
20X1.8	5	-	32	16	48,20	-	-	-
20X1.9	5	-	32	16	49,80	-	-	-
20X2	5	10	32	16	49,80	32	-	22,15
20X2.5	5	10	32	16	62,30	32	-	29,55
20X3	5	10	32	16	69,80	32	-	29,75
20X4	5	10	24	16	93,80	24	-	37,40
20X5	5	10	24	16	116,00	24	-	44,80
20X6	5	10	24	16	136,00	24	-	50,80

25X0.2	8	-	80	32	29,05	-	-	-
25X0.25	8	-	80	32	28,30	-	-	-
25X0.3	8	-	80	32	29,05	80	-	15,55
25X0.35	8	-	64	32	29,95	-	-	-
25X0.4	8	-	64	32	29,95	64	-	15,55
25X0.45	8	-	64	24	32,40	-	-	-

Esempio d'ordine | Ordering example | Bestellbeispiel | Exemple de commande | Ejemplo de pedido: **MGS01 - (D x b)**

* Mozzo presente solo nelle seghe in HSS-Co5 | Hub present only in the HSS-Co5 saws | Bund ist nur in den HSS-Co5 Sägeblätter vorhanden | Epaulement présent seulement sur les fraises sciés en Hss-Co5 | Anillo presente solamente en las sierras in Hss Hss-Co5



SEGHE CIRCOLARI CON DENTATURA FINE E GROSSA

CIRCULAR SAW BLADES WITH FINE AND COARSE TEETH | KREISSÄGEBLÄTTER FEIN UND GROSSVERZAHNT
 FRAISES SCIÉS DENTURE FINE ET LARGE | SIERRAS CIRCULARES DENTADO FINO Y GRUESO

HM	HSS-Co5	DIN 1837	DIN 1838
----	---------	----------	----------

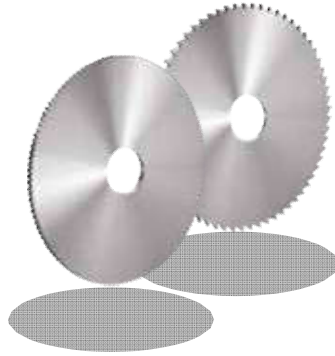
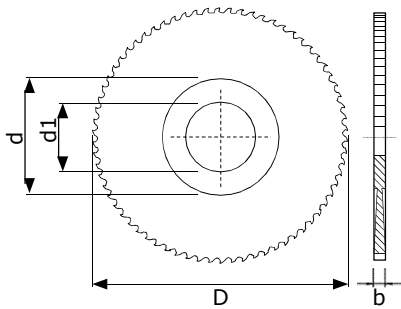

D x b	d ₁	d	HM		HSS-Co5		Z	€
			MGS01 DIN 1837	MGS02 DIN 1838	MGS03 DIN 1837	MGS04 DIN 1838		

25X0.5	8	-	64	24	33,20	64	-	15,55
25X0.6	8	-	64	24	34,90	64	-	15,55
25X0.7	8	-	48	24	38,20	64	-	15,45
25X0.8	8	-	48	24	41,60	48	-	15,90
25X0.9	8	-	48	20	42,30	-	-	-
25X1	8	-	48	20	44,00	48	-	15,90
25X1.1	8	-	48	20	48,20	-	-	-
25X1.2	8	-	48	20	49,80	48	-	16,65
25X1.3	8	-	40	20	52,30	-	-	-
25X1.4	8	-	40	20	54,80	-	-	-
25X1.5	8	-	40	20	56,40	40	-	17,50
25X1.6	8	-	40	20	58,20	40	-	17,50
25X1.7	8	-	40	20	59,10	-	-	-
25X1.8	8	-	40	16	62,30	-	-	-
25X1.9	8	-	40	16	66,40	-	-	-
25X2	8	-	40	16	68,20	40	-	20,25
25X2.5	8	-	40	16	82,10	40	-	22,85
25X3	8	-	32	16	99,60	32	-	27,20
25X3.5	8	-	-	-	-	32	-	32,40
25X4	8	-	32	16	124,50	32	-	35,85
25X5	8	-	32	16	150,00	32	-	39,80
25X6	8	-	32	16	183,50	24	-	43,70

Esempio d'ordine | Ordering example | Bestellbeispiel | Exemple de commande | Ejemplo de pedido: **MGS01 - (D x b)**

* Mozzo presente solo nelle seghe in HSS-Co5 | Hub present only in the HSS-Co5 saws | Bund ist nur in den HSS-Co5 Sägeblätter vorhanden
 Epaulement présent seulement sur les fraises sciés en Hss-Co5 | Anillo presente solamente en las sierras en Hss Hss-Co5



SEGHE CIRCOLARI CON DENTATURA FINE E GROSSA

CIRCULAR SAW BLADES WITH FINE AND COARSE TEETH | KREISSÄGEBLÄTTER FEIN UND GROSSVERZAHNT
FRAISES SCIÉS DENTURE FINE ET LARGE | SIERRAS CIRCULARES DENTADO FINO Y GRUESO

HM	HSS-Co5	DIN 1837	DIN 1838
----	---------	----------	----------

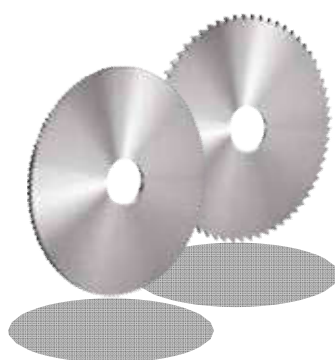
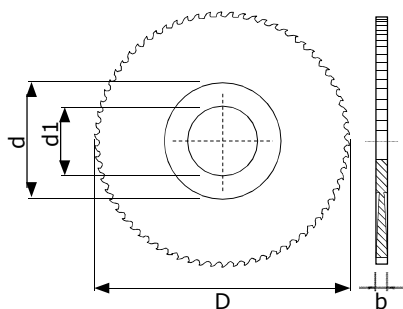

D x b	d ₁	d	HM		HSS-Co5			
			Z	€	Z	€		
30X0.2	8	-	100	32	28,05	-	-	-
30X0.25	8	-	100	32	28,05	-	-	-
30X0.3	8	-	80	32	27,40	80	40	15,60
30X0.35	8	-	80	32	28,70	-	-	-
30X0.4	8	-	80	32	28,70	80	40	15,60
30X0.45	8	-	80	24	28,70	-	-	-
30X0.5	8	-	80	24	28,70	80	40	15,60
30X0.6	8	-	64	24	31,15	64	40	15,60
30X0.7	8	-	64	24	33,60	64	40	15,10
30X0.8	8	-	64	24	37,40	64	40	15,95
30X0.9	8	-	64	20	39,90	-	-	-
30X1	8	-	64	20	39,90	64	40	15,95
30X1.1	8	-	48	20	44,80	-	-	-
30X1.2	8	-	48	20	46,80	48	32	16,65
30X1.3	8	-	48	20	48,60	-	-	-
30X1.4	8	-	48	20	49,90	-	-	-
30X1.5	8	-	48	20	51,10	48	32	17,55
30X1.6	8	-	48	20	54,80	48	32	17,70
30X1.7	8	-	48	20	54,80	-	-	-
30X1.8	8	-	48	20	58,60	-	-	-
30X1.9	8	-	48	20	60,40	-	-	-

Esempio d'ordine | Ordering example | Bestellbeispiel | Exemple de commande | Ejemplo de pedido: **MGS01 - (D x b)**

Ordine minimo 20 pezzi | Minimum order q.ty 20 pièces | Mindestbestellmenge 20 Stück | Minimum de commande 20 pièces
Cantidad minima de pedido 20 uds

* Mozzo presente solo nelle seghe in HSS-Co5 | Hub present only in the HSS-Co5 saws | Bund ist nur in den HSS-Co5 Sägeblätter vorhanden | Epaulement présent seulement sur les fraises sciés en Hss-Co5 | Anillo presente solamente en las sierras in Hss Hss-Co5



SEGHE CIRCOLARI CON DENTATURA FINE E GROSSA

CIRCULAR SAW BLADES WITH FINE AND COARSE TEETH | KREISSÄGEBLÄTTER FEIN UND GROSSVERZAHNT
 FRAISES SCIÉS DENTURE FINE ET LARGE | SIERRAS CIRCULARES DENTADO FINO Y GRUESO

HM	HSS-Co5	DIN 1837	DIN 1838
----	---------	----------	----------

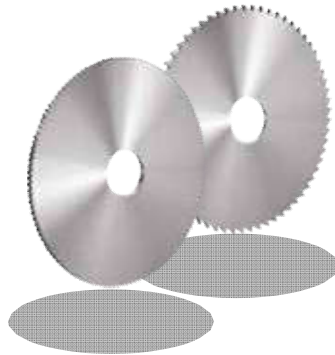
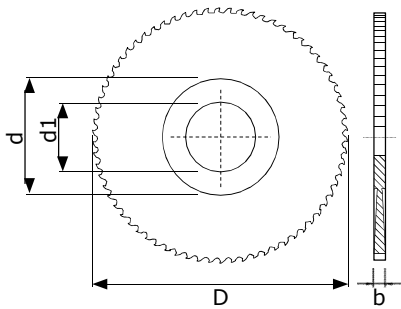

D x b	d ₁	d	HM			HSS-Co5		
			Z	€	Z	€		
30X2	8	-	48	20	62,30	48	32	20,50
30X2.5	8	-	40	20	70,40	40	24	23,05
30X3	8	-	40	18	81,00	40	24	27,45
30X3.5	8	-	-	-	-	40	24	32,65
30X4	8	-	40	18	106,00	40	24	35,40
30X5	8	-	32	18	124,50	32	18	39,30
30X6	8	-	32	18	150,00	32	18	42,10
32X0.2	8	-	100	32	35,50	-	-	-
32X0.25	8	-	100	32	35,50	-	-	-
32X0.3	8	-	80	32	34,90	80	40	15,60
32X0.35	8	-	80	32	36,15	-	-	-
32X0.4	8	-	80	32	36,15	80	40	15,60
32X0.45	8	-	80	24	36,15	-	-	-
32X0.5	8	-	80	24	36,15	80	40	15,60
32X0.6	8	-	64	24	38,60	64	40	15,60
32X0.7	8	-	64	24	41,10	64	40	15,10
32X0.8	8	-	64	24	44,80	64	40	15,95
32X0.9	8	-	64	24	47,30	-	-	-

Esempio d'ordine | Ordering example | Bestellbeispiel | Exemple de commande | Ejemplo de pedido: **MGS01 - (D x b)**

Ordine minimo 10 pezzi | Minimum order q.ty 10 pièces | Mindestbestellmenge 10 Stück | Minimum de commande 10 pièces | Cantidad mínima de pedido 10 uds

Ordine minimo 20 pezzi | Minimum order q.ty 20 pièces | Mindestbestellmenge 20 Stück | Minimum de commande 20 pièces | Cantidad mínima de pedido 20 uds

* Mozzo presente solo nelle seghe in HSS-Co5 | Hub present only in the HSS-Co5 saws | Bund ist nur in den HSS-Co5 Sägeblätter vorhanden | Epaulement présent seulement sur les fraises sciés en Hss-Co5 | Anillo presente solamente en las sierras en Hss Hss-Co5



SEGHE CIRCOLARI CON DENTATURA FINE E GROSSA

CIRCULAR SAW BLADES WITH FINE AND COARSE TEETH | KREISSÄGEBLÄTTER FEIN UND GROSSVERZAHNT
 FRAISES SCIÉS DENTURE FINE ET LARGE | SIERRAS CIRCULARES DENTADO FINO Y GRUESO

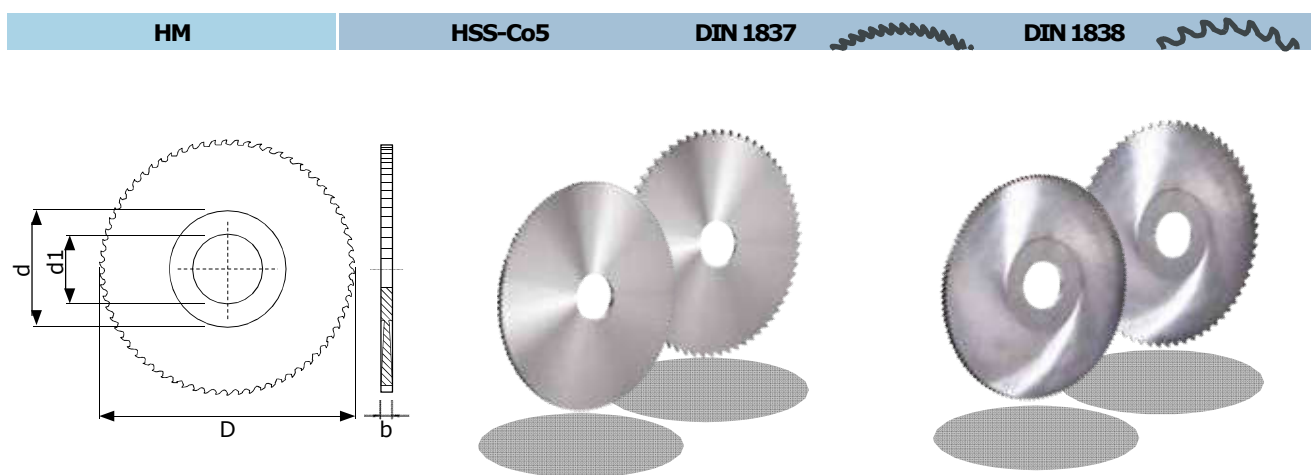

		*MGS03 *MGS04	HM		€	HSS-Co5		€
			MGS01 DIN 1837	MGS02 DIN 1838		MGS03 DIN 1837	MGS04 DIN 1838	
D x b	d ₁	d	Z			Z		

32X1	8	-	64	24	47,30	64	40	15,95
32X1.1	8	-	48	24	52,30	-	-	-
32X1.2	8	-	48	24	54,20	48	32	16,70
32X1.3	8	-	48	20	56,10	-	-	-
32X1.4	8	-	48	20	57,30	-	-	-
32X1.5	8	-	48	20	58,60	48	32	17,70
32X1.6	8	-	48	20	62,30	48	32	17,70
32X1.7	8	-	48	20	62,30	-	-	-
32X1.8	8	-	48	20	66,00	-	-	-
32X1.9	8	-	48	20	68,00	-	-	-
32X2	8	-	48	20	69,80	48	32	20,50
32X2.5	8	-	40	20	77,90	40	24	23,05
32X3	8	-	40	20	88,40	40	24	27,45
32X3.5	8	-	-	-	-	40	24	32,65
32X4	8	-	40	18	113,50	40	24	35,40
32X5	8	-	32	18	132,50	32	18	39,30
32X6	8	-	32	18	157,50	32	18	42,10

Esempio d'ordine | Ordering example | Bestellbeispiel | Exemple de commande | Ejemplo de pedido: **MGS01 - (D x b)**

Ordine minimo 20 pezzi | Minimum order q.ty 20 pièces | Mindestbestellmenge 20 Stück | Minimum de commande 20 pièces
 Cantidad minima de pedido 20 uds

* Mozzo presente solo nelle seghe in HSS-Co5 | Hub present only in the HSS-Co5 saws | Bund ist nur in den HSS-Co5 Sägeblätter vorhanden
 Epaulement présent seulement sur les fraises sciés en Hss-Co5 | Anillo presente solamente en las sierras in Hss Hss-Co5



SEGHE CIRCOLARI CON DENTATURA FINE E GROSSA

CIRCULAR SAW BLADES WITH FINE AND COARSE TEETH | KREISSÄGEBLÄTTER FEIN UND GROSSVERZAHNT
 FRAISES SCIÉS DENTURE FINE ET LARGE | SIERRAS CIRCULARES DENTADO FINO Y GRUESO

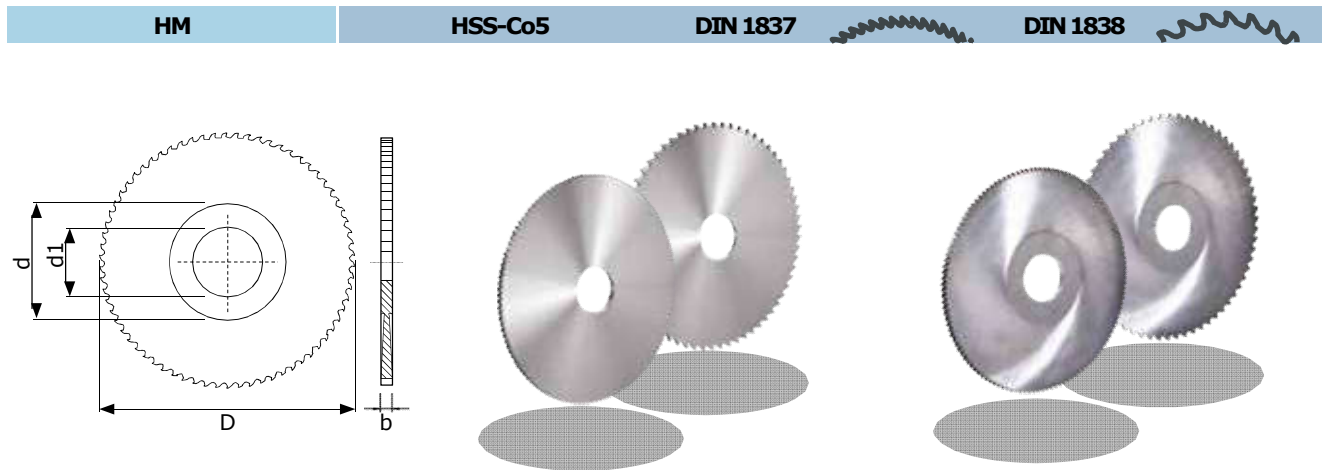

		*MGS03 *MGS04	HM		HSS-Co5			
			MGS01	MGS02	MGS03	MGS04		
			DIN 1837	DIN 1838	DIN 1837	DIN 1838		
D x b	d ₁	d	HM		HSS-Co5			
			Z		€	Z		€
40X0.2	10	-	128	48	39,90	-	-	-
40X0.25	10	-	100	48	37,40	-	-	-
40X0.3	10	18	100	48	36,15	100	44	17,80
40X0.35	10	-	100	48	36,75	-	-	-
40X0.4	10	18	100	48	36,75	100	44	17,80
40X0.45	10	-	80	40	37,40	-	-	-
40X0.5	10	18	80	40	39,90	80	44	17,65
40X0.6	10	18	80	40	41,10	80	44	17,65
40X0.7	10	18	80	40	44,80	80	44	17,65
40X0.8	10	18	80	40	46,80	80	44	16,85
40X0.9	10	-	64	32	47,90	-	-	-
40X1	10	18	64	32	51,10	64	44	16,85
40X1.1	10	-	64	32	51,10	-	-	-
40X1.2	10	18	64	32	51,70	64	36	18,20
40X1.3	10	-	64	32	52,30	-	-	-
40X1.4	10	-	64	32	54,80	-	-	-
40X1.5	10	18	64	32	56,70	64	36	19,10
40X1.6	10	18	64	32	58,60	64	36	19,10

Esempio d'ordine | Ordering example | Bestellbeispiel | Exemple de commande | Ejemplo de pedido: **MGS01 - (D x b)**

Ordine minimo 10 pezzi | Minimum order q.ty 10 pièces | Mindestbestellmenge 10 Stück | Minimum de commande 10 pièces | Cantidad mínima de pedido 10 uds

* Mozzo presente solo nelle seghe in HSS-Co5 | Hub present only in the HSS-Co5 saws | Bund ist nur in den HSS-Co5 Sägeblätter vorhanden | Epaulement présent seulement sur les fraises sciés en Hss-Co5 | Anillo presente solamente en las sierras en Hss Hss-Co5



SEGHE CIRCOLARI CON DENTATURA FINE E GROSSA

CIRCULAR SAW BLADES WITH FINE AND COARSE TEETH | KREISSÄGEBLÄTTER FEIN UND GROSSVERZAHNT
 FRAISES SCIÉS DENTURE FINE ET LARGE | SIERRAS CIRCULARES DENTADO FINO Y GRUESO

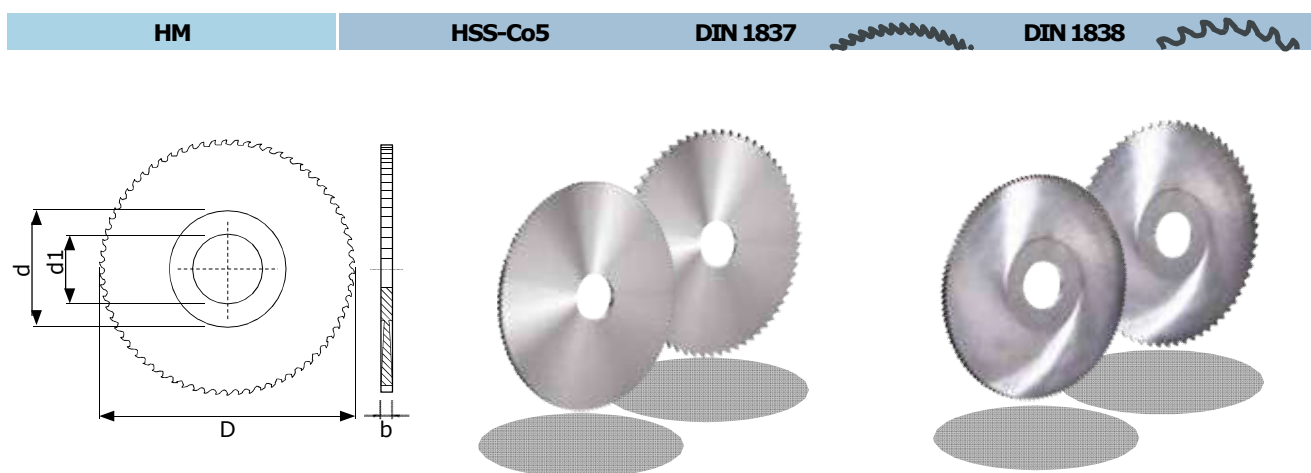

		*MGS03 *MGS04	HM		€	HSS-Co5		€
			MGS01 DIN 1837	MGS02 DIN 1838		MGS03 DIN 1837	MGS04 DIN 1838	
D x b	d ₁	d	Z			Z		
40X1.7	10	-	48	32	61,70	-	-	-
40X1.8	10	-	48	24	63,50	-	-	-
40X1.9	10	-	48	24	63,50	-	-	-
40X2	10	18	48	24	65,40	48	36	21,80
40X2.5	10	18	48	24	84,60	48	28	23,95
40X3	10	18	48	24	95,90	48	28	28,35
40X3.5	10	18	-	-	-	40	28	31,55
40X4	10	18	40	20	118,50	40	28	36,05
40X5	10	18	40	20	142,50	40	20	43,90
40X6	10	18	40	20	168,50	40	20	47,80

Esempio d'ordine | Ordering example | Bestellbeispiel | Exemple de commande | Ejemplo de pedido: **MGS01 - (D x b)**

Ordine minimo 10 pezzi | Minimum order q.ty 10 pièces | Mindestbestellmenge 10 Stück | Minimum de commande 10 pièces | Cantidad mínima de pedido 10 uds

* Mozzo presente solo nelle seghe in HSS-Co5 | Hub present only in the HSS-Co5 saws | Bund ist nur in den HSS-Co5 Sägeblätter vorhanden | Epaulement présent seulement sur les fraises sciés en Hss-Co5 | Anillo presente solamente en las sierras en Hss Hss-Co5



SEGHE CIRCOLARI CON DENTATURA FINE E GROSSA

CIRCULAR SAW BLADES WITH FINE AND COARSE TEETH | KREISSÄGEBLÄTTER FEIN UND GROSSVERZAHNT
 FRAISES SCIES DENTURE FINE ET LARGE | SIERRAS CIRCULARES DENTADO FINO Y GRUESO

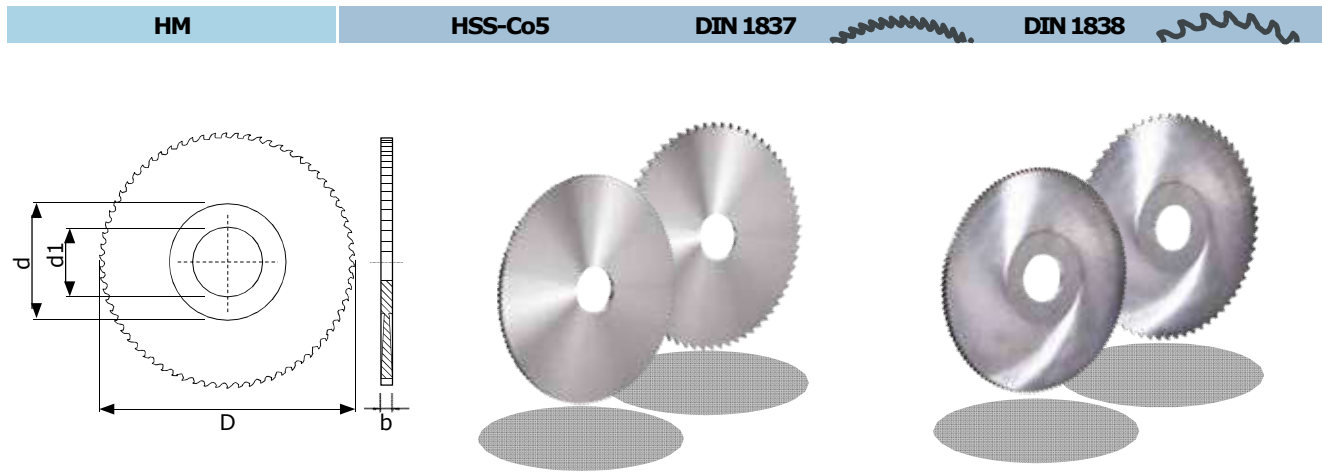

		*MGS03 *MGS04	HM		€	HSS-Co5		€
			MGS01 DIN 1837	MGS02 DIN 1838		MGS03 DIN 1837	MGS04 DIN 1838	
D x b	d ₁	d	Z			Z		
50X0.2	13	-	128	48	56,70	-	-	-
50X0.25	13	-	128	48	54,20	-	-	-
50X0.3	13	25	128	48	48,60	128	48	21,05
50X0.35	13	-	100	48	48,60	-	-	-
50X0.4	13	25	100	48	47,30	100	48	21,05
50X0.45	13	-	100	48	48,60	-	-	-
50X0.5	13	25	100	48	48,60	100	48	21,05
50X0.6	13	25	100	48	48,60	100	48	21,05
50X0.7	13	25	80	40	50,40	80	48	19,10
50X0.8	13	25	80	40	52,90	80	40	19,10
50X0.9	13	-	80	40	55,40	-	-	-
50X1	13	25	80	40	56,70	80	40	19,10
50X1.1	13	-	80	40	58,60	-	-	-
50X1.2	13	25	80	40	59,80	80	40	20,60
50X1.3	13	-	64	32	66,70	-	-	-
50X1.4	13	-	64	32	69,80	-	-	-

Esempio d'ordine | Ordering example | Bestellbeispiel | Exemple de commande | Ejemplo de pedido: **MGS01 - (D x b)**

* Mozzo presente solo nelle seghe in HSS-Co5 | Hub present only in the HSS-Co5 saws | Bund ist nur in den HSS-Co5 Sägeblätter vorhanden
 Epaulement présent seulement sur les fraises scies en Hss-Co5 | Anillo presente solamente en las sierras en Hss Hss-Co5



SEGHE CIRCOLARI CON DENTATURA FINE E GROSSA

CIRCULAR SAW BLADES WITH FINE AND COARSE TEETH | KREISSÄGEBLÄTTER FEIN UND GROSSVERZAHNT
 FRAISES SCIES DENTURE FINE ET LARGE | SIERRAS CIRCULARES DENTADO FINO Y GRUESO

HM	HSS-Co5	DIN 1837	DIN 1838
----	---------	----------	----------

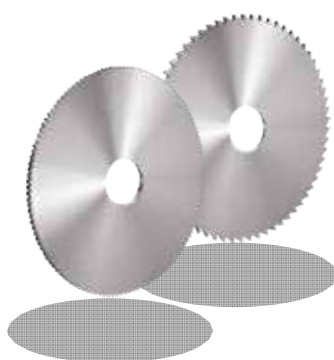
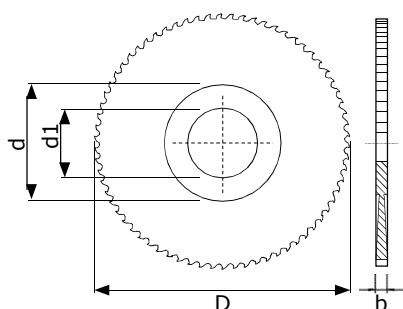

		*MGS03 *MGS04	HM		HSS-Co5		Z	€
			MGS01 DIN 1837	MGS02 DIN 1838	MGS03 DIN 1837	MGS04 DIN 1838		
D x b	d ₁	d	HM		HSS-Co5		Z	€

50X1.5	13	25	64	32	71,70	64	40	21,80
50X1.6	13	25	64	32	73,50	64	32	21,80
50X1.7	13	-	64	32	74,70	-	-	-
50X1.8	13	-	64	32	79,20	-	-	-
50X1.9	13	-	64	32	79,20	-	-	-
50X2	13	25	64	32	82,10	64	32	23,80
50X2.5	13	25	64	32	100,50	64	32	30,55
50X3	13	25	48	24	115,50	48	24	31,85
50X3.5	13	25	-	-	-	48	24	37,35
50X4	13	25	48	24	140,00	48	24	41,20
50X5	13	25	48	24	172,50	48	24	48,90
50X6	13	25	40	20	198,50	40	20	52,80

Esempio d'ordine | Ordering example | Bestellbeispiel | Exemple de commande | Ejemplo de pedido: **MGS01 - (D x b)**

* Mozzo presente solo nelle seghe in HSS-Co5 | Hub present only in the HSS-Co5 saws | Bund ist nur in den HSS-Co5 Sägeblätter vorhanden
 Epaulement présent seulement sur les fraises scies en Hss-Co5 | Anillo presente solamente en las sierras en Hss Hss-Co5



SEGHE CIRCOLARI CON DENTATURA FINE E GROSSA

CIRCULAR SAW BLADES WITH FINE AND COARSE TEETH | KREISSÄGEBLÄTTER FEIN UND GROSSVERZAHNT
 FRAISES SCIES DENTURE FINE ET LARGE | SIERRAS CIRCULARES DENTADO FINO Y GRUESO

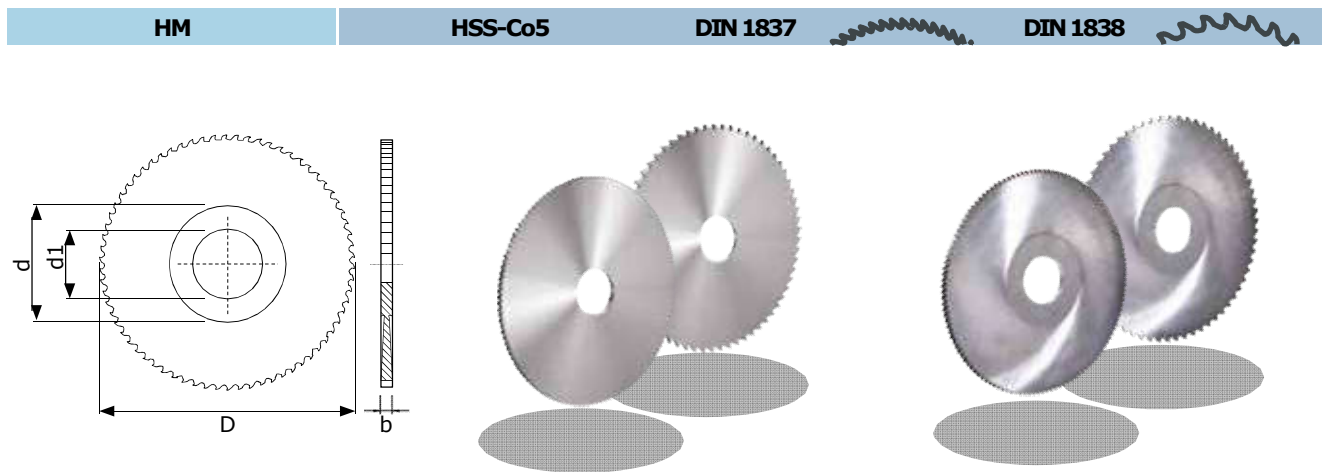

HM	HSS-Co5	DIN 1837	DIN 1837		DIN 1838	DIN 1838		
			MGS01	MGS02		MGS03	MGS04	
D x b	d ₁	d	DIN 1837	DIN 1838	€	DIN 1837	DIN 1838	€
			HM			HSS-Co5		
			Z		€	Z		€
63X0.2	16	-	160	64	74,70	-	-	-
63X0.25	16	-	128	64	74,70	-	-	-
63X0.3	16	32	128	64	74,70	128	-	23,45
63X0.35	16	-	128	64	66,00	-	-	-
63X0.4	16	32	128	64	66,00	128	64	23,45
63X0.45	16	-	128	64	63,50	-	-	-
63X0.5	16	32	128	64	63,50	128	64	23,45
63X0.6	16	32	100	48	67,30	100	48	23,45
63X0.7	16	32	100	48	72,90	100	48	22,55
63X0.8	16	32	100	48	79,20	100	48	22,55
63X0.9	16	-	100	48	81,60	-	-	-
63X1	16	32	100	48	84,10	100	48	22,55
63X1.1	16	-	80	40	86,00	-	-	-
63X1.2	16	32	80	40	89,50	80	40	23,15
63X1.3	16	-	80	40	90,30	-	-	-
63X1.4	16	-	80	40	92,30	-	-	-
63X1.5	16	32	80	40	97,10	80	40	25,65
63X1.6	16	32	80	40	99,60	80	40	25,65
63X1.7	16	-	80	40	104,00	-	-	-
63X1.8	16	-	80	40	104,50	-	-	-
63X1.9	16	-	80	40	111,00	-	-	-
63X2	16	32	80	40	114,50	80	40	28,25
63X2.5	16	32	80	32	135,00	80	32	33,25

Esempio d'ordine | Ordering example | Bestellbeispiel | Exemple de commande | Ejemplo de pedido: **MGS01 - (D x b)**

* Mozzo presente solo nelle seghe in HSS-Co5 | Hub present only in the HSS-Co5 saws | Bund ist nur in den HSS-Co5 Sägeblätter vorhanden | Epaulement présent seulement sur les fraises scies en Hss-Co5 | Anillo presente solamente en las sierras en Hss Hss-Co5



SEGHE CIRCOLARI CON DENTATURA FINE E GROSSA

CIRCULAR SAW BLADES WITH FINE AND COARSE TEETH | KREISSÄGEBLÄTTER FEIN UND GROSSVERZAHNT
 FRAISES SCIÉS DENTURE FINE ET LARGE | SIERRAS CIRCULARES DENTADO FINO Y GRUESO

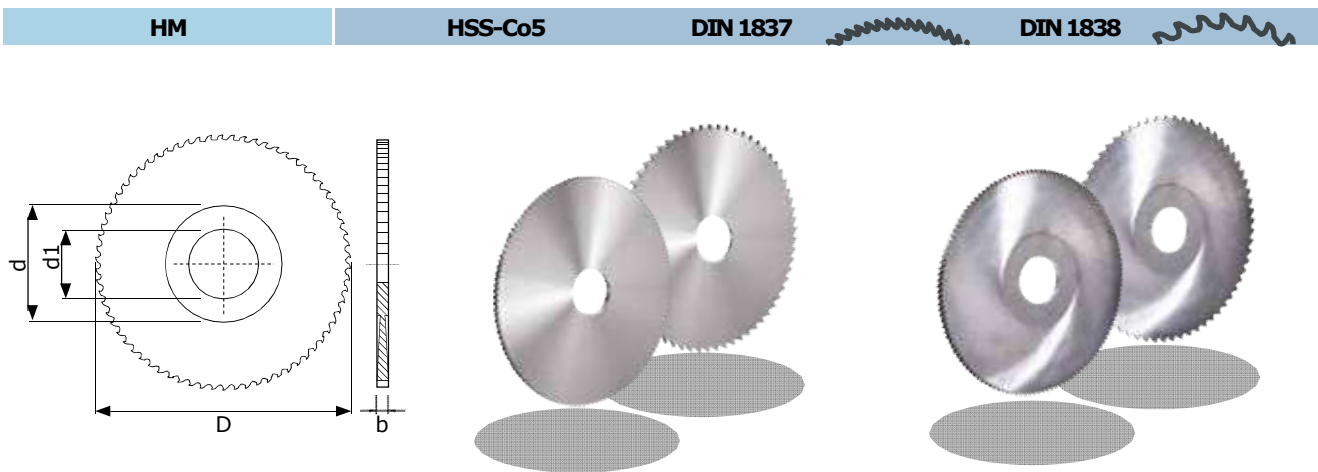

D x b	d ₁	d	HM		€	HSS-Co5		€
			MGS01 DIN 1837	MGS02 DIN 1838		MGS03 DIN 1837	MGS04 DIN 1838	
			Z			Z		
63X3	16	32	64	32	152,50	64	32	35,45
63X3.5	16	32	-	-	-	64	32	39,85
63X4	16	32	64	32	193,50	64	32	44,00
63X5	16	32	48	24	230,50	48	24	52,80
63X6	16	32	48	24	267,00	48	24	57,30
70X0.25	16	-	160	64	104,00	-	-	-
70X0.3	16	-	160	64	104,00	-	-	-
70X0.35	16	-	160	64	95,40	-	-	-
70X0.4	16	-	128	64	95,40	-	-	-
70X0.45	16	-	128	64	92,90	-	-	-
70X0.5	16	-	128	64	92,90	-	-	-
70X0.6	16	-	100	48	96,50	-	-	-
70X0.7	16	-	100	48	102,00	-	-	-
70X0.8	16	-	100	48	108,50	-	-	-
70X0.9	16	-	100	48	111,00	-	-	-
70X1	16	-	100	48	113,50	-	-	-
70X1.1	16	-	80	40	115,00	-	-	-

Esempio d'ordine | Ordering example | Bestellbeispiel | Exemple de commande | Ejemplo de pedido: **MGS01 - (D x b)**

* Mozzo presente solo nelle seghe in HSS-Co5 | Hub present only in the HSS-Co5 saws | Bund ist nur in den HSS-Co5 Sägeblätter vorhanden
 Epaulement présent seulement sur les fraises sciés en Hss-Co5 | Anillo presente solamente en las sierras en Hss Hss-Co5



SEGHE CIRCOLARI CON DENTATURA FINE E GROSSA

CIRCULAR SAW BLADES WITH FINE AND COARSE TEETH | KREISSÄGEBLÄTTER FEIN UND GROSSVERZAHNT
 FRAISES SCIÉS DENTURE FINE ET LARGE | SIERRAS CIRCULARES DENTADO FINO Y GRUESO

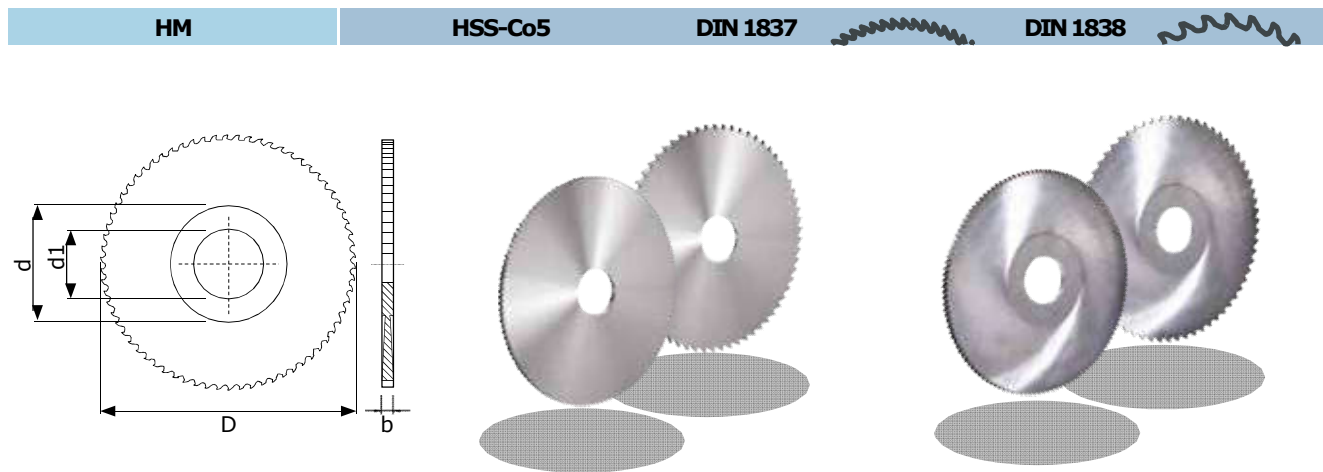

		*MGS03 *MGS04	HM		€	HSS-Co5		€
			MGS01 DIN 1837	MGS02 DIN 1838		MGS03 DIN 1837	MGS04 DIN 1838	
D x b	d ₁	d	Z			Z		

70X1.2	16	-	80	40	118,50	-	-	-
70X1.3	16	-	80	40	119,50	-	-	-
70X1.4	16	-	80	40	121,50	-	-	-
70X1.5	16	-	80	40	126,50	-	-	-
70X1.6	16	-	80	40	129,00	-	-	-
70X1.7	16	-	80	40	133,50	-	-	-
70X1.8	16	-	80	40	134,00	-	-	-
70X1.9	16	-	80	40	140,50	-	-	-
70X2	16	-	80	40	144,00	-	-	-
70X2.5	16	-	64	32	164,00	-	-	-
70X3	16	-	64	32	182,50	-	-	-
70X4	16	-	64	32	222,00	-	-	-
70X5	16	-	64	24	259,00	-	-	-
70X6	16	-	64	24	297,00	-	-	-

Esempio d'ordine | Ordering example | Bestellbeispiel | Exemple de commande | Ejemplo de pedido: **MGS01 - (D x b)**

* Mozzo presente solo nelle seghe in HSS-Co5 | Hub present only in the HSS-Co5 saws | Bund ist nur in den HSS-Co5 Sägeblätter vorhanden | Epaulement présent seulement sur les fraises sciés en Hss-Co5 | Anillo presente solamente en las sierras en Hss Hss-Co5



SEGHE CIRCOLARI CON DENTATURA FINE E GROSSA

CIRCULAR SAW BLADES WITH FINE AND COARSE TEETH | KREISSÄGEBLÄTTER FEIN UND GROSSVERZAHNT
 FRAISES SCIES DENTURE FINE ET LARGE | SIERRAS CIRCULARES DENTADO FINO Y GRUESO

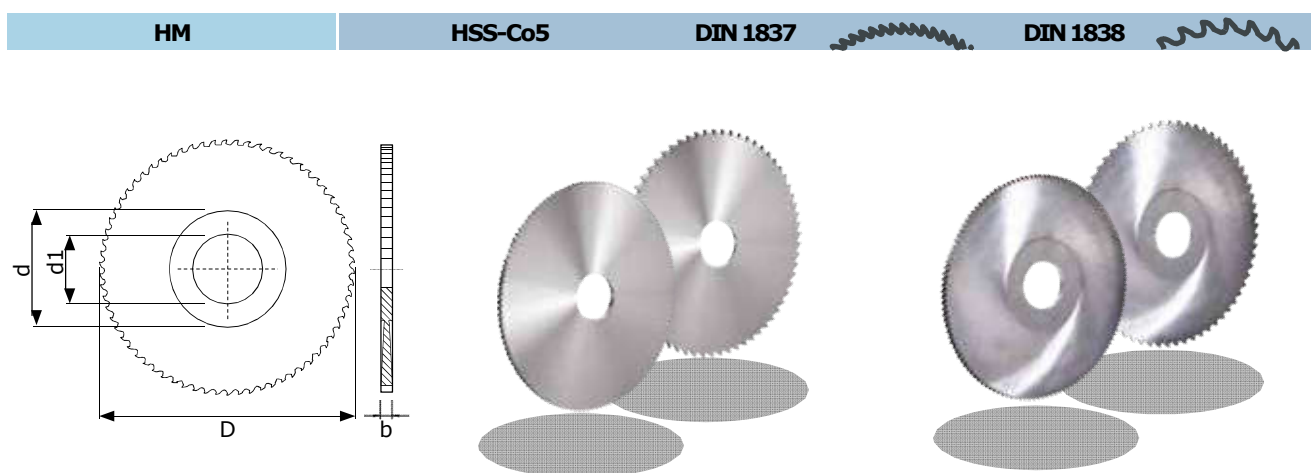

		*MGS03 *MGS04	HM		€	HSS-Co5		€
			MGS01 DIN 1837	MGS02 DIN 1838		MGS03 DIN 1837	MGS04 DIN 1838	
D x b	d ₁	d	Z			Z		
80X0.25	22	-	160	64	146,00	-	-	-
80X0.3	22	36	160	64	146,00	160	80	30,00
80X0.35	22	-	160	64	143,50	-	-	-
80X0.4	22	36	160	64	137,50	160	80	30,00
80X0.45	22	-	128	64	106,00	-	-	-
80X0.5	22	36	128	64	104,00	128	64	29,50
80X0.6	22	36	128	64	99,60	128	64	29,50
80X0.7	22	36	128	64	100,50	128	64	28,25
80X0.8	22	36	128	64	111,00	128	64	28,25
80X0.9	22	-	100	64	115,50	-	-	-
80X1	22	-	100	48	117,00	100	48	28,25
80X1.1	22	-	100	48	119,00	-	-	-
80X1.2	22	36	100	48	122,50	100	48	30,00
80X1.3	22	-	100	48	128,50	-	-	-
80X1.4	22	-	100	48	133,50	-	-	-
80X1.5	22	36	100	48	136,00	100	48	31,30
80X1.6	22	36	100	48	140,00	100	48	31,30
80X1.7	22	-	80	40	151,00	-	-	-
80X1.8	22	-	80	40	153,00	-	-	-
80X1.9	22	-	80	40	156,00	-	-	-
80X2	22	36	80	40	162,50	80	40	35,40

Esempio d'ordine | Ordering example | Bestellbeispiel | Exemple de commande | Ejemplo de pedido: **MGS01 - (D x b)**

*Mozzo presente solo nelle seghe in HSS-Co5 | Hub present only in the HSS-Co5 saws | Bund ist nur in den HSS-Co5 Sägeblätter vorhanden
 Epaulement présent seulement sur les fraises scies en Hss-Co5 | Anillo presente solamente en las sierras en Hss Hss-Co5



SEGHE CIRCOLARI CON DENTATURA FINE E GROSSA

CIRCULAR SAW BLADES WITH FINE AND COARSE TEETH | KREISSÄGEBLÄTTER FEIN UND GROSSVERZAHNT
 FRAISES SCIÉS DENTURE FINE ET LARGE | SIERRAS CIRCULARES DENTADO FINO Y GRUESO

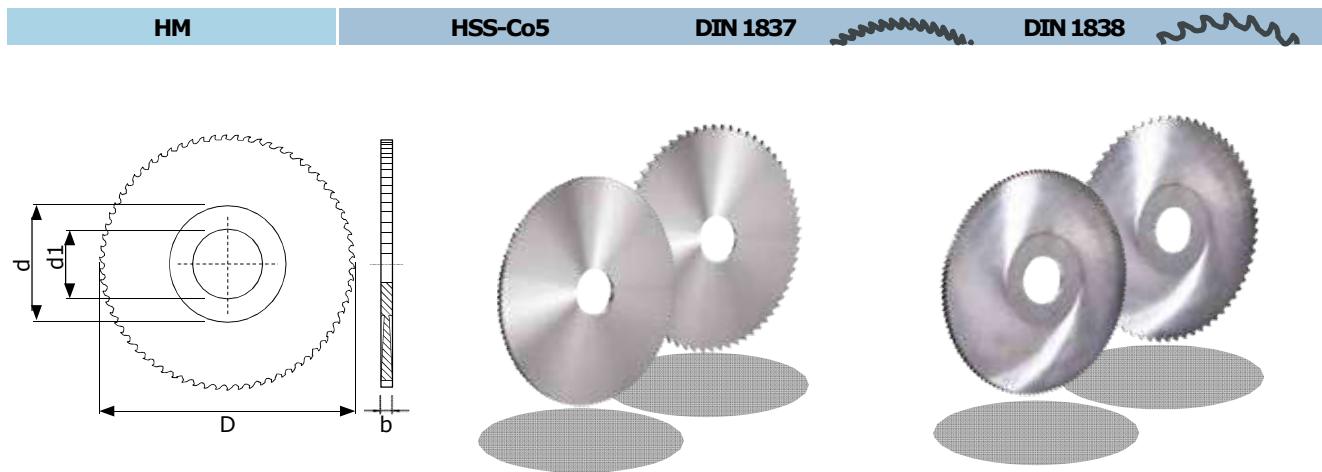

		*MGS03 *MGS04	HM		€	HSS-Co5		€
			MGS01 DIN 1837	MGS02 DIN 1838		MGS03 DIN 1837	MGS04 DIN 1838	
D x b	d ₁	d	Z			Z		

80X2.5	22	36	80	40	190,00	80	40	39,15
80X3	22	36	80	40	225,50	80	40	43,80
80X3.5	22	-	-	-	-	80	40	47,90
80X4	22	36	64	32	270,00	64	32	52,90
80X5	22	36	64	32	328,00	64	32	58,30
80X6	22	36	64	32	373,00	64	32	66,00

100X0.4	22	-	160	80	194,00	-	-	-
100X0.45	22	-	160	80	194,00	-	-	-
100X0.5	22	40	160	80	194,00	160	100	33,30
100X0.6	22	40	160	80	186,50	160	80	33,30
100X0.7	22	40	128	64	177,50	128	64	33,30
100X0.8	22	40	128	64	160,50	128	64	33,30
100X0.9	22	-	128	64	160,50	-	-	-
100X1	22	40	128	64	148,50	128	64	33,30
100X1.1	22	-	128	64	156,00	-	-	-
100X1.2	22	40	128	64	165,50	128	64	35,30
100X1.3	22	-	100	48	174,00	-	-	-

Esempio d'ordine | Ordering example | Bestellbeispiel | Exemple de commande | Ejemplo de pedido: **MGS01 - (D x b)**

* Mozzo presente solo nelle seghe in HSS-Co5 | Hub present only in the HSS-Co5 saws | Bund ist nur in den HSS-Co5 Sägeblätter vorhanden | Epaulement présent seulement sur les fraises sciés en Hss-Co5 | Anillo presente solamente en las sierras en Hss Hss-Co5



SEGHE CIRCOLARI CON DENTATURA FINE E GROSSA

CIRCULAR SAW BLADES WITH FINE AND COARSE TEETH | KREISSÄGEBLÄTTER FEIN UND GROSSVERZAHNT
 FRAISES SCIES DENTURE FINE ET LARGE | SIERRAS CIRCULARES DENTADO FINO Y GRUESO

HM	HSS-Co5	DIN 1837	DIN 1838
----	---------	----------	----------

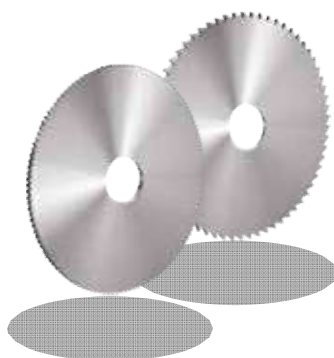
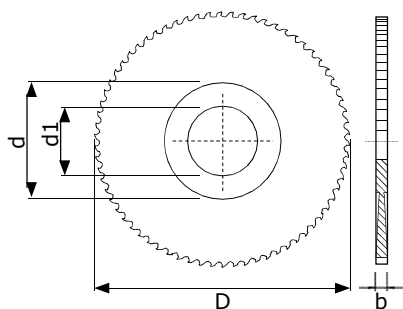

		*MGS03 *MGS04	HM		HSS-Co5			
			MGS01 DIN 1837	MGS02 DIN 1838	MGS03 DIN 1837	MGS04 DIN 1838		
D x b	d ₁	d	Z		€	Z		€

100X1.4	22	-	100	48	180,50	-	-	-
100X1.5	22	40	100	48	186,50	100	64	39,15
100X1.6	22	40	100	48	196,50	100	48	39,15
100X1.7	22	-	100	48	205,50	-	-	-
100X1.8	22	-	100	48	209,50	-	-	-
100X1.9	22	-	100	48	226,50	-	-	-
100X2	22	-	100	48	233,50	100	48	43,60
100X2.5	22	-	100	48	265,00	100	48	47,90
100X3	22	-	100	40	303,00	80	40	54,10
100X3.5	22	40	-	-	-	80	40	59,70
100X4	22	40	80	40	378,00	80	40	65,20
100X5	22	40	80	40	458,00	80	40	73,10
100X6	22	40	64	32	529,00	64	32	81,30

Esempio d'ordine | Ordering example | Bestellbeispiel | Exemple de commande | Ejemplo de pedido: **MGS01 - (D x b)**

* Mozzo presente solo nelle seghe in HSS-Co5 | Hub present only in the HSS-Co5 saws | Bund ist nur in den HSS-Co5 Sägeblätter vorhanden | Epaulement présent seulement sur les fraises scies en Hss-Co5 | Anillo presente solamente en las sierras en Hss Hss-Co5



SEGHE CIRCOLARI CON DENTATURA FINE E GROSSA

CIRCULAR SAW BLADES WITH FINE AND COARSE TEETH | KREISSÄGEBLÄTTER FEIN UND GROSSVERZAHNT
 FRAISES SCIES DENTURE FINE ET LARGE | SIERRAS CIRCULARES DENTADO FINO Y GRUESO

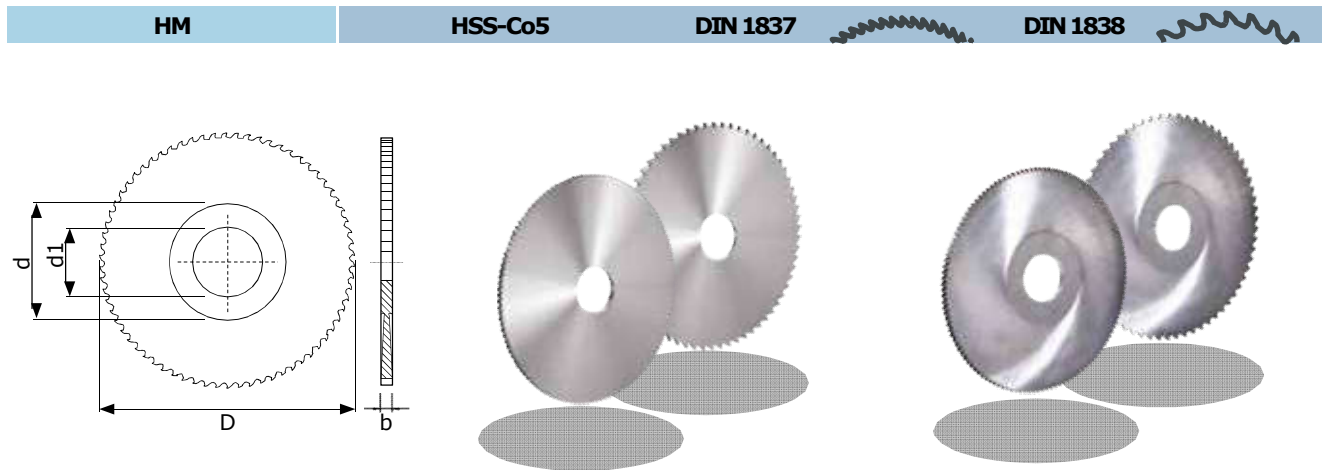

D x b	d ₁	d	HM		€	HSS-Co5		€
			MGS01 DIN 1837	MGS02 DIN 1838		MGS03 DIN 1837	MGS04 DIN 1838	
			Z			Z		
125X0.7	22	40	160	80	306,00	160	100	47,20
125X0.8	22	40	160	80	272,00	160	80	45,90
125X0.9	22	-	160	80	272,00	-	-	-
125X1	22	40	160	80	241,00	160	80	45,90
125X1.1	22	-	128	64	249,00	-	-	-
125X1.2	22	40	128	64	265,00	128	64	47,90
125X1.3	22	-	128	64	290,00	-	-	-
125X1.4	22	-	128	64	290,00	-	-	-
125X1.5	22	40	128	64	303,00	128	64	53,00
125X1.6	22	40	128	64	313,00	128	64	53,00
125X1.7	22	-	128	64	337,00	-	-	-
125X1.8	22	-	128	64	337,00	-	-	-
125X1.9	22	-	128	64	371,00	-	-	-
125X2	22	40	128	64	371,00	128	64	57,00
125X2.5	22	40	100	48	434,00	100	48	62,20
125X3	22	40	100	48	498,00	100	48	70,20
125X3.5	22	40	-	-	-	100	48	77,30
125X4	22	40	100	48	657,00	100	48	84,60
125X.4	22	-	160	-	337,00	-	-	-
125X.45	22	-	160	-	337,00	-	-	-
125X.5	22	-	160	80	337,00	-	-	-
125X.6	22	40	160	80	318,00	160	100	47,20

Esempio d'ordine | Ordering example | Bestellbeispiel | Exemple de commande | Ejemplo de pedido: **MGS01 - (D x b)**

Ordine minimo 10 pezzi | Minimum order q.ty 10 pièces | Mindestbestellmenge 10 Stück | Minimum de commande 10 pièces | Cantidad mínima de pedido 10 uds

* Mozzo presente solo nelle seghe in HSS-Co5 | Hub present only in the HSS-Co5 saws | Bund ist nur in den HSS-Co5 Sägeblätter vorhanden | Epaulement présent seulement sur les fraises scies en Hss-Co5 | Anillo presente solamente en las sierras en Hss Hss-Co5



SEGHE CIRCOLARI CON DENTATURA FINE E GROSSA

CIRCULAR SAW BLADES WITH FINE AND COARSE TEETH | KREISSÄGEBLÄTTER FEIN UND GROSSVERZAHNT
 FRAISES SCIÉS DENTURE FINE ET LARGE | SIERRAS CIRCULARES DENTADO FINO Y GRUESO

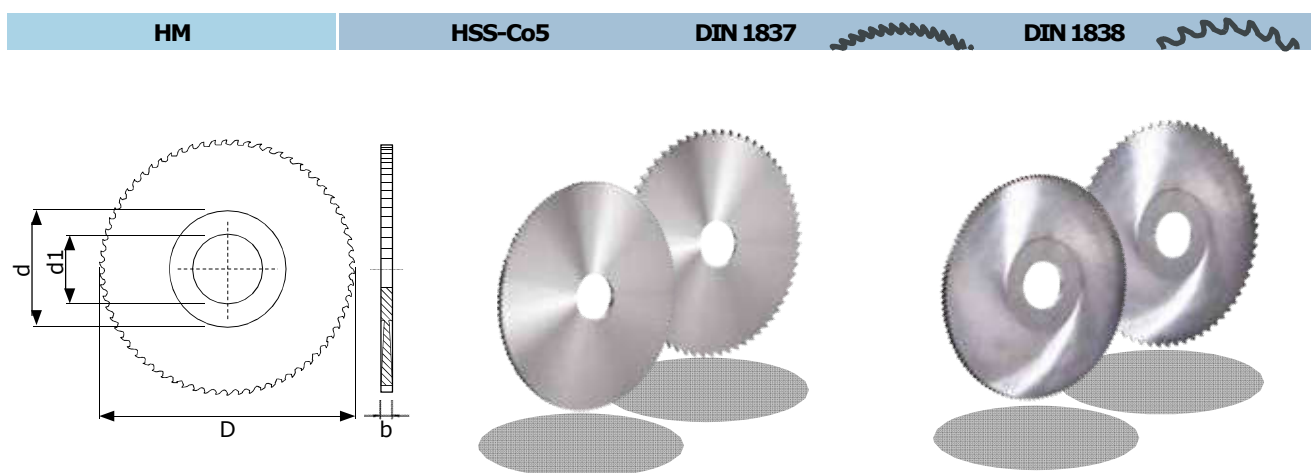

	HM	HSS-Co5	DIN 1837		€	DIN 1838		€
			MGS01	MGS02		MGS03	MGS04	
			DIN 1837	DIN 1838		DIN 1837	DIN 1838	
			HM			HSS-Co5		
D x b	d ₁	d	Z		€	Z		€
125X5	22	40	80	40	753,00	80	40	96,40
125X6	22	40	80	40	921,00	80	40	110,50
150X0.7	32	-	150	80	474,00	-	-	-
150X0.8	32	-	150	80	447,00	-	-	-
150X0.9	32	-	150	80	447,00	-	-	-
150X1	32	63	150	80	406,00	160	100	57,10
150X1.1	32	-	150	80	368,00	-	-	-
150X1.2	32	63	150	80	362,00	160	100	60,30
150X1.3	32	-	150	80	411,00	-	-	-
150X1.4	32	-	150	80	411,00	-	-	-
150X1.5	32	63	150	80	368,00	160	100	61,40
150X1.6	32	63	150	64	368,00	160	80	65,70
150X1.7	32	-	128	64	451,00	-	-	-
150X1.8	32	-	128	64	468,00	-	-	-
150X1.9	32	-	128	64	549,00	-	-	-
150X2	32	63	128	64	549,00	128	80	69,30
150X2.5	32	63	128	64	618,00	128	80	77,70
150X3	32	63	128	64	687,00	128	64	87,20
150X3.5	32	-	-	-	-	128	64	96,80
150X4	32	63	100	64	885,00	100	64	107,50
150X5	32	63	100	48	984,00	80	64	123,50
150X6	32	63	100	48	1.140,00	80	48	139,00

Esempio d'ordine | Ordering example | Bestellbeispiel | Exemple de commande | Ejemplo de pedido: **MGS01 - (D x b)**

Ordine minimo 10 pezzi | Minimum order qty 10 pièces | Mindestbestellmenge 10 Stück | Minimum de commande 10 pièces
 Cantidad mínima de pedido 10 uds

* Mozzo presente solo nelle seghe in HSS-Co5 | Hub present only in the HSS-Co5 saws | Bund ist nur in den HSS-Co5 Sägeblätter vorhanden | Epaulement présent seulement sur les fraises sciés en Hss-Co5 | Anillo presente solamente en las sierras en Hss Hss-Co5



SEGHE CIRCOLARI CON DENTATURA FINE E GROSSA

CIRCULAR SAW BLADES WITH FINE AND COARSE TEETH | KREISSÄGEBLÄTTER FEIN UND GROSSVERZAHNT
 FRAISES SCIÉS DENTURE FINE ET LARGE | SIERRAS CIRCULARES DENTADO FINO Y GRUESO

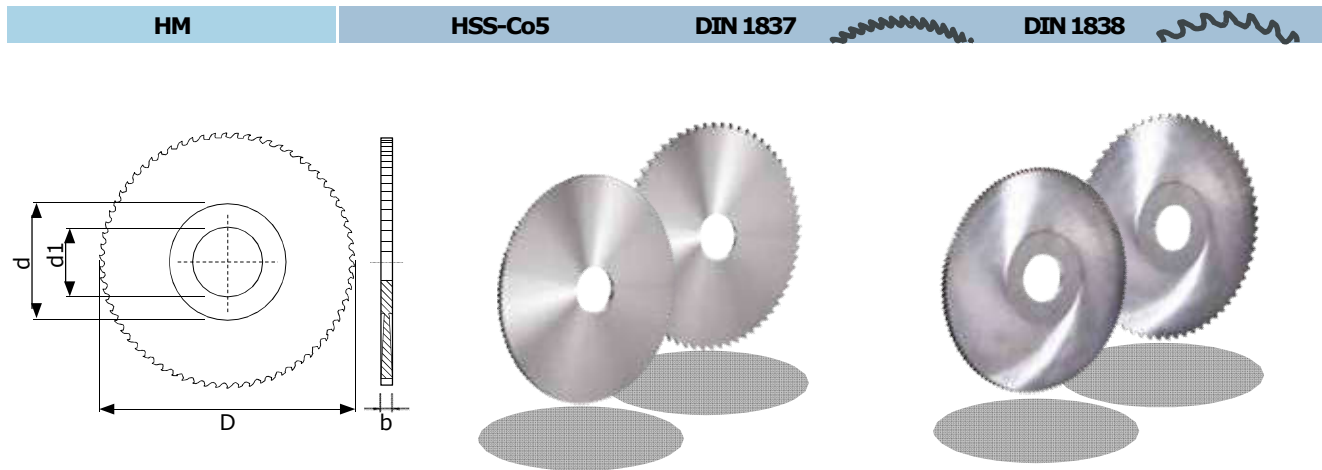

D x b	d ₁	d	HM		HSS-Co5	
			Z	€	Z	€
160X0.8	32	-	160	80	524,00	-
160X0.9	32	-	160	80	486,00	-
160X1	32	63	160	80	474,00	160
160X1.1	32	-	160	80	424,00	-
160X1.2	32	63	160	80	424,00	160
160X1.3	32	-	160	80	468,00	-
160X1.4	32	-	160	80	468,00	-
160X1.5	32	63	160	80	422,00	160
160X1.6	32	63	160	80	424,00	160
160X1.7	32	-	160	80	518,00	-
160X1.8	32	-	128	80	539,00	-
160X1.9	32	-	128	80	634,00	-
160X2	32	-	128	64	634,00	128
160X2.5	32	-	128	64	723,00	128
160X3	32	-	128	64	780,00	128
160X3.5	32	63	-	-	-	128
160X4	32	63	100	64	1.022,00	100
160X5	32	63	100	64	1.277,00	100
160X6	32	63	100	48	1.557,00	100

Esempio d'ordine | Ordering example | Bestellbeispiel | Exemple de commande | Ejemplo de pedido: **MGS01** - (D x b)

Ordine minimo 10 pezzi | Minimum order q.ty 10 pièces | Mindestbestellmenge 10 Stück | Minimum de commande 10 pièces | Cantidad mínima de pedido 10 uds

* Mozzo presente solo nelle seghe in HSS-Co5 | Hub present only in the HSS-Co5 saws | Bund ist nur in den HSS-Co5 Sägeblätter vorhanden | Epaulement présent seulement sur les fraises sciés en Hss-Co5 | Anillo presente solamente en las sierras en Hss Hss-Co5



SEGHE CIRCOLARI CON DENTATURA FINE E GROSSA

CIRCULAR SAW BLADES WITH FINE AND COARSE TEETH | KREISSÄGEBLÄTTER FEIN UND GROSSVERZAHNT
 FRAISES SCIÉS DENTURE FINE ET LARGE | SIERRAS CIRCULARES DENTADO FINO Y GRUESO

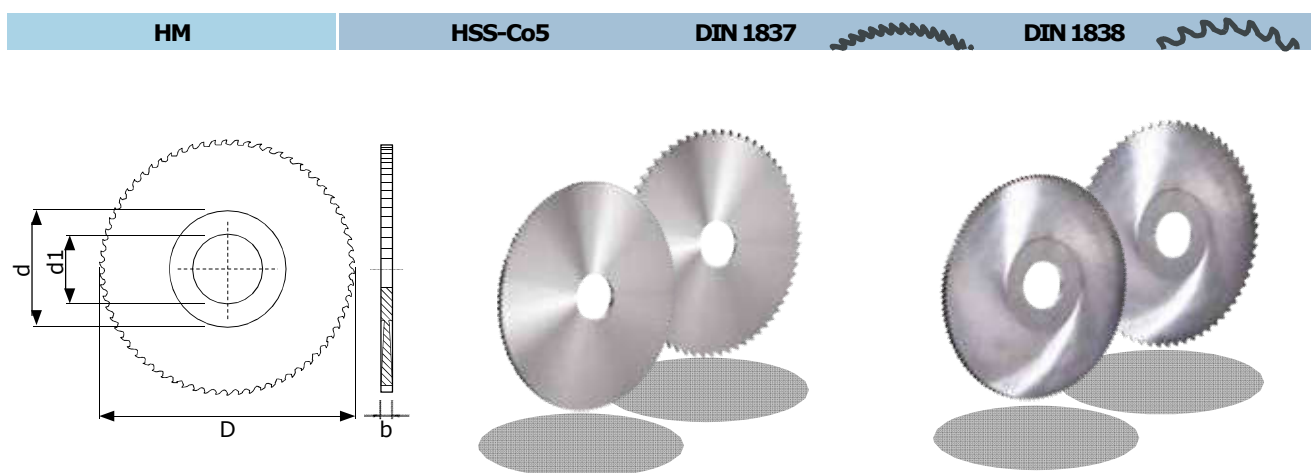

		*MGS03 *MGS04	HM			HSS-Co5		
			MGS01 DIN 1837	MGS02 DIN 1838		MGS03 DIN 1837	MGS04 DIN 1838	
D x b	d ₁	d	Z		€	Z		€
175X1	32	63	-	-	-	160	100	73,90
175X1.2	32	63	-	-	-	160	100	79,50
175X1.5	32	63	-	-	-	160	100	80,00
175X1.6	32	63	-	-	-	160	100	83,40
175X2	32	63	-	-	-	128	80	87,20
175X2.5	32	63	-	-	-	128	80	99,60
175X3	32	63	-	-	-	128	80	114,00
175X3.5	32	63	-	-	-	128	64	127,50
175X4	32	63	-	-	-	128	64	150,50
175X5	32	63	-	-	-	100	64	175,00
175X6	32	63	-	-	-	100	48	197,00

Esempio d'ordine | Ordering example | Bestellbeispiel | Exemple de commande | Ejemplo de pedido: **MGS01 - (D x b)**

Ordine minimo 10 pezzi | Minimum order q.ty 10 pièces | Mindestbestellmenge 10 Stück | Minimum de commande 10 pièces | Cantidad mínima de pedido 10 uds

* Mozzo presente solo nelle seghe in HSS-Co5 | Hub present only in the HSS-Co5 saws | Bund ist nur in den HSS-Co5 Sägeblätter vorhanden | Epaulement présent seulement sur les fraises sciés en Hss-Co5 | Anillo presente solamente en las sierras en Hss Hss-Co5



SEGHE CIRCOLARI CON DENTATURA FINE E GROSSA

CIRCULAR SAW BLADES WITH FINE AND COARSE TEETH | KREISSÄGEBLÄTTER FEIN UND GROSSVERZAHNT
 FRAISES SCIÉS DENTURE FINE ET LARGE | SIERRAS CIRCULARES DENTADO FINO Y GRUESO

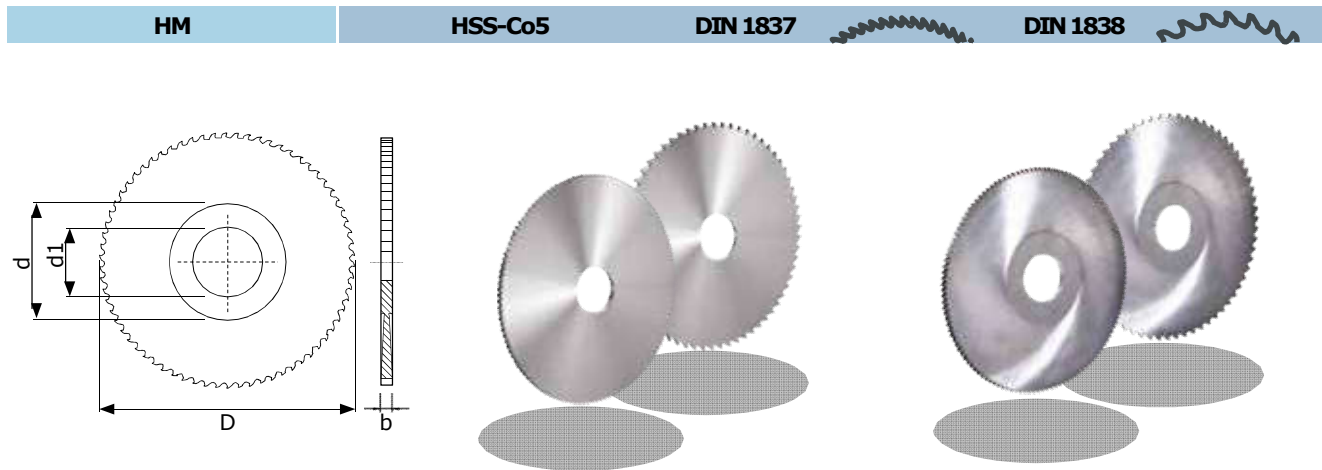

D x b	d ₁	d	HM			HSS-Co5		
			Z	€	Z	€		
200X1	32	63	-	-	-	200	100	87,20
200X1.2	32	-	200	100	903,00	200	100	87,20
200X1.3	32	-	200	80	903,00	-	-	-
200X1.4	32	-	200	80	903,00	-	-	-
200X1.5	32	63	200	80	903,00	200	100	91,30
200X1.6	32	63	160	80	1.097,00	160	80	91,30
200X1.7	32	-	160	80	1.097,00	-	-	-
200X1.8	32	-	160	80	1.097,00	-	-	-
200X1.9	32	-	160	80	1.097,00	-	-	-
200X2	32	63	160	80	1.097,00	160	80	98,80
200X2.5	32	63	160	64	1.265,00	160	80	112,00
200X3	32	63	128	-	1.433,00	128	64	130,00
200X3.5	32	63	-	-	-	128	64	144,50
200X4	32	63	128	64	1.782,00	128	64	171,00
200X5	32	63	128	64	2.054,00	128	64	197,00
200X6	32	63	128	64	2.303,00	100	48	220,50

Esempio d'ordine | Ordering example | Bestellbeispiel | Exemple de commande | Ejemplo de pedido: **MGS01 - (D x b)**

Ordine minimo 10 pezzi | Minimum order q.ty 10 pièces | Mindestbestellmenge 10 Stück | Minimum de commande 10 pièces
 Cantidad mínima de pedido 10 uds

* Mozzo presente solo nelle seghe in HSS-Co5 | Hub present only in the HSS-Co5 saws | Bund ist nur in den HSS-Co5 Sägeblätter
 vorhanden Epaulement présent seulement sur les fraises sciés en Hss-Co5 | Anillo presente solamente en las sierras en Hss Hss-Co5



SEGHE CIRCOLARI CON DENTATURA FINE E GROSSA

CIRCULAR SAW BLADES WITH FINE AND COARSE TEETH | KREISSÄGEBLÄTTER FEIN UND GROSSVERZAHNT
 FRAISES SCIÉS DENTURE FINE ET LARGE | SIERRAS CIRCULARES DENTADO FINO Y GRUESO

HM	HSS-Co5	DIN 1837	DIN 1838
----	---------	----------	----------

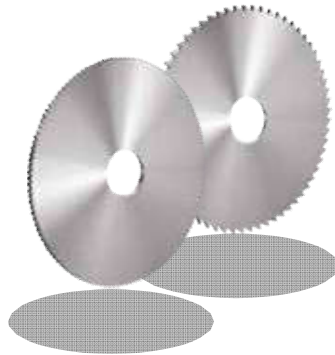
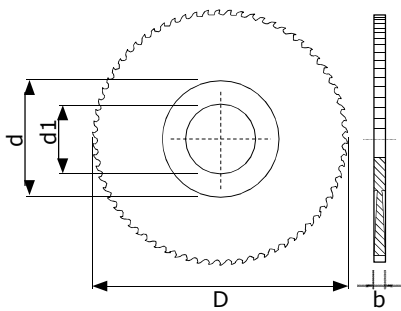

D x b	d ₁	d	HM		€	HSS-Co5		€
			DIN 1837	DIN 1838		DIN 1837	DIN 1838	
			Z			Z		

250X1.5	32	63	-	-	-	200	128	138,50
250X1.6	32	63	-	-	-	200	100	138,50
250X2	32	63	200	100	2.303,00	200	100	135,50
250X2.5	32	63	160	80	1.371,00	160	80	152,00
250X3	32	63	160	80	2.366,00	160	80	172,50
250X3.5	32	63	-	-	-	160	80	191,00
250X4	32	63	160	80	2.738,00	160	80	225,50
250X5	32	63	128	80	3.112,00	128	64	263,00
250X6	32	63	128	80	3.484,00	128	64	316,00

315X2.5	40	80	-	-	-	200	100	244,50
315X3	40	80	-	-	-	200	100	277,00
315X4	40	80	-	-	-	160	80	347,00
315X5	40	80	-	-	-	160	80	413,00
315X6	40	80	-	-	-	160	80	483,00

Esempio d'ordine | Ordering example | Bestellbeispiel | Exemple de commande | Ejemplo de pedido: **MGS01 - (D x b)**

Ordine minimo 10 pezzi | Minimum order q.ty 10 pièces | Mindestbestellmenge 10 Stück | Minimum de commande 10 pièces | Cantidad minima de pedido 10 uds

* Mozzo presente solo nelle seghe in HSS-Co5 | Hub present only in the HSS-Co5 saws | Bund ist nur in den HSS-Co5 Sägeblätter vorhanden | Epaulement présent seulement sur les fraises sciés en Hss-Co5 | Anillo presente solamente en las sierras en Hss Hss-Co5



SEGHE CIRCOLARI PER TRONCATRICI

CIRCULAR SAW BLADES FOR CUT-OFF MACHINES | MASCHINENKREISSÄGEBLÄTTER | FRAISES SCIES
POUR MACHINES A TRONCONNER | SIERRAS CIRCULARES PARA MÁQUINAS TRONZADORAS

HSS-Co5

BLACK*

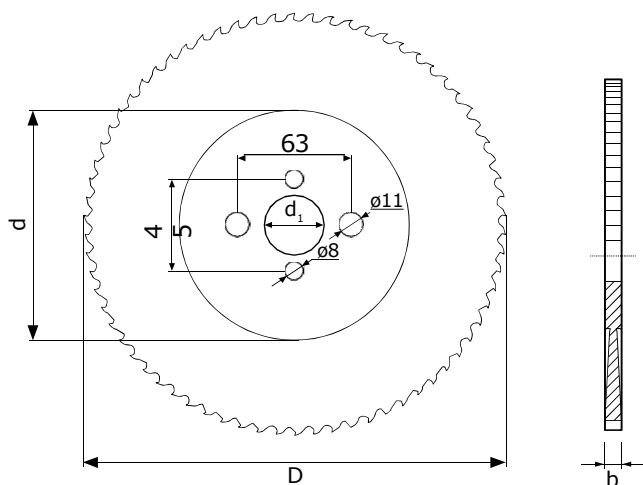

MGS05

HSS-Co5

D x b	d ₁	d	MGS05	
			Z	€
200X1.8	32	90	130	75,90
200X1.8	32	90	200	75,90
225X2	32	90	140	86,60
225X2	32	90	220	86,60
250X2	32	100	128	100,50
250X2	32	100	160	100,50
250X2	32	100	200	100,50
250X2	32	100	260	100,50
275X2	32	100	140	128,00
275X2	32	100	220	128,00
300X2.5	32	100	160	160,00
300X2.5	32	100	180	160,00
300X2.5	32	100	220	160,00
300X2.5	32	100	300	160,00
315X2.5	32	100	160	183,50
315X2.5	32	100	220	183,50
350X2.5**	32	120	180	215,00
350X2.5**	32	120	220	215,00

Esempio d'ordine | Ordering example | Bestellbeispiel | Exemple de commande | Ejemplo de pedido: **MGS05 + (D x b)**

* **(BLACK)** Con trattamento di vaporizzazione | With vaporization treatment | Dampfbehandelt | Avec traitement de vaporisation
Con tratamiento de vaporización

** **(d₁ 40 mm)** A richiesta | Upon request | Auf Anfrage | Sur demande | Bajo pedido



GUIDA TECNICA

TECHNICAL GUIDE | TECHNISCHE DATEN
GUIDE TECHNIQUE | GUÍA TÉCNICA

MEGACUT
2024



GUIDA TECNICA

TECHNICAL GUIDE | TECHNISCHE DATEN
GUIDE TECHNIQUE | GUÍA TÉCNICA

PARAMETRI DI TAGLIO CONSIGLIATI

CUTTING PARAMETERS SUGGESTED | EMPFOHLENE SCHNITTDATEN
PARAMÈTRES DE COUPE RECOMMANDÉS | PARÁMETROS DE CORTE RECOMENDADOS

GRUPPI MATERIALI Material groups Beispiele Material Groupes de matériaux Grupos demateriales	V_c (m/1)		f_z (mm)	
	HM	HSS-Co5	HM	HSS-Co5
P₁ ACCIAIO NON LEGATO Unalloyed Steel <800N/mm ²	100/150	50/70	0,005 - 0,08	
P₂ ACCIAIO BASSO E MEDIOLEGATO Low and Medium Steel 700/1000 N/mm ²	60/120	40/50	0,003 - 0,06	
P₃ ACCIAIO ALTO LEGATO High-Alloyed Steel 1000/1300 N/mm ²	30/50	15/20	0,002 - 0,04	
M₁ ACCIAIO INOSSIDABILE - FERRITICO/MARTENSITICO Stainless Steel - Ferritic/Martensitic	30/45	15/25	0,002 - 0,04	
M₂ ACCIAIO INOSSIDABILE - AUSTENICO Stainless Steel - Austenitic	60/120	15/30	0,003 - 0,06	
K₁ GHISA GRIGIA Gray Cast Iron	50/140	25/35	0,003 - 0,06	
K₂ GHISA SFEROIDALE Nodular Cast Iron	30/60	15/20	0,002 - 0,04	
N₁ ALLUMINIO E LEGHE DI ALLUMINIO Aluminum & Aluminum Alloys	400/800	300/600	0,007 - 0,09	
N₂ OTTONE E LEGHE DI RAME Brass and Copper Alloys	120/500	250/500	0,005 - 0,06	
S₁ TITANIO E LEGHE DI TITANIO Titanium and Titanium Alloys	20/70	15/25	0,003 - 0,05	
S₂ LEGHE RESISTENTI AL CALORE Heat Resistant Super Alloys HRSA	20/40	10/20	0,002 - 0,04	



FORMULE

FORMULAS | FORMEL
FORMULE | FÓRMULAS

$$V_c = \frac{3,14 \times D \times n}{1000}$$

$$n = \frac{V_c \times 1000}{D \times 3,14}$$

$$V_f = f_z \times Z \times n$$

- 1 (D) mm | **Diametro utensile** | Tool diameter | Werkzeugdurchmesser | Diamètre de l'outil | Diámetro de la herramienta
- 2 (V_c) m/1' | **Velocità di taglio** | Cutting speed | Schnittgeschwindigkeit | Vitesse de coupe | Velocidad de corte
- 3 (n) | **Numeri di giri/minuto** | Revolution per minute | Um- Drehungen pro Minute | Tours par minute | Revoluciones por minuto
- 4 (V_f) mm/1' | **Velocità di avanzamento** | Feed Speed | Vorschubgeschwindigkeit | Vitesse d'avance | Factor de avance
- 5 (f_z) mm | **Avanzamento per dente** | Tooth Speed | Zahnvorschub | Avancement au dent | Avance por diente
- 6 (Z) | **Numero di denti** | Number of teeth | Zähnezahl | Nombre de dents | Número de cortes

AVANZAMENTO (f_z) COMPRESO TRA 0,001-0,005 PER DENTE IN RELAZIONE AL RAPPORTO: DIAMETRO FRESA, SPESSORE, PROFONDITÀ RADIALE (a_e), REFRIGERANTE, TIPO DI LAVORAZIONE RIGIDITÀ MACCHINA.

FEED (f_z) BETWEEN 0,001-0,005 PER TOOTH ACCORDING TO THE RELATION WITH: SAW BLADE DIAMETER, THICKNESS, RADIAL DEPTH (a_e), COOLANT, TYPE OF MACHINE WORK, RIGIDITY OF THE MACHINE.

VORSCHUB (f_z) ZWISCHEN 0,001-0,005 PRO ZAHN, IN BEZUG AUF: KREISSÄGEBLATT DURCHMESSER, BREITE, RADIALE TIEFE (a_e), SCHMIERUNG, BEARBEITUNGSART, STEIFHEIT DER MASCHINE.

AVANCEMENT (f_z) ENTRE 0,001-0,005 AU DENT, EN RELATION DE: DIAMÈTRE DE LA FRAISE, ÉPAISSEUR, PROFONDITÉ RADIALE (a_e), LUBRIFICATION, TYPE DE USINAGE, RIGIDITÉ DE LA MACHINE.

AVANCE (f_z) ENTRE 0,001-0,005 POR LABIOS, EN RELACIÓN CON: DIÁMETRO DE LA SIERRA, ESPESOR, PROFUNDIDAD RADIAL (a_e), LUBRIFICACIÓN, TIPO DE APLICACIÓN, RIGIDEZ DE LA MÁQUINA.



GUIDA TECNICA

TECHNICAL GUIDE | TECHNISCHE DATEN
GUIDE TECHNIQUE | GUÍA TÉCNICA

CALCOLO DELLO SPESSORE MEDIO DEL TRUCIOLO (h_m)

CALCULATION AVERAGE CHIP THICKNESS (h_m) | BERECHNUNG DER DURCHSCHNITTLICHEN SPANDICKE (h_m)
CALCUL POUR L'ÉPAISSEUR MOYENNE DU COPEAU (h_m) | CALCULO DEL ESPESOR MEDIO DE LA VIRUTA (h_m)

$$h_m = f_z \times \sqrt{\frac{a_e}{D}}$$

$$f_z = h_m \times \sqrt{\frac{D}{a_e}}$$

- 1 **(D) mm | Diametro utensile** | Tool diameter
Werkzeugdurchmesser | Diamètre de l'outil
Diámetro de la herramienta
- 2 **(a_e) | Impegno radiale utensile** |
Radial depth
Radiale Tiefe | Profondeur radiale
Profundidad radial
- 3 **(f_z) mm | Avanzamento per dente** | Tooth
Speed Zahnvorschub | Avancement au dent
Avance por diente
- 4 **(h_m) | Spessore medio del truciolo** |
Average chip thickness | Durchschnittliche
Spandicke | Epaisseur moyenne du
copeau | Espesor medio de la viruta

GRUPPO MATERIALI
Material groups
Beispiele Material
Groupes de matériaux
Grupos de materiales

h_m

P₁	0,015 ÷ 0,030
P₂	0,015 ÷ 0,025
P₃	0,010 ÷ 0,025
M₁	0,010 ÷ 0,025
M₂	0,008 ÷ 0,020
K₁	0,020 ÷ 0,030
K₂	0,015 ÷ 0,030
N₁	0,020 ÷ 0,045
N₂	0,015 ÷ 0,035
S₁	0,010 ÷ 0,025
S₂	0,008 ÷ 0,020

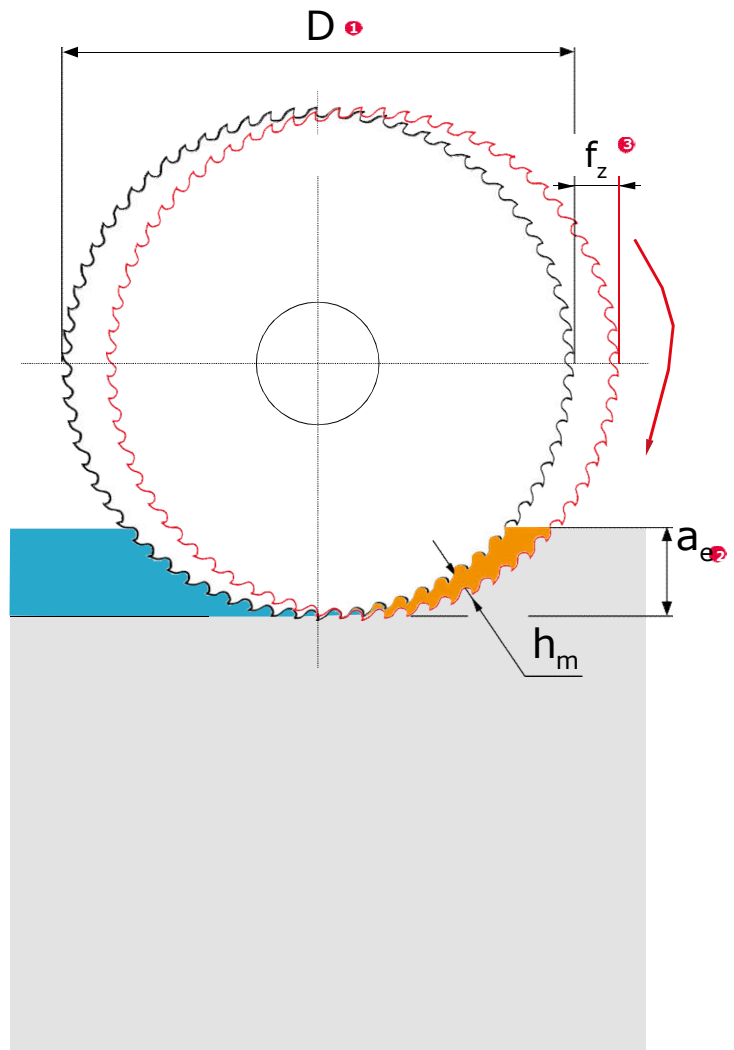

TOLLERANZE COSTRUTTIVE SEGHE CIRCOLARI

TOLERANCES CIRCULAR SAW BLADES | BAUTOLERANZEN KREISSÄGEBLÄTTER
 TOLERANCIAS DE CONSTRUCCIONES FRAISES SCIÉS | TOLERANCIAS DE CONSTRUCCIÓN SIERRA CIRCULARES

UNI DIN 1837 A - DIN 1838 B

D	Tolleranze (D) Tolerances (D) Toleranzen (D) Tolérances (D) Tolerancias (D)		Tolleranze (b) Tolerances (b) Toleranzen (b) Tolérances (b) Tolerancias (b)	
	HM	HSS-Co5	HM	HSS-Co5
10÷18 mm	±0.35 mm	±0.35 mm	- 0,005 mm + 0,015 mm	±0.02 mm
18÷30 mm	±0.42 mm	±0.42 mm	- 0,005 mm + 0,015 mm	±0.02 mm
30÷50 mm	±0.50 mm	±0.50 mm	- 0,005 mm + 0,015 mm	±0.02 mm
50÷80 mm	±0.60 mm	±0.60 mm	- 0,005 mm + 0,015 mm	±0.02 mm
80÷120 mm	±0.70 mm	±0.70 mm	- 0,005 mm + 0,015 mm	±0.02 mm
120÷180 mm	±0.80 mm	±0.80 mm	- 0,005 mm + 0,015 mm	±0.02 mm
180÷250 mm	±0.92 mm	±0.92 mm	- 0,005 mm + 0,015 mm	±0.02 mm
250÷400 mm	±1.00 mm	±1.00 mm	- 0,005 mm + 0,015 mm	±0.02 mm

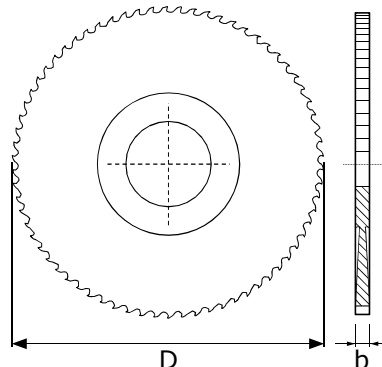

RIVESTIMENTI E AFFILATURE SPECIALI A RICHIESTA

SPECIAL COATINGS AND SHARPENINGS ON REQUEST | BESCHICHTUNGEN UND SONDERSCHLEIFEN AUF ANFRAGE
REVÊTÈMENTS ET AFFÛTAGES SPÉCIAUX SUR DEMANDE | RECUBRIMIENTOS Y AFILADOS ESPECIALES BAJO DEMANDA

■ Rivestimento |Coating |Beschichtung |Revêtement |Recubrimiento

TiN

TiCN

TiAlN

■ Affilature speciali | Special sharpening | Sonderschleifen | Affûtages spéciaux | Afilado especial

VP ▶

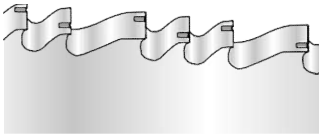

- **Passo variabile utilizzato per il taglio di sezioni molto irregolari che causano forti vibrazioni e rumorosità di taglio.**
- Variable pitch used to cut very irregular sections which cause severe vibrations and noises.
- Variozahn ist geeignet zum Schneiden sehr unregelmäßiger Abschnitte, die starke Vibrationen und Lärm verursachen.
- Pas variable utilisé pour la coupe de sections très irrégulières qui causent fortes vibrations et bruit.
- Paso variable utilizado para secciones de corte muy irregulares que causan grandes vibraciones y ruidos de corte.

AW ▶

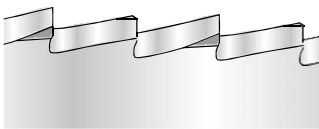

- **Aggiunge al dente standard lo smusso che consente una migliore frantumazione del truciolo.**
- Add to the standard tooth the bevel that allow to optimize the chip shredding.
- Wie Standard Zahn jedoch mit zusätzlicher Fase , was eine bessere Spanteilung garantiert.
- Ajoute au dent standard le chanfrein qui permet une meilleure ecrasement du copeau.
- Añade al diente estándar el chaflán que permite una mejor fragmentación de las virutas.

HZ ▶

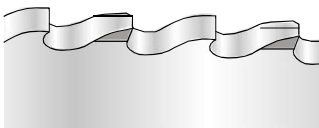

- **Utilizzato per il taglio di solidi o tubi di spessore grosso (>3mm).**
- Used in the solid cutting or to cut thick (>3mm) pipes.
- Geeignet zum Schneiden von Vollmaterialien und Röhren mit dicker Wandstärke(>3mm).
- Utilisé pour la coupe de solides or tuyaux de grande epaisseur (>3mm).
- Utilizado para el corte de sólidos o de tubos con gran grosor (>3mm).

BR ▶

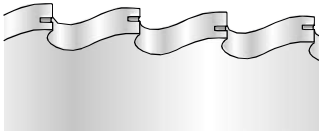

- **Miglior forma dente per il taglio di tubi su macchine automatiche.**
- Best tooth shape to cut pipe on automatic machines.
- Beste Zahnform zum Schneiden von Röhren auf automatische Maschinen.
- Meillure forme du dent pour la coupe de tuyaux sur machines automathiques.
- Mejor forma del diente para el corte de tubos con máquinas automáticas

BW ▶

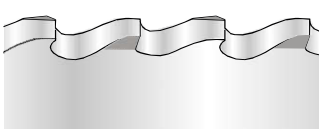

- **Forma standard per il taglio di tubi.**
- Standard tooth shape for the pipe cutting.
- Standard-Zahnform zum Schneiden von Röhren.
- Forme standard pour la coupe de tuyaux.
- Forma estandard para el corte de tubos.



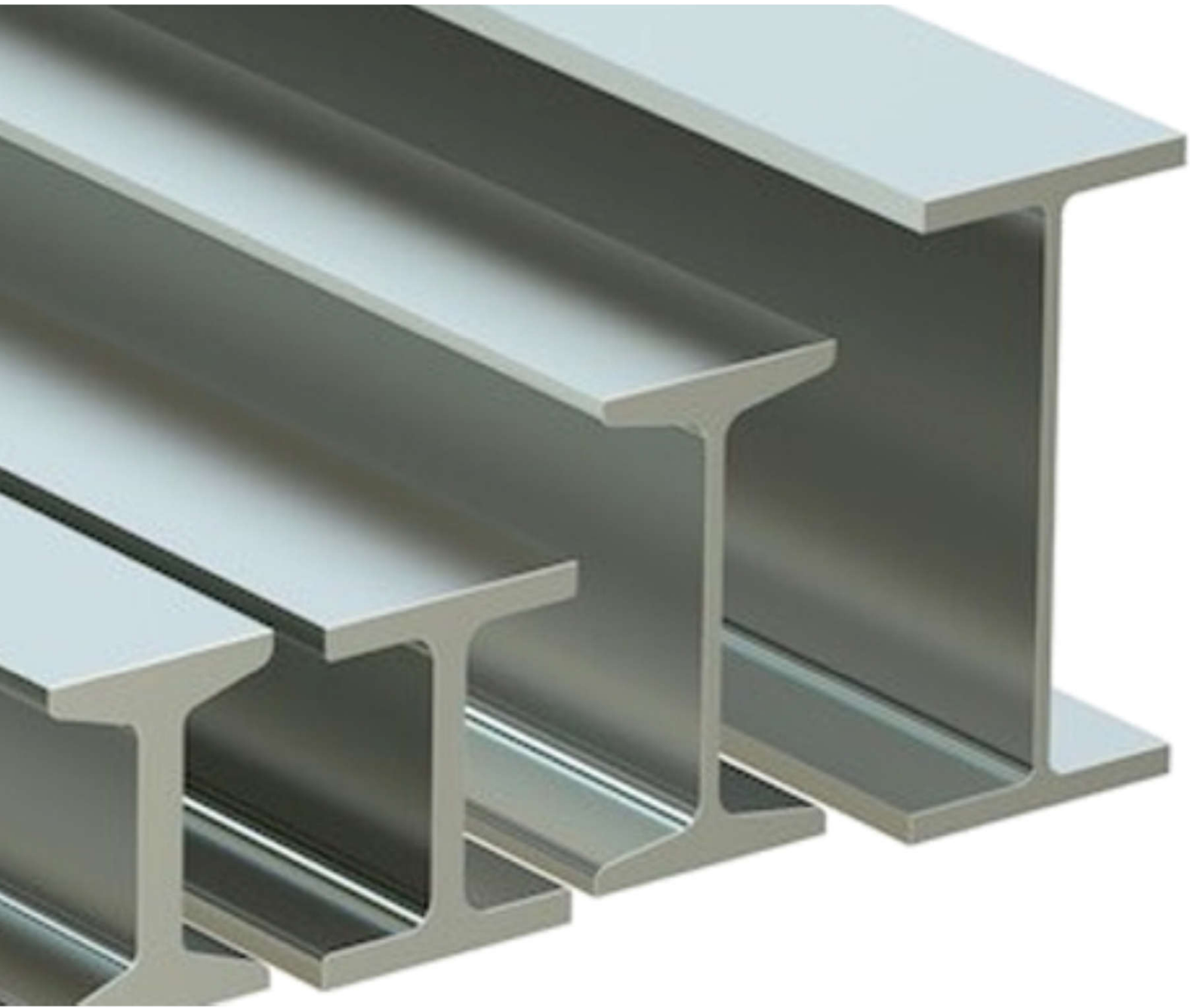

CARBIDE TIPPED ANNULAE CUTTER WITH UNIVERSAL SHANK

* Carbide annular cutter with universal shank

MGX35N Type

Model	MGX35N	MGX50N	MGX75N	MGX100N
Diameter/D (mm)	Ø12-100	Ø12-65	Ø14-65	Ø14-65
Cutting Depl't L (mm)	35	50	75	100

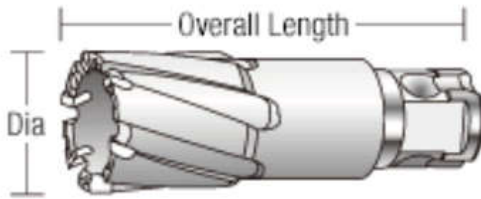

Model	Dia	L	Model	Dia	L	Model	Dia	L
MGX35N	12	35	MGX35N	27	35	MGX35N	42	35
MGX35N	13	35	MGX35N	28	35	MGX35N	43	35
MGX35N	14	35	MGX35N	29	35	MGX35N	44	35
MGX35N	15	35	MGX35N	30	35	MGX35N	45	35
MGX35N	16	35	MGX35N	31	35	MGX35N	46	35
MGX35N	17	35	MGX35N	32	35	MGX35N	47	35
MGX35N	18	35	MGX35N	33	35	MGX35N	48	35
MGX35N	19	35	MGX35N	34	35	MGX35N	49	35
MGX35N	20	35	MGX35N	35	35	MGX35N	50	35
MGX35N	21	35	MGX35N	36	35	MGX35N	51	35
MGX35N	22	35	MGX35N	37	35	MGX35N	52	35
MGX35N	23	35	MGX35N	38	35	MGX35N	53	35
MGX35N	24	35	MGX35N	39	35	MGX35N	54	35
MGX35N	25	35	MGX35N	40	35	MGX35N	55	35
MGX35N	26	35	MGX35N	41	35	MGX35N	56	35

Center Pin For MGX



Model	Dia(mm)	Overall Length(mm)	Hole Saw Size(mm)
PIN35-6	6.35	90	MGX35N 12.0~17.0
PIN35-8	7.98	90	MGX35N 18.0~65.0
PIN50-6	6.35	102	MGX50N 12.0~17.0
PIN50-8	7.98	102	MGX50N 18.0~65.0
PIN75-6	6.35	130	MGX75N 12.0~17.0
PIN75-8	7.98	130	MGX75N 18.0~65.0
PIN100-6	6.35	160	MGX100N 12.0~17.0
PIN100-8	7.98	160	MGX100N 18.0~65.0

Ordering example | : **Model - (D x L)**
| **Minimum order q.ty 10 pieces**



CARBIDE TIPPED ANNULAE CUTTER WITH UNIVERSAL SHANK

* Carbide annular cutter with universal shank

MGX35N Type

Model	MGX35N	MGX50N	MGX75N	MGX100N
Diameter/D (mm)	Ø12-100	Ø12-65	Ø14-65	Ø14-65
Cutting Depl't L (mm)	35	50	75	100

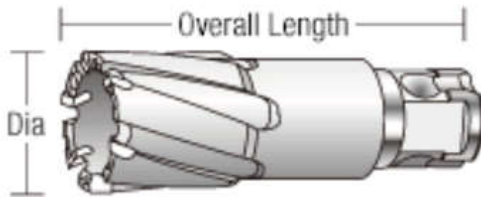

Model	Dia	L	Model	Dia	L	Model	Dia	L
MGX35N	57	35	MGX35N	73	35	MGX35N	88	35
MGX35N	58	35	MGX35N	74	35	MGX35N	89	35
MGX35N	59	35	MGX35N	75	35	MGX35N	90	35
MGX35N	60	35	MGX35N	76	35	MGX35N	91	35
MGX35N	61	35	MGX35N	77	35	MGX35N	92	35
MGX35N	62	35	MGX35N	78	35	MGX35N	93	35
MGX35N	63	35	MGX35N	79	35	MGX35N	94	35
MGX35N	64	35	MGX35N	80	35	MGX35N	95	35
MGX35N	65	35	MGX35N	81	35	MGX35N	96	35
MGX35N	66	35	MGX35N	82	35	MGX35N	97	35
MGX35N	67	35	MGX35N	83	35	MGX35N	98	35
MGX35N	68	35	MGX35N	84	35	MGX35N	99	35
MGX35N	69	35	MGX35N	85	35	MGX35N	100	35
MGX35N	70	35	MGX35N	86	35	MGX35N		
MGX35N	71	35	MGX35N	87	35	MGX35N		

Center Pin For MGX



Model	Dia(mm)	Overall Length(mm)	Hole Saw Size(mm)
PIN35-6	6.35	90	MGX35N 12.0~17.0
PIN35-8	7.98	90	MGX35N 18.0~65.0
PIN50-6	6.35	102	MGX50N 12.0~17.0
PIN50-8	7.98	102	MGX50N 18.0~65.0
PIN75-6	6.35	130	MGX75N 12.0~17.0
PIN75-8	7.98	130	MGX75N 18.0~65.0
PIN100-6	6.35	160	MGX100N 12.0~17.0
PIN100-8	7.98	160	MGX100N 18.0~65.0

Ordering example | : **Model - (D x L)**
| **Minimum order q.ty 10 pieces**



CARBIDE TIPPED ANNULAE CUTTER WITH UNIVERSAL SHANK

* Carbide annular cutter with universal shank

MGX50N Type

Model	MGX35N	MGX50N	MGX75N	MGX100N
Diameter/D (mm)	Ø12-100	Ø12-65	Ø14-65	Ø14-65
Cutting Depl't L (mm)	35	50	75	100

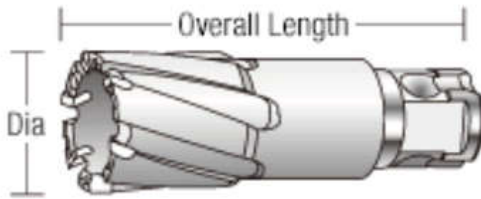

Model	Dia	L	Model	Dia	L	Model	Dia	L
MGX50N	12	50	MGX50N	27	50	MGX50N	42	50
MGX50N	13	50	MGX50N	28	50	MGX50N	43	50
MGX50N	14	50	MGX50N	29	50	MGX50N	44	50
MGX50N	15	50	MGX50N	30	50	MGX50N	45	50
MGX50N	16	50	MGX50N	31	50	MGX50N	46	50
MGX50N	17	50	MGX50N	32	50	MGX50N	47	50
MGX50N	18	50	MGX50N	33	50	MGX50N	48	50
MGX50N	19	50	MGX50N	34	50	MGX50N	49	50
MGX50N	20	50	MGX50N	35	50	MGX50N	50	50
MGX50N	21	50	MGX50N	36	50	MGX50N	51	50
MGX50N	22	50	MGX50N	37	50	MGX50N	52	50
MGX50N	23	50	MGX50N	38	50	MGX50N	53	50
MGX50N	24	50	MGX50N	39	50	MGX50N	54	50
MGX50N	25	50	MGX50N	40	50	MGX50N	55	50
MGX50N	26	50	MGX50N	41	50	MGX50N	56	50

Center Pin For MGX



Model	Dia(mm)	Overall Length(mm)	Hole Saw Size(mm)
PIN35-6	6.35	90	MGX35N 12.0~17.0
PIN35-8	7.98	90	MGX35N 18.0~65.0
PIN50-6	6.35	102	MGX50N 12.0~17.0
PIN50-8	7.98	102	MGX50N 18.0~65.0
PIN75-6	6.35	130	MGX75N 12.0~17.0
PIN75-8	7.98	130	MGX75N 18.0~65.0
PIN100-6	6.35	160	MGX100N 12.0~17.0
PIN100-8	7.98	160	MGX100N 18.0~65.0

Ordering example | : **Model - (D x L)**
| **Minimum order qty 10 pieces**



CARBIDE TIPPED ANNULAE CUTTER WITH UNIVERSAL SHANK

* Carbide annular cutter with universal shank

MGX50N Type

Model	MGX35N	MGX50N	MGX75N	MGX100N
Diameter/D (mm)	Ø12-100	Ø12-65	Ø14-65	Ø14-65
Cutting Depl't L (mm)	35	50	75	100

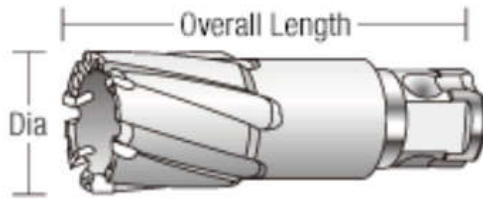

Model	Dia	L	Model	Dia	L	Model	Dia	L
MGX50N	57	50						
MGX50N	58	50						
MGX50N	59	50						
MGX50N	60	50						
MGX50N	61	50						
MGX50N	62	50						
MGX50N	63	50						
MGX50N	64	50						
MGX50N	65	50						

Center Pin For MGX



Model	Dia(mm)	Overall Length(mm)	Hole Saw Size(mm)
PIN35-6	6.35	90	MGX35N 12.0~17.0
PIN35-8	7.98	90	MGX35N 18.0~65.0
PIN50-6	6.35	102	MGX50N 12.0~17.0
PIN50-8	7.98	102	MGX50N 18.0~65.0
PIN75-6	6.35	130	MGX75N 12.0~17.0
PIN75-8	7.98	130	MGX75N 18.0~65.0
PIN100-6	6.35	160	MGX100N 12.0~17.0
PIN100-8	7.98	160	MGX100N 18.0~65.0

Ordering example | : **Model - (D x L)**
| **Minimum order q.ty 10 pieces**



CARBIDE TIPPED ANNULAE CUTTER WITH UNIVERSAL SHANK

* Carbide annular cutter with universal shank

MGX75N Type

Model	MGX35N	MGX50N	MGX75N	MGX100N
Diameter/D (mm)	Ø12-100	Ø12-65	Ø14-65	Ø14-65
Cutting Depl't L (mm)	35	50	75	100

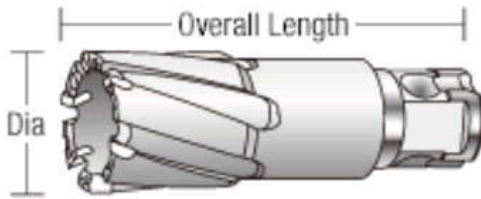

Model	Dia	L	Model	Dia	L	Model	Dia	L
MGX75N	12	75	MGX75N	27	75	MGX75N	42	75
MGX75N	13	75	MGX75N	28	75	MGX75N	43	75
MGX75N	14	75	MGX75N	29	75	MGX75N	44	75
MGX75N	15	75	MGX75N	30	75	MGX75N	45	75
MGX75N	16	75	MGX75N	31	75	MGX75N	46	75
MGX75N	17	75	MGX75N	32	75	MGX75N	47	75
MGX75N	18	75	MGX75N	33	75	MGX75N	48	75
MGX75N	19	75	MGX75N	34	75	MGX75N	49	75
MGX75N	20	75	MGX75N	35	75	MGX75N	50	75
MGX75N	21	75	MGX75N	36	75	MGX75N	51	75
MGX75N	22	75	MGX75N	37	75	MGX75N	52	75
MGX75N	23	75	MGX75N	38	75	MGX75N	53	75
MGX75N	24	75	MGX75N	39	75	MGX75N	54	75
MGX75N	25	75	MGX75N	40	75	MGX75N	55	75
MGX75N	26	75	MGX75N	41	75	MGX75N	56	75

Center Pin For MGX



Model	Dia(mm)	Overall Length(mm)	Hole Saw Size(mm)
PIN35-6	6.35	90	MGX35N 12.0~17.0
PIN35-8	7.98	90	MGX35N 18.0~65.0
PIN50-6	6.35	102	MGX50N 12.0~17.0
PIN50-8	7.98	102	MGX50N 18.0~65.0
PIN75-6	6.35	130	MGX75N 12.0~17.0
PIN75-8	7.98	130	MGX75N 18.0~65.0
PIN100-6	6.35	160	MGX100N 12.0~17.0
PIN100-8	7.98	160	MGX100N 18.0~65.0

Ordering example | : **Model - (D x L)**
| **Minimum order qty 10 pieces**



CARBIDE TIPPED ANNULAE CUTTER WITH UNIVERSAL SHANK

* Carbide annular cutter with universal shank

MGX75N Type

Model	MGX35N	MGX50N	MGX75N	MGX100N
Diameter/D (mm)	Ø12-100	Ø12-65	Ø14-65	Ø14-65
Cutting Depl't L (mm)	35	50	75	100

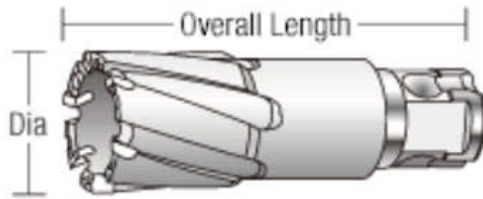

Model	Dia	L	Model	Dia	L	Model	Dia	L
MGX75N	57	75						
MGX75N	58	75						
MGX75N	59	75						
MGX75N	60	75						
MGX75N	61	75						
MGX75N	62	75						
MGX75N	63	75						
MGX75N	64	75						
MGX75N	65	75						

Center Pin For MGX



Model	Dia(mm)	Overall Length(mm)	Hole Saw Size(mm)
PIN35-6	6.35	90	MGX35N 12.0~17.0
PIN35-8	7.98	90	MGX35N 18.0~65.0
PIN50-6	6.35	102	MGX50N 12.0~17.0
PIN50-8	7.98	102	MGX50N 18.0~65.0
PIN75-6	6.35	130	MGX75N 12.0~17.0
PIN75-8	7.98	130	MGX75N 18.0~65.0
PIN100-6	6.35	160	MGX100N 12.0~17.0
PIN100-8	7.98	160	MGX100N 18.0~65.0

Ordering example | : **Model - (D x L)**
| **Minimum order q.ty 10 pieces**



CARBIDE TIPPED ANNULAE CUTTER WITH UNIVERSAL SHANK

* Carbide annular cutter with universal shank

MGX100N Type

Model	MGX35N	MGX50N	MGX75N	MGX100N
Diameter/D (mm)	Ø12-100	Ø12-65	Ø14-65	Ø14-65
Cutting Depl't L (mm)	35	50	75	100

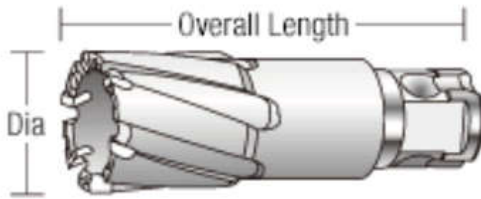

Model	Dia	L	Model	Dia	L	Model	Dia	L
MGX100N	12	100	MGX100N	27	100	MGX100N	42	100
MGX100N	13	100	MGX100N	28	100	MGX100N	43	100
MGX100N	14	100	MGX100N	29	100	MGX100N	44	100
MGX100N	15	100	MGX100N	30	100	MGX100N	45	100
MGX100N	16	100	MGX100N	31	100	MGX100N	46	100
MGX100N	17	100	MGX100N	32	100	MGX100N	47	100
MGX100N	18	100	MGX100N	33	100	MGX100N	48	100
MGX100N	19	100	MGX100N	34	100	MGX100N	49	100
MGX100N	20	100	MGX100N	35	100	MGX100N	50	100
MGX100N	21	100	MGX100N	36	100	MGX100N	51	100
MGX100N	22	100	MGX100N	37	100	MGX100N	52	100
MGX100N	23	100	MGX100N	38	100	MGX100N	53	100
MGX100N	24	100	MGX100N	39	100	MGX100N	54	100
MGX100N	25	100	MGX100N	40	100	MGX100N	55	100
MGX100N	26	100	MGX100N	41	100	MGX100N	56	100

Center Pin For MGX



Model	Dia(mm)	Overall Length(mm)	Hole Saw Size(mm)
PIN35-6	6.35	90	MGX35N 12.0~17.0
PIN35-8	7.98	90	MGX35N 18.0~65.0
PIN50-6	6.35	102	MGX50N 12.0~17.0
PIN50-8	7.98	102	MGX50N 18.0~65.0
PIN75-6	6.35	130	MGX75N 12.0~17.0
PIN75-8	7.98	130	MGX75N 18.0~65.0
PIN100-6	6.35	160	MGX100N 12.0~17.0
PIN100-8	7.98	160	MGX100N 18.0~65.0

Ordering example | : **Model - (D x L)**
| **Minimum order q.ty 10 pieces**



CARBIDE TIPPED ANNULAE CUTTER WITH UNIVERSAL SHANK

* Carbide annular cutter with universal shank

MGX100N Type

Model	MGX35N	MGX50N	MGX75N	MGX100N
Diameter/D (mm)	Ø12-100	Ø12-65	Ø14-65	Ø14-65
Cutting Depl't L (mm)	35	50	75	100

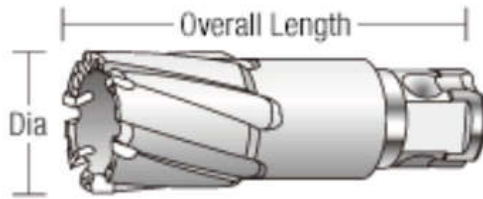

Model	Dia	L	Model	Dia	L	Model	Dia	L
MGX100N	57	100						
MGX100N	58	100						
MGX100N	59	100						
MGX100N	60	100						
MGX100N	61	100						
MGX100N	62	100						
MGX100N	63	100						
MGX100N	64	100						
MGX100N	65	100						

Center Pin For MGX



Model	Dia(mm)	Overall Length(mm)	Hole Saw Size(mm)
PIN35-6	6.35	90	MGX35N 12.0~17.0
PIN35-8	7.98	90	MGX35N 18.0~65.0
PIN50-6	6.35	102	MGX50N 12.0~17.0
PIN50-8	7.98	102	MGX50N 18.0~65.0
PIN75-6	6.35	130	MGX75N 12.0~17.0
PIN75-8	7.98	130	MGX75N 18.0~65.0
PIN100-6	6.35	160	MGX100N 12.0~17.0
PIN100-8	7.98	160	MGX100N 18.0~65.0

Ordering example | : **Model - (D x L)**
| **Minimum order q.ty 10 pieces**



CARBIDE TIPPED ANNULAE CUTTER WITH UNIVERSAL SHANK

* Shank Assembly - Side Lock



Model	Dia Hole Clamping	Hole Saw Size(mm)	Depth cutting L1
MGX-MT2	19.05	Ø11-100	50
MGX-MT3	19.05	Ø17-65	50
MGX-MT4	19.05	Ø11-100	50
MGX-MT5	19.05	Ø17-65	50
MGX-MT2	19.05	Ø11-100	75
MGX-MT3	19.05	Ø17-65	75
MGX-MT4	19.05	Ø11-100	75
MGX-MT5	19.05	Ø17-65	75
MGX-MT2	19.05	Ø11-100	100
MGX-MT3	19.05	Ø17-65	100
MGX-MT4	19.05	Ø11-100	100
MGX-MT5	19.05	Ø17-65	100

Ordering example | : **Model - (D x L)**
 | **Minimum order q.ty 10 pieces**



CARBIDE TIPPED THICK PLATE HOLE SAW WITH TRIANGLE SHANK

* Carbide Tips cutter with Triangle shank

MGTR (25mm)Type

Model	MGTR	MGTL
Diameter/D (mm)	Ø12-150	Ø19-100
Cutting Depl't L (mm)	25	50
Dia shank Shape d (mm)	Ø12-69 : d = 10mm Ø70-150 : d = 13mm	Ø19-69 : d = 10mm Ø70-100 : d = 13mm

- Newly developed step center drill .
- Cutting waste drainage groove .
- It is applicable to drilling through 25mm, 50mm height round tube, square tube, thin plate and other metal materials.

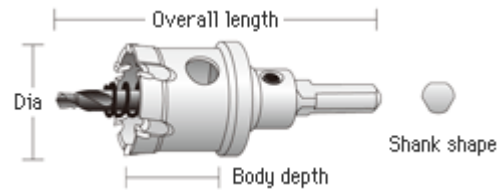

Model	Dia	L	Model	Dia	L	Model	Dia	L
MGTR	12	25	MGTR	36	25	MGTR	60	25
MGTR	13	25	MGTR	37	25	MGTR	61	25
MGTR	14	25	MGTR	38	25	MGTR	62	25
MGTR	15	25	MGTR	39	25	MGTR	63	25
MGTR	16	25	MGTR	40	25	MGTR	64	25
MGTR	17	25	MGTR	41	25	MGTR	65	25
MGTR	18	25	MGTR	42	25	MGTR	66	25
MGTR	19	25	MGTR	43	25	MGTR	67	25
MGTR	20	25	MGTR	44	25	MGTR	68	25
MGTR	21	25	MGTR	45	25	MGTR	69	25
MGTR	22	25	MGTR	46	25	MGTR	70	25
MGTR	23	25	MGTR	47	25	MGTR	71	25
MGTR	24	25	MGTR	48	25	MGTR	72	25
MGTR	25	25	MGTR	49	25	MGTR	73	25
MGTR	26	25	MGTR	50	25	MGTR	74	25
MGTR	27	25	MGTR	51	25	MGTR	75	25
MGTR	28	25	MGTR	52	25	MGTR	76	25
MGTR	29	25	MGTR	53	25	MGTR	77	25
MGTR	30	25	MGTR	54	25	MGTR	78	25
MGTR	31	25	MGTR	55	25	MGTR	79	25
MGTR	32	25	MGTR	56	25	MGTR	80	25
MGTR	33	25	MGTR	57	25	MGTR	81	25
MGTR	34	25	MGTR	58	25	MGTR	82	25
MGTR	35	25	MGTR	59	25	MGTR	83	25

Ordering example | : Model - (D x L)

| Minimum order q.ty 10 pieces



CARBIDE TIPPED THICK PLATE HOLE SAW WITH TRIANGLE SHANK

* Carbide Tips cutter with Triangle shank

MGTR (25mm)Type

Model	MGTR	MGTL
Diameter/D (mm)	Ø12-150	Ø19-100
Cutting Depl L (mm)	25	50
Dia shank Shape d (mm)	Ø12-69 : d = 10mm Ø70-150 : d = 13mm	Ø19-69 : d = 10mm Ø70-100 : d = 13mm

- Newly developed step center drill .
- Cutting waste drainage groove .
- It is applicable to drilling through 25mm, 50mm height round tube, square tube, thin plate and other metal materials.

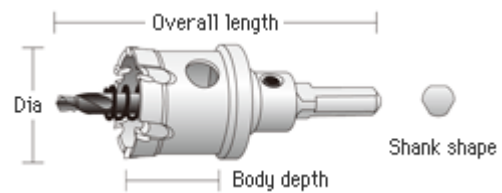

Model	Dia	L	Model	Dia	L	Model	Dia	L
MGTR	84	25	MGTR	108	25	MGTR	132	25
MGTR	85	25	MGTR	109	25	MGTR	133	25
MGTR	86	25	MGTR	110	25	MGTR	134	25
MGTR	87	25	MGTR	111	25	MGTR	135	25
MGTR	88	25	MGTR	112	25	MGTR	136	25
MGTR	89	25	MGTR	113	25	MGTR	137	25
MGTR	90	25	MGTR	114	25	MGTR	138	25
MGTR	91	25	MGTR	115	25	MGTR	139	25
MGTR	92	25	MGTR	116	25	MGTR	140	25
MGTR	93	25	MGTR	117	25	MGTR	141	25
MGTR	94	25	MGTR	118	25	MGTR	142	25
MGTR	95	25	MGTR	119	25	MGTR	143	25
MGTR	96	25	MGTR	120	25	MGTR	144	25
MGTR	97	25	MGTR	121	25	MGTR	145	25
MGTR	98	25	MGTR	122	25	MGTR	146	25
MGTR	99	25	MGTR	123	25	MGTR	147	25
MGTR	100	25	MGTR	124	25	MGTR	148	25
MGTR	101	25	MGTR	125	25	MGTR	149	25
MGTR	102	25	MGTR	126	25	MGTR	150	25
MGTR	103	25	MGTR	127	25			
MGTR	104	25	MGTR	128	25			
MGTR	105	25	MGTR	129	25			
MGTR	106	25	MGTR	130	25			
MGTR	107	25	MGTR	131	25			

Ordering example | : **Model - (D x L)**

| **Minimum order q.ty 10 pieces**



CARBIDE TIPPED THICK PLATE HOLE SAW WITH TRIANGLE SHANK

* Carbide Tips cutter with Triangle shank

MGTL(50mm)Type

Model	MGTR	MGTL
Diameter/D (mm)	Ø12-150	Ø19-100
Cutting Depl't L (mm)	25	50
Dia shank Shape d (mm)	Ø12-69 : d = 10mm Ø70-150 : d = 13mm	Ø19-69 : d = 10mm Ø70-100 : d = 13mm

- Newly developed step center drill .
- Cutting waste drainage groove .
- It is applicable to drilling through 25mm, 50mm height round tube, square tube, thin plate and other metal materials.

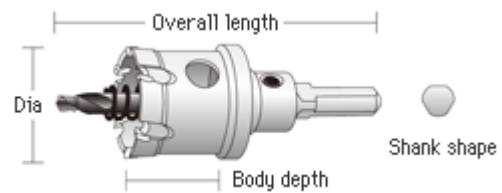

Model	Dia	L	Model	Dia	L	Model	Dia	L
MGTL	19	50	MGTL	47	50	MGTL	76	50
MGTL	20	50	MGTL	48	50	MGTL	77	50
MGTL	21	50	MGTL	49	50	MGTL	78	50
MGTL	22	50	MGTL	50	50	MGTL	79	50
MGTL	23	50	MGTL	51	50	MGTL	80	50
MGTL	24	50	MGTL	52	50	MGTL	81	50
MGTL	25	50	MGTL	53	50	MGTL	82	50
MGTL	26	50	MGTL	54	50	MGTL	83	50
MGTL	27	50	MGTL	55	50	MGTL	84	50
MGTL	28	50	MGTL	56	50	MGTL	85	50
MGTL	29	50	MGTL	57	50	MGTL	86	50
MGTL	30	50	MGTL	58	50	MGTL	87	50
MGTL	31	50	MGTL	59	50	MGTL	88	50
MGTL	32	50	MGTL	60	50	MGTL	89	50
MGTL	33	50	MGTL	61	50	MGTL	90	50
MGTL	34	50	MGTL	62	50	MGTL	91	50
MGTL	35	50	MGTL	63	50	MGTL	92	50
MGTL	36	50	MGTL	64	50	MGTL	93	50
MGTL	37	50	MGTL	65	50	MGTL	94	50
MGTL	38	50	MGTL	66	50	MGTL	95	50
MGTL	39	50	MGTL	67	50	MGTL	96	50
MGTL	40	50	MGTL	68	50	MGTL	97	50
MGTL	41	50	MGTL	69	50	MGTL	98	50
MGTL	42	50	MGTL	70	50	MGTL	99	50
MGTL	43	50	MGTL	71	50	MGTL	100	50
MGTL	44	50	MGTL	72	50			
MGTL	45	50	MGTL	73	50			
MGTL	46	50	MGTL	74	50			

Ordering example | : Model - (D x L)

| Minimum order q.ty 10 pieces



MEGACUT

BROACHING TOOL

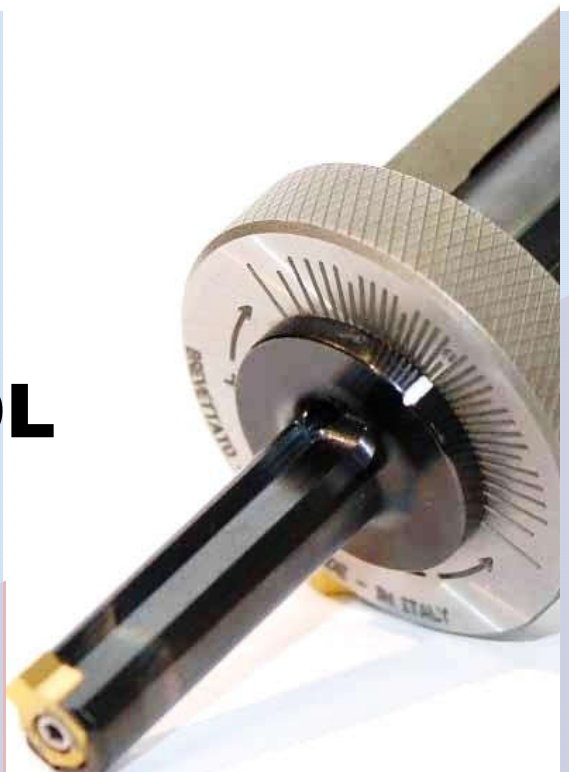

BROACHING TOOL

TOOLS FOR INTERNAL

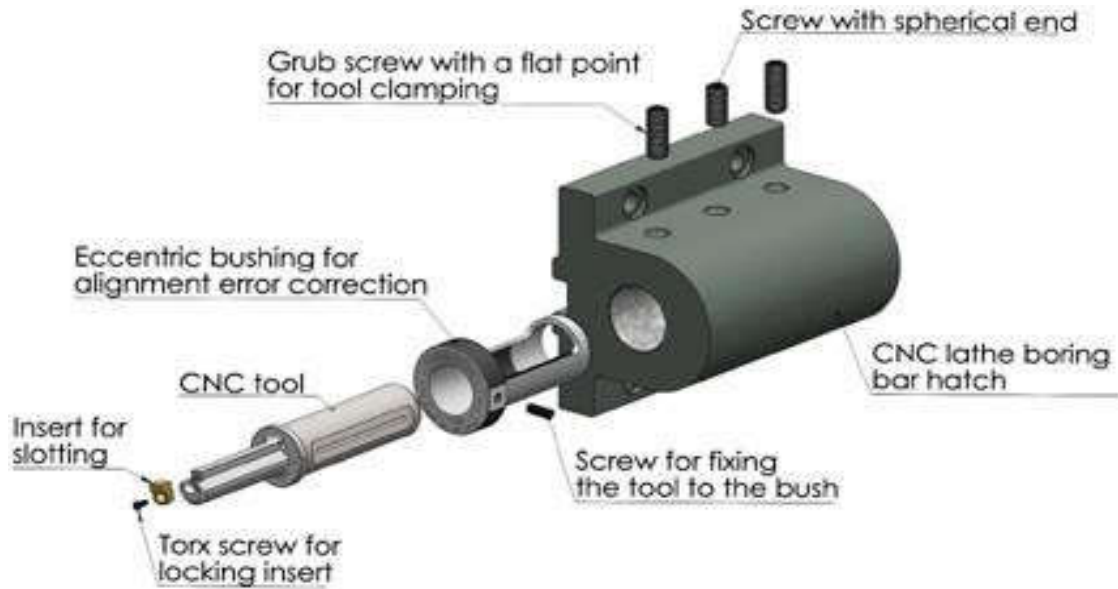

BROACHING TOOL

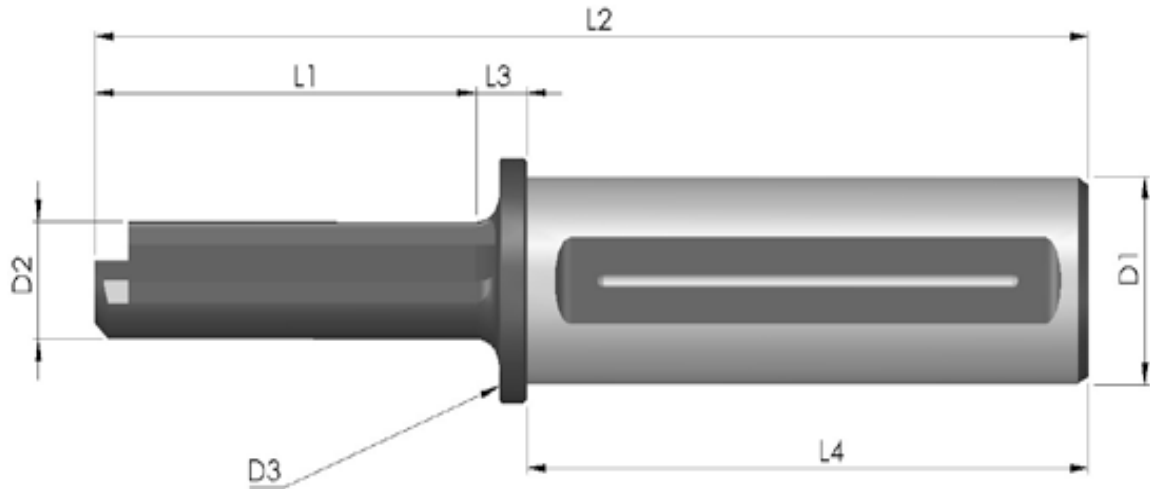

Model	L1 (mm)	L2 (mm)	L3 (mm)	L4 (mm)	D1 (mm)	D2 (mm)	D3 (mm)	Screwdriver	Minimum hole (mm)
UT-02-25*	25	124	9	90	25	6	30	T08	7
UT-02-25-L*	34,5	133,5	9	90	25	6	30	T08	7
UT-02-32*	25	134	9	100	32	6	37	T08	7
UT-02-32-L*	34,5	143,5	9	100	32	6	37	T08	7
UT-03-25*	30	129	9	90	25	8	30	T08	8,7
UT-03-25-L*	40	139	9	90	25	8	30	T08	8,7
UT-03-32*	30	139	9	100	32	8	37	T08	8,7
UT-03-32-L*	40	149	9	100	32	8	37	T08	8,7
UT-04-25*	40	139	9	90	25	10	30	T08	11
UT-04-25-L*	56	155	9	90	25	10	30	T08	11
UT-04-32*	40	149	9	100	32	10	37	T08	11
UT-04-32-L*	56	165	9	100	32	10	37	T08	11
UT-05-25*	46	145	9	90	25	12	30	T08	13
UT-05-25-L*	66	165	9	90	25	12	30	T08	13
UT-05-32*	46	155	9	100	32	12	37	T08	13
UT-05-32-L*	66	175	9	100	32	12	37	T08	13
UT-06-25*	56	155	9	90	25	16	30	T15	17
UT-06-25-L*	81	180	9	90	25	16	30	T15	17
UT-06-32*	56	165	9	100	32	16	37	T15	17
UT-06-32-L*	81	190	9	100	32	16	37	T15	17
UT-08-25*	68	167	9	90	25	20	30	T15	21,5
UT-08-25-L*	100	199	9	90	25	20	30	T15	21,5

Ordering example | : **Model**



BROACHING TOOL

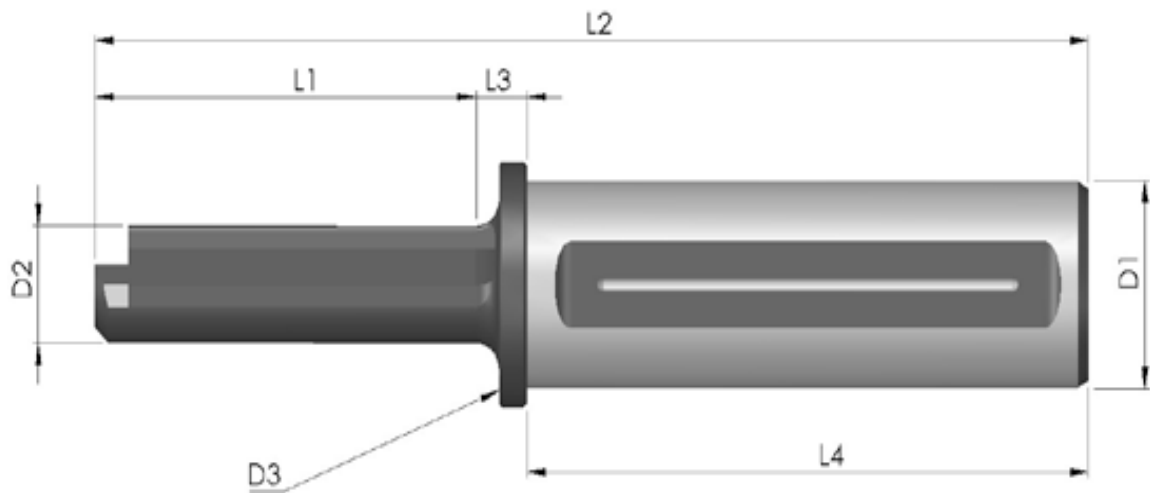

Model	L1 (mm)	L2 (mm)	L3 (mm)	L4 (mm)	D1 (mm)	D2 (mm)	D3 (mm)	Screwdriver	Minimum hole (mm)
UT-08-32*	68	177	9	100	32	20	37	T15	21,5
UT-08-32-L*	100	209	9	100	32	20	37	T15	21,5
UT-10-25	86	185	9	90	25	25	32	T20	28
UT-10-25-L	126	225	9	90	25	25	32	T20	28
UT-10-32*	86	195	9	100	32	25	37	T20	28
UT-10-32-L*	126	235	9	100	32	25	37	T20	28
UT-12-25	104	203	9	90	25	30	35	T20	32
UT-12-25-L	161	260	9	90	25	30	35	T20	32
UT-12-32*	104	213	9	100	32	30	37	T20	32
UT-12-32-L*	161	270	9	100	32	30	37	T20	32
UT-14/16-25	126	225	9	90	25	35	37	T20	37
UT-14/16-25-L	180	279	9	90	25	35	37	T20	37
UT-14/16-32	126	235	9	100	32	35	37	T20	37
UT-14/16-32-L	180	289	9	100	32	35	37	T20	37
UT-18/25-32	140	249	9	100	32	40	45	BRUG.5	45
UT-18/25-32-L	200	309	9	100	32	40	45	BRUG.5	45

Ordering example | : **Model**



BROACHING TOOL

INSERTS (MM)

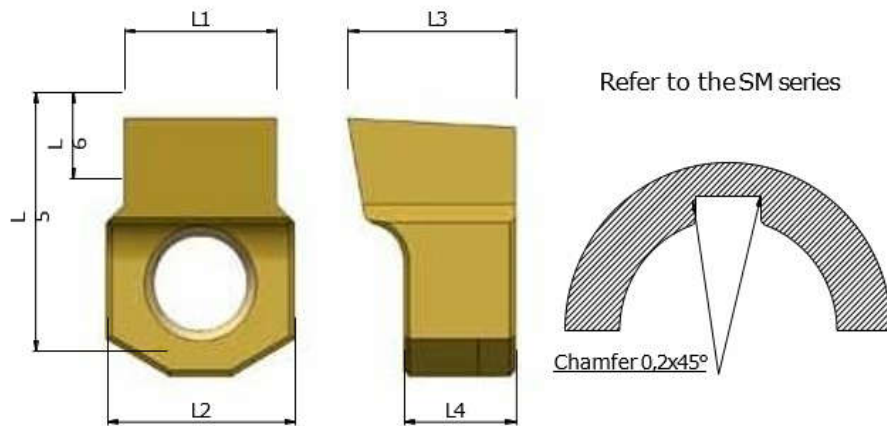

Model	L1 (mm)	L2 (mm)	L3 (mm)	L4 (mm)	L5 (mm)	L6 (mm)	Tool
IN-02 P9	1,994	5	6,5	5	6	1,3	UT-02
IN-02 P9-SM	1,994	5	6,5	5	6	1,09	UT-02
IN-02 H7	2,010	5	6,5	5	6	1,3	UT-02
IN-02 H7-SM	2,010	5	6,5	5	6	1,09	UT-02
IN-02 D10	2,060	5	6,5	5	6	1,3	UT-02
IN-02 C11	2,120	5	6,5	5	6	1,3	UT-02
IN-03 P9	2,994	6,08	6,5	5	7,5	2	UT-03
IN-03 P9-SM	2,994	6,08	6,5	5	7,5	1,42	UT-03
IN-03 H7	3,010	6,08	6,5	5	7,5	2	UT-03
IN-03 H7-SM	3,010	6,08	6,5	5	7,5	1,42	UT-03
IN-03 D10	3,06	6,08	6,5	5	7,5	2	UT-03
IN-03 C11	3,120	6,08	6,5	5	7,5	2	UT-03
IN-04 P9	3,988	6,08	7	5	8	2,6	UT-04
IN-04 P9-SM	3,988	6,08	7	5	8	2,07	UT-04
IN-04 H7	4,012	6,08	7	5	8	2,6	UT-04
IN-04 H7-SM	4,012	6,08	7	5	8	2,07	UT-04
IN-04 D10	4,078	6,08	7	5	8	2,6	UT-04
IN-04 C11	4,145	6,08	7	5	8	2,6	UT-04
IN-05 P9	4,988	6,08	7	5	8	3	UT-05
IN-05 P9-SM	4,988	6,08	7	5	8	2,74	UT-05
IN-05 H7	5,012	6,08	7	5	8	3	UT-05
IN-05 H7-SM	5,012	6,08	7	5	8	2,74	UT-05
IN-05 D10	5,078	6,08	7	5	8	3	UT-05
IN-05 C11	5,145	6,08	7	5	8	3	UT-05
IN-06 P9	5,988	10,08	9	6	13,5	4	UT-06
IN-06 P9-SM	5,988	10,08	9	6	13,5	3	UT-06
IN-06 H7	6,012	10,08	9	6	13,5	4	UT-06
IN-06 H7-SM	6,012	10,08	9	6	13,5	3	UT-06
IN-06 D10	6,078	10,08	9	6	13,5	4	UT-06
IN-06 C11	6,145	10,08	9	6	13,5	4	UT-06

Ordering example | : **Model**



BROACHING TOOL

INSERTS (MM)

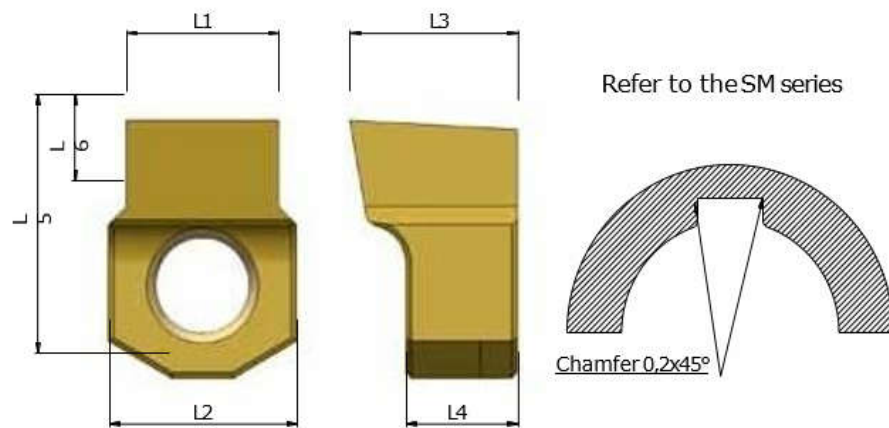

Model	L1 (mm)	L2 (mm)	L3 (mm)	L4 (mm)	L5 (mm)	L6 (mm)	Tool
IN-08 P9	7,985	10,08	9	6	13,5	4,5	UT-08
IN-08 P9-SM	7,985	10,08	9	6	13,5	3,78	UT-08
IN-08 H7	8,015	10,08	9	6	13,5	4,5	UT-08
IN-08 H7-SM	8,015	10,08	9	6	13,5	3,78	UT-08
IN-08 D10	8,098	10,08	9	6	13,5	4,5	UT-08
IN-08 C11	8,170	10,08	9	6	13,5	4,5	UT-08
IN-10 P9	9,985	13,1	14	10	18,5	6	UT-10
IN-10 P9-SM	9,985	13,1	14	10	18,5	3,88	UT-10
IN-10 H7	10,015	13,1	14	10	18,5	6	UT-10
IN-10 H7-SM	10,015	13,1	14	10	18,5	3,88	UT-10
IN-10 D10	10,098	13,1	14	10	18,5	6	UT-10
IN-10 C11	10,170	13,1	14	10	18,5	6	UT-10
IN-12 P9	11,982	13,1	14	10	18,5	6,5	UT-12
IN-12 P9-SM	11,982	13,1	14	10	18,5	3,89	UT-12
IN-12 H7	12,018	13,1	14	10	18,5	6,5	UT-12
IN-12 H7-SM	12,018	13,1	14	10	18,5	3,89	UT-12
IN-12 D10	12,12	13,1	14	10	18,5	6,5	UT-12
IN-12 C11	12,205	13,1	14	10	18,5	6,5	UT-12
IN-14 P9	13,982	18	14	10	22	7	UT-14/16
IN-14 P9-SM	13,982	18	14	10	22	4,71	UT-14/16
IN-14 H7	14,018	18	14	10	22	7	UT-14/16
IN-14 H7-SM	14,018	18	14	10	22	4,71	UT-14/16
IN-14 D10	14,120	18	14	10	22	7	UT-14/16
IN-14 C11	14,205	18	14	10	22	7	UT-14/16
IN-16 P9	15,982	18	14	10	22	8	UT-14/16
IN-16 P9-SM	15,982	18	14	10	22	5,53	UT-14/16
IN-16 H7	16,018	18	14	10	22	8	UT-14/16
IN-16 H7-SM	16,018	18	14	10	22	5,53	UT-14/16
IN-16 D10	16,120	18	14	10	22	8	UT-14/16
IN-16 C11	16,205	18	14	10	22	8	UT-14/16

Ordering example | : **Model**



BROACHING TOOL

INSERTS (MM)

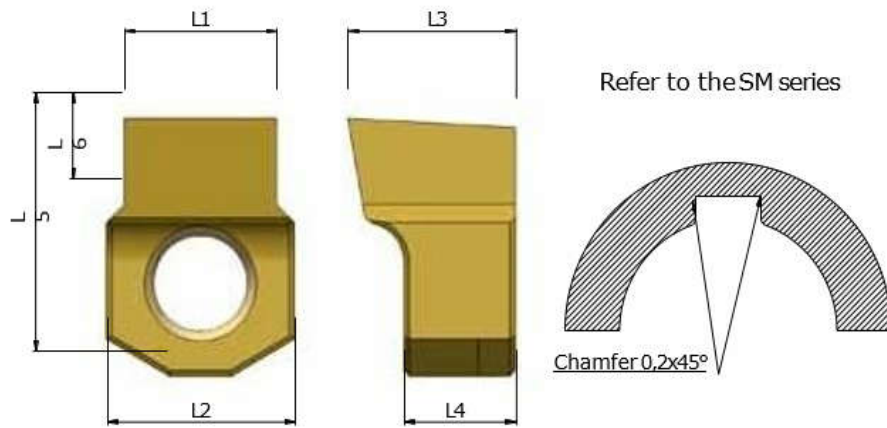

Model	L1 (mm)	L2 (mm)	L3 (mm)	L4 (mm)	L5 (mm)	L6 (mm)	Tool
IN-18P9**	17,982	26	18	10	30	9	UT-18/25
IN-18 P9-SM**	17,982	26	18	10	30	5,67	UT-18/25
IN-18H7**	18,018	26	18	10	30	9	UT-18/25
IN-18H7-SM**	18,018	26	18	10	30	5,67	UT-18/25
IN-18D10**	18,120	26	18	10	30	9	UT-18/25
IN-18C11**	18,205	26	18	10	30	9	UT-18/25
IN-20P9**	19,978	26	18	10	30	10	UT-18/25
IN-20 P9-SM**	19,978	26	18	10	30	6,29	UT-18/25
IN-20H7**	20,021	26	18	10	30	10	UT-18/25
IN-20 H7-SM**	20,021	26	18	10	30	6,29	UT-18/25
IN-20D10**	20,149	26	18	10	30	10	UT-18/25
IN-20C11**	20,240	26	18	10	30	10	UT-18/25
IN-22P9**	21,978	26	18	10	30	11	UT-18/25
IN-22 P9-SM**	21,978	26	18	10	30	6,79	UT-18/25
IN-22H7**	22,021	26	18	10	30	11	UT-18/25
IN-22 H7-SM**	22,021	26	18	10	30	6,79	UT-18/25
IN-22D10**	22,149	26	18	10	30	11	UT-18/25
IN-22C11**	22,240	26	18	10	30	11	UT-18/25
IN-25P9**	24,978	26	18	10	30	12	UT-18/25
IN-25 P9-SM**	24,978	26	18	10	30	7,02	UT-18/25
IN-25H7**	25,021	26	18	10	30	12	UT-18/25
IN-25 H7-SM**	25,021	26	18	10	30	7,02	UT-18/25
IN-25D10**	25,149	26	18	10	30	12	UT-18/25
IN-25C11**	25,240	26	18	10	30	12	UT-18/25

Ordering example | : **Model**



BROACHING TOOL

INSERTS (INCHES)

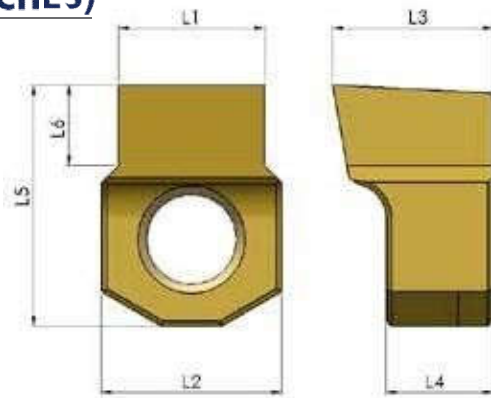

Model	L1 (inch)	L2 (inch)	L3 (inch)	L4 (inch)	L5 (inch)	L6 (inch)	Tool
IN-3/32"-P9	0,0932	0,1968	0,2362	0,1968	0,2559	0,0551	UT-02
IN-3/32"-H7	0,0941	0,1968	0,2362	0,1968	0,2559	0,0551	UT-02
IN-3/32"-D10	0,0961	0,1968	0,2362	0,1968	0,2559	0,0551	UT-02
IN-3/32"-C11	0,0984	0,1968	0,2362	0,1968	0,2559	0,0551	UT-02
IN-1/8"-P9	0,1243	0,2393	0,2559	0,1968	0,2952	0,0905	UT-03
IN-1/8"-H7	0,1254	0,2393	0,2559	0,1968	0,2952	0,0905	UT-03
IN-1/8"-D10	0,128	0,2393	0,2559	0,1968	0,2952	0,0905	UT-03
IN-1/8"-C11	0,1307	0,2393	0,2559	0,1968	0,2952	0,0905	UT-03
IN-5/32"-P9	0,1555	0,2393	0,2755	0,1968	0,3149	0,1141	UT-04
IN-5/32"-H7	0,1567	0,2393	0,2755	0,1968	0,3149	0,1141	UT-04
IN-5/32"-D10	0,1593	0,2393	0,2755	0,1968	0,3149	0,1141	UT-04
IN-5/32"-C11	0,1619	0,2393	0,2755	0,1968	0,3149	0,1141	UT-04
IN-3/16"-P9	0,1868	0,2393	0,2755	0,1968	0,3149	0,1299	UT-05
IN-3/16"-H7	0,1879	0,2393	0,2755	0,1968	0,3149	0,1299	UT-05
IN-3/16"-D10	0,1905	0,2393	0,2755	0,1968	0,3149	0,1299	UT-05
IN-3/16"-C11	0,1932	0,2393	0,2755	0,1968	0,3149	0,1299	UT-05
IN-1/4"-P9	0,2491	0,3968	0,3543	0,2362	0,5314	0,1587	UT-06
IN-1/4"-H7	0,2505	0,3968	0,3543	0,2362	0,5314	0,1587	UT-06
IN-1/4"-D10	0,2538	0,3968	0,3543	0,2362	0,5314	0,1587	UT-06
IN-1/4"-C11	0,2566	0,3968	0,3543	0,2362	0,5314	0,1587	UT-06
IN-9/32"-P9	0,2804	0,3968	0,3543	0,2362	0,5314	0,1692	UT-08
IN-9/32"-H7	0,2818	0,3968	0,3543	0,2362	0,5314	0,1692	UT-08
IN-9/32"-D10	0,2851	0,3968	0,3543	0,2362	0,5314	0,1692	UT-08
IN-9/32"-C11	0,2879	0,3968	0,3543	0,2362	0,5314	0,1692	UT-08
IN-5/16"-P9	0,3116	0,3968	0,3543	0,2362	0,5314	0,1875	UT-08
IN-5/16"-H7	0,313	0,3968	0,3543	0,2362	0,5314	0,1875	UT-08
IN-5/16"-D10	0,3163	0,3968	0,3543	0,2362	0,5314	0,1875	UT-08
IN-5/16"-C11	0,3191	0,3968	0,3543	0,2362	0,5314	0,1875	UT-08
IN-3/8"-P9	0,3741	0,5157	0,5511	0,3937	0,7283	0,2500	UT-10
IN-3/8"-H7	0,3755	0,5157	0,5511	0,3937	0,7283	0,250	UT-10

Ordering example | : **Model**



BROACHING TOOL

INSERTS (INCHES)

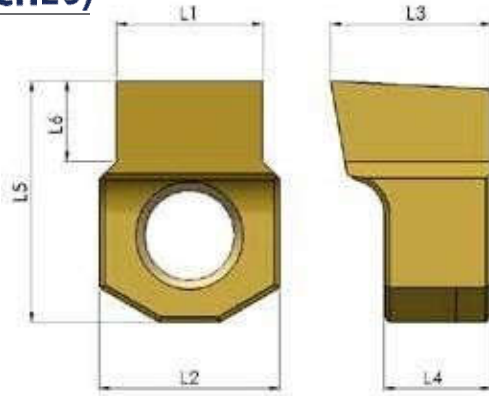

Model	L1 (inch)	L2 (inch)	L3 (inch)	L4 (inch)	L5 (inch)	L6 (inch)	Tool
IN-3/8"-D10	0,3788	0,5157	0,5511	0,3937	0,7283	0,250	UT-10
IN-3/8"-C11	0,3816	0,5157	0,5511	0,3937	0,7283	0,250	UT-10
IN-7/16"-P9	0,4364	0,5157	0,5511	0,3937	0,7283	0,250	UT-12
IN-7/16"-H7	0,4382	0,5157	0,5511	0,3937	0,7283	0,250	UT-12
IN-7/16"-D10	0,4422	0,5157	0,5511	0,3937	0,7283	0,250	UT-12
IN-7/16"-C11	0,4455	0,5157	0,5511	0,3937	0,7283	0,250	UT-12
IN-1/2"-P9	0,4989	0,5157	0,5511	0,3937	0,7283	0,300	UT-12
IN-1/2"-H7	0,5007	0,5157	0,5511	0,3937	0,7283	0,300	UT-12
IN-1/2"-D10	0,5047	0,5157	0,5511	0,3937	0,7283	0,300	UT-12
IN-1/2"-C11	0,508	0,5157	0,5511	0,3937	0,7283	0,300	UT-12
IN-9/16"-P9	0,5614	0,7086	0,5511	0,3937	0,8661	0,275	UT-14/16
IN-9/16"-H7	0,5632	0,7086	0,5511	0,3937	0,8661	0,275	UT-14/16
IN-9/16"-D10	0,5672	0,7086	0,5511	0,3937	0,8661	0,275	UT-14/16
IN-9/16"-C11	0,5705	0,7086	0,5511	0,3937	0,8661	0,275	UT-14/16
IN-5/8"-P9	0,6239	0,7086	0,5511	0,3937	0,8661	0,312	UT-14/16
IN-5/8"-H7	0,6257	0,7086	0,5511	0,3937	0,8661	0,312	UT-14/16
IN-5/8"-D10	0,6297	0,7086	0,5511	0,3937	0,8661	0,312	UT-14/16
IN-5/8"-C11	0,633	0,7086	0,5511	0,3937	0,8661	0,312	UT-14/16
IN-3/4"-P9**	0,7487	1,024	0,7086	0,3937	1,181	0,393	UT-18/25
IN-3/4"-H7**	0,7508	1,024	0,7086	0,3937	1,181	0,393	UT-18/25
IN-3/4"-D10**	0,7558	1,024	0,7086	0,3937	1,181	0,393	UT-18/25
IN-3/4"-C11**	0,7594	1,024	0,7086	0,3937	1,181	0,393	UT-18/25

TOOLS AND INSERTS FOR SQUARE

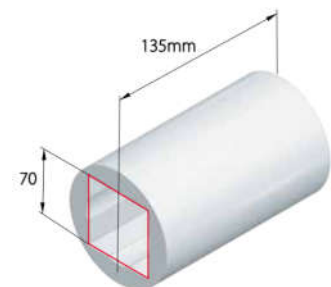
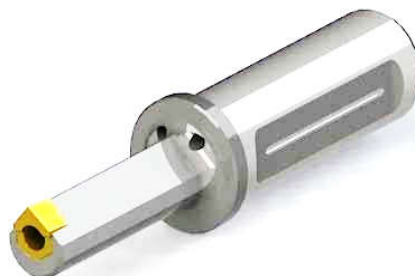

Ordering example | : **Model**



BROACHING TOOL

TOOLS FOR SQUARE

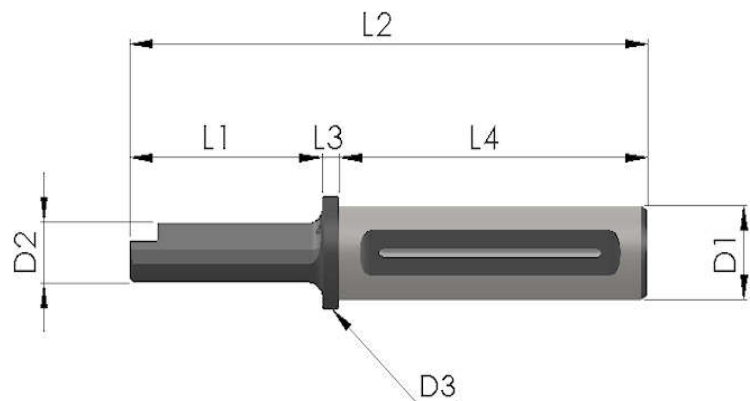

CODE	L1 (mm)	L2 (mm)	L3 (mm)	L4 (mm)	D1 (mm)	D2 (mm)	D3 (mm)	Minimum hole (mm)
UT-SQ-8/10-25	30	129	9	90	25	7,25	30	8
UT-SQ-8/10-32	30	139	9	100	32	7,25	38	8
UT-SQ-10/13-25	40	139	9	90	25	8,6	30	10
UT-SQ-10/13-32	40	149	9	100	32	8,6	38	10
UT-SQ-13/16-25	50	149	9	90	25	12	30	13
UT-SQ-13/16-32	50	159	9	100	32	12	38	13
UT-SQ-16/19-25	52	151	9	90	25	15	30	16
UT-SQ-16/19-32	52	161	9	100	32	15	38	16
UT-SQ-19/27-25	86	185	9	90	25	18,50	30	19
UT-SQ-19/27-32	86	195	9	100	32	18,50	38	19
UT-SQ-27/37-25	100	199	9	90	25	25	30	27
UT-SQ-27/37-32	100	209	9	100	32	25	38	27
UT-SQ-37/50-32	140	249	9	100	32	35	45	37

INSERTS FOR SQUARE

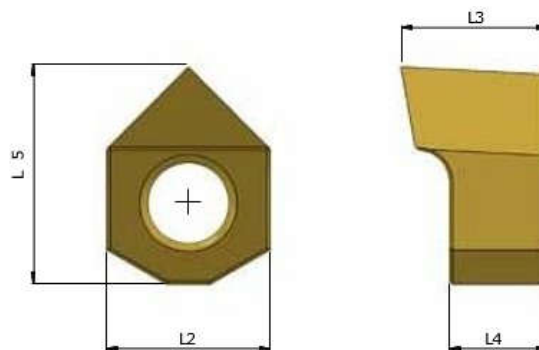

CODE	Working range (mm)	Working range (inches)	L2 (mm)	L3 (mm)	L4 (mm)	L5 (mm)	Tool
IN-SQ-8/10	8mm/10mm	0,314/0,393	6	7	5	7	UT-SQ-8/10
IN-SQ-10/13	10mm/13mm	0,393/0,511	6	7	5	7,5	UT-SQ-10/13
IN-SQ-13/16	13mm/16mm	0,511/0,629	10	8	6	12	UT-SQ-13/16
IN-SQ-16/19	16mm/19mm	0,629/0,748	10	8	6	12,5	UT-SQ-16/19
IN-SQ-19/27	19mm/27mm	0,748/1,062	13	13	10	17	UT-SQ-19/27
IN-SQ-27/37	27mm/37mm	1,062/1,456	18	14	10	22	UT-SQ-27/37
IN-SQ-37/50	37mm/50mm	1,456/1,968	26	18	10	30	UT-SQ-37/50

Ordering example | : **Model**



BROACHING TOOL

TOOLS AND INSERTS FOR HEXAGON



TOOLS FOR HEXAGON

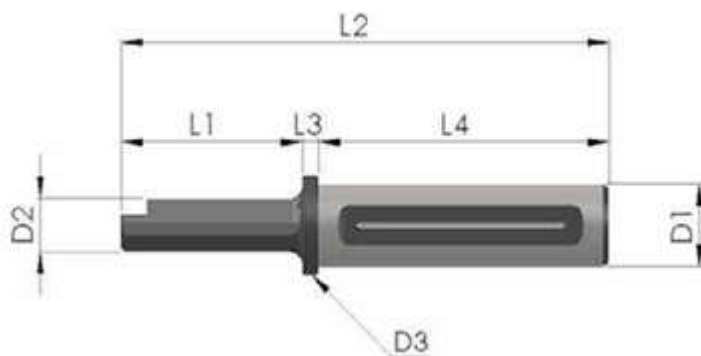

CODE	L1 (mm)	L2 (mm)	L3 (mm)	L4 (mm)	D1 (mm)	D2 (mm)	D3 (mm)	Minimum hole (mm)
UT-HEX-9/11-25	30	129	9	90	25	8	30	9
UT-HEX-9/11-32	30	139	9	100	32	8	38	9
UT-HEX-11/17-25	40	139	9	90	25	10	30	11
UT-HEX-11/17-32	40	149	9	100	32	10	38	11
UT-HEX-17/28-25	56	155	9	90	25	15	30	17
UT-HEX-17/28-32	56	165	9	100	32	15	38	17
UT-HEX-28/37-25	86	185	9	90	25	25	30	28
UT-HEX-28/37-32	86	195	9	100	32	25	38	28
UT-HEX-37/45-25	126	225	9	90	25	35	45	37
UT-HEX-37/45-32	126	235	9	100	32	35	45	37
UT-HEX-45/70-32	140	249	9	100	32	40	45	45

Ordering example | : **Model**



BROACHING TOOL

INSERTS FOR HEXAGON

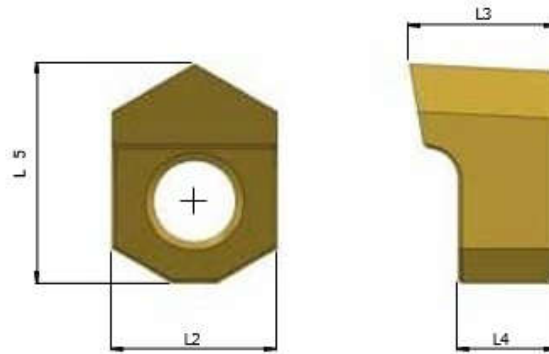

CODE	Working range (mm)	Working range (inches)	L2 (mm)	L3 (mm)	L4 (mm)	L5 (mm)	Tool
IN-HEX-9/11	9mm/11mm	0,354/0,433	6	7	5	7,5	UT-HEX- 9/11
IN-HEX-11/17	11mm/17mm	0,433/0,669	6	7	5	8	UT-HEX- 11/17
IN-HEX-17/28	17mm/28mm	0,669/1,102	10	9	6	13,5	UT-HEX- 17/28
IN-HEX-28/37	28mm/37mm	1,102/1,456	13	14	10	18,5	UT-HEX- 28/37
IN-HEX-37/45	37mm/45mm	1,456/1,771	18	14	10	22	UT-HEX- 37/45
IN-HEX-45/70	45mm/70mm	1,771/2,755	26	16	10	30	UT-HEX- 45/70

Ordering example | : **Model**



BROACHING TOOL

BUSHINGS FOR LATHES

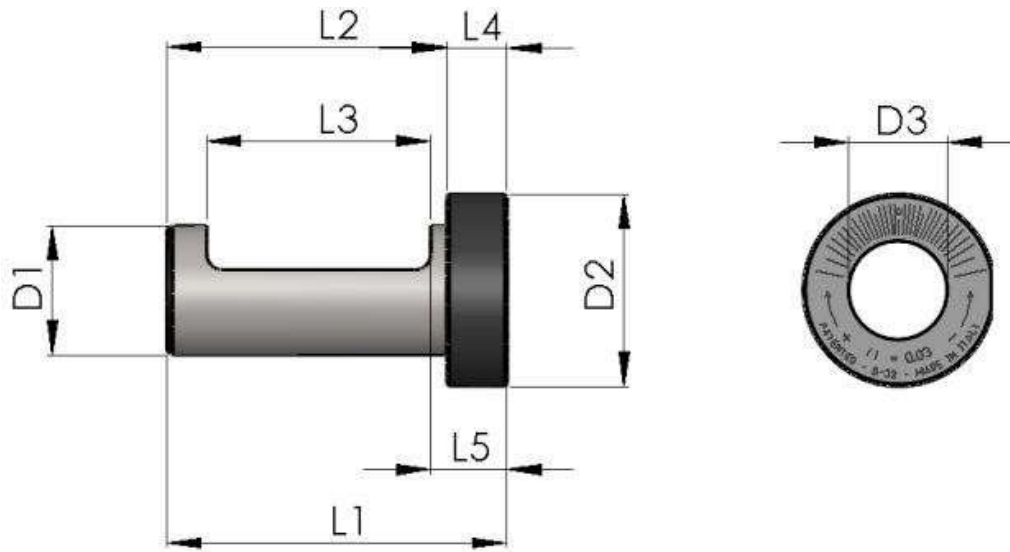

BUSHINGS FOR LATHES (mm)

Model	L1(mm)	L2(mm)	L3(mm)	L4(mm)	L5(mm)	D1(mm)	D2(mm)	D3(mm)
B-32	85	70	58	15	20	32H7	48	25
B-40	95	80	66	15	20	40H7	55	32
B-50	115	100	75	15	20	50H7	65	32
B-60	115	100	75	15	20	60H7	80	32
B-32VDI	65	50	38	15	20	32H7	48	25
B-40VDI	80	65	51	15	20	40H7	55	32
B-50VDI	95	80	55	15	20	50H7	65	32
B-60VDI	105	80	65	15	20	60H7	80	32

BUSHINGS FOR LATHES (inches)

Model	L1(inches)	L2(inches)	L3(inches)	L4(inches)	L5(inches)	D1(inches)	D2(inches)	D3(inches)
B-1-1/4"	3,346	2,756	2,283	0,591	0,787	1,250	2,165	0,984
B-1-1/2"	3,740	3,150	2,598	0,591	0,787	1,500	2,165	1,260
B-2"	4,528	3,937	2,953	0,591	0,787	2,000	2,559	1,260
B-1-1/4"-VDI	2,559	1,969	1,496	0,591	0,787	1,250	2,165	0,984
B-1-1/2"-VDI	3,150	2,559	2,008	0,591	0,787	1,500	2,165	1,260
B-2"-VDI	3,740	3,150	2,165	0,591	0,787	2,000	2,559	1,260

Ordering example | : **Model**



