

# MEGACUT

CATALOGO

## CIRCULAR SAW - T.C.T. HOLE SAW - BROACHING TOOL

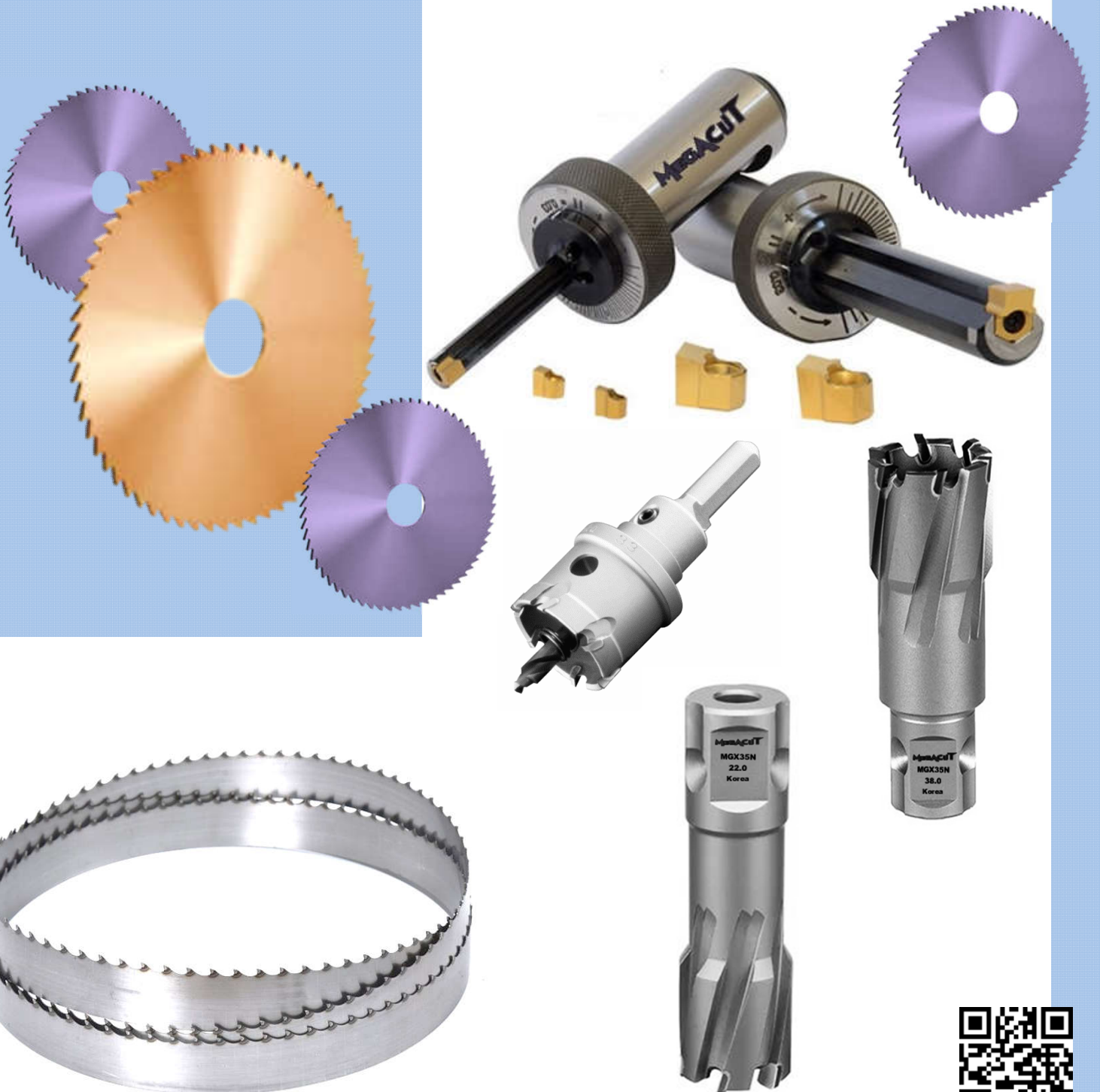



**MEGACUT**



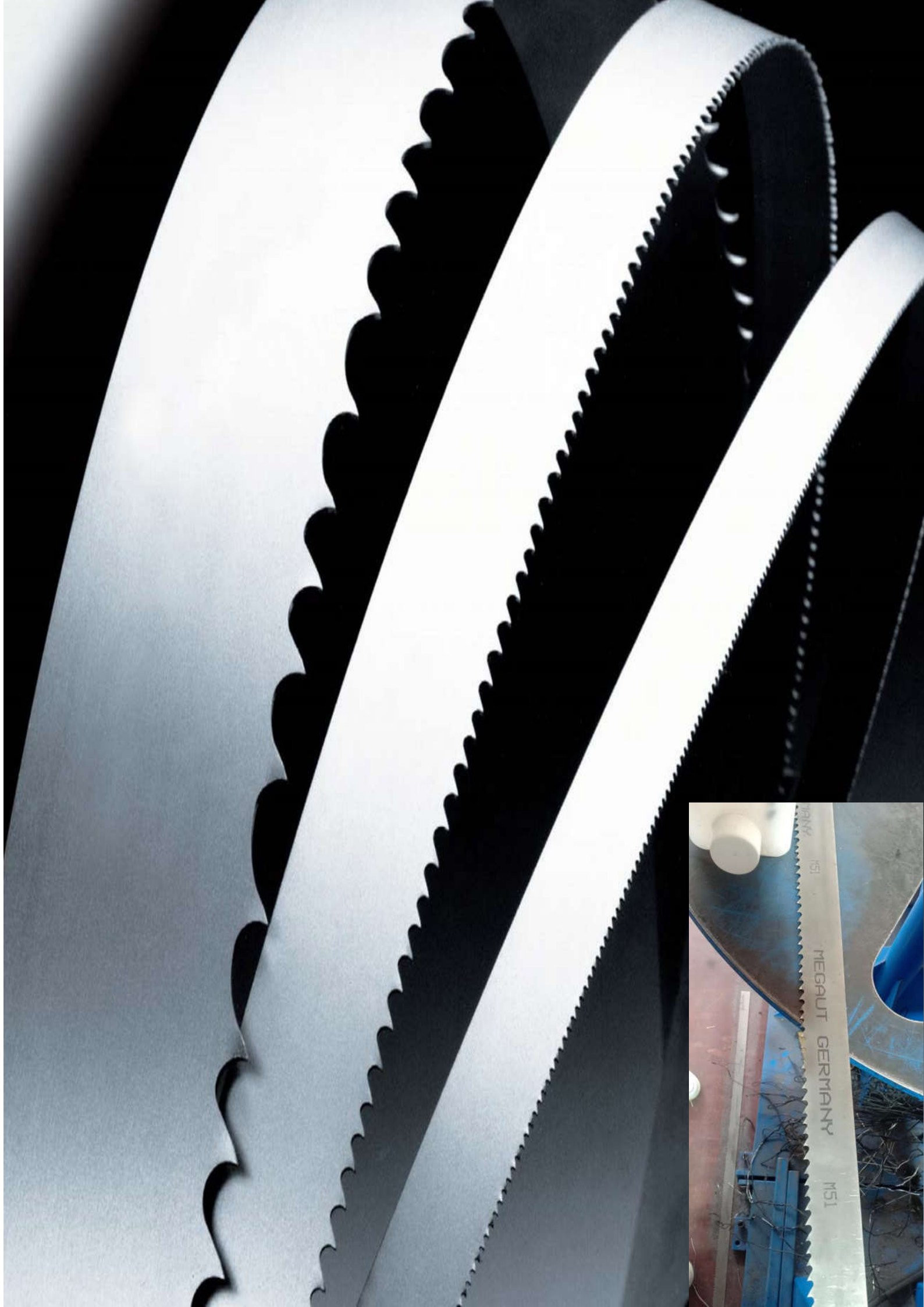

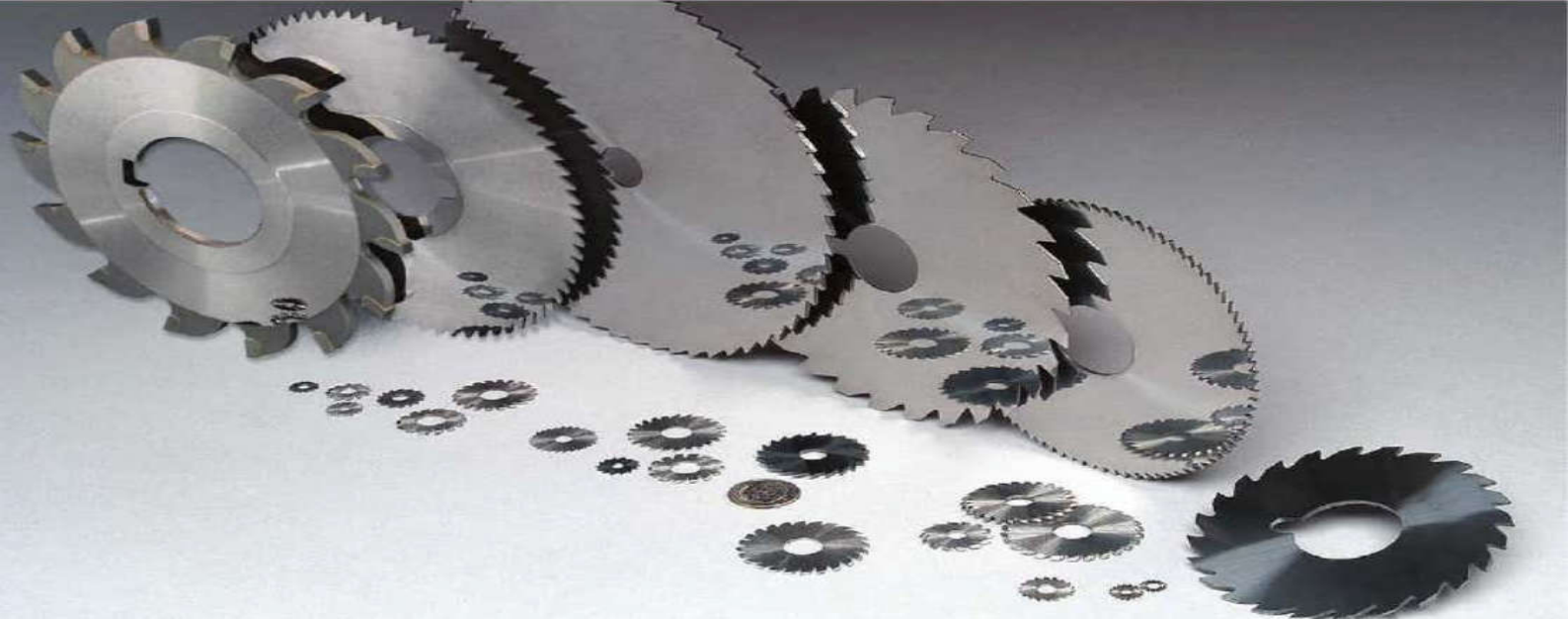



**Chiave di lettura catalogo** | Key to catalogue | Katalogsleseschlüssel | Légende  
 catalogue Leyenda del catálogo

02

## SEGHE CIRCOLARI CON DENTATURA FINE E GROSSA

CIRCULAR SAW BLADES WITH FINE AND COARSE TEETH | KREISSÄGEBLÄTTER FEIN UND GROSSVERZAHNT  
 FRAISES SCIES DENTURE FINE ET LARGE | SIERRAS CIRCULARES DENTADO FINO Y GRUESO

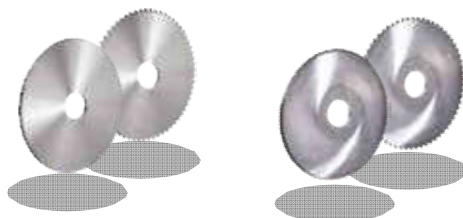

MGS01	HM	DIN 1837		03÷27
MGS02	HM	DIN 1838		03÷27
MGS03	HSS-Co5	DIN 1837		03÷27
MGS04	HSS-Co5	DIN 1838		03÷27

## SEGHE CIRCOLARI PER TRONCATRICI

CIRCULAR SAW BLADES FOR CUT-OFF MACHINES | MASCHINENKREISSÄGEBLÄTTER  
 FRAISES SCIES CIRCULAIRES POUR MACHINES A TRONCONNER | SIERRAS CIRCULARES PARA MÁQUINAS TRONZADORAS



MGS05	HSS-Co5			28
-------	---------	--	--	----

## GUIDA TECNICA

TECHNICAL GUIDE | TECHNISCHE DATEN | GUIDE TECHNIQUE | GUÍA TÉCNICA

**Parametri di taglio consigliati** | Cutting parameters suggested | Formule -  
 Calculation average chip thickness (hm) | Calculation average chip thickness (hm)

30-33

### RIVESTIMENTI E AFFILATURE SPECIALI A RICHIESTA

SPECIAL COATINGS AND SHARPENINGS ON REQUEST | BESCHICHTUNGEN UND SONDERSCHEIFEN AUF ANFRAGE  
 REVÊTÈMENTS ET AFFÛTAGES SPÉCIAUX SUR DEMANDE | RECUBRIMIENTOS Y AFILADOS ESPECIALES BAJO DEMANDA

## T.C.T. HOLE SAW



34-47

## BROACHING TOOL

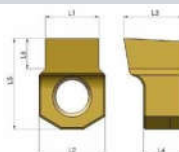

48-60

## BIMETAL BANDSAW BLADES



61



# CHIAVE DILETTURA CATALOGO

KEY TO CATALOGUE | KATALOGSLESESCHLÜSSEL  
LÉGENDE CATALOGUE | LEYENDA DELCATÁLOGO

10  
**SEGHE CIRCOLARI CON DENTATURA FINE E GROSSA**  
CIRCULAR SAW BLADES WITH FINE AND COARSE TEETH | KREISSÄGEBLÄTTER FEIN UND GROSSVERZAHNT  
FRAISES SCIÉS DENTURE FINE ET LARGE | SIERRAS CIRCULARES DENTADO FINO Y GRUESO

2 (HM) | 3 (HSS-Co5) | 4 (DIN 1837) | 5 (DIN 1838)

6

7

D x b	d <sub>1</sub>	d	MGS01		MGS02		MGS03		MGS04	
			DIN 1837	DIN 1838	DIN 1837	DIN 1838	DIN 1837	DIN 1838	DIN 1837	DIN 1838
			Z	HM	C	Z	C	Z	C	8
30X1.2	8	-	48	20	46,80	48	32	16,65		
30X1.3	8	-	48	20	48,60	-	-	-		
30X1.4	8	-	48	20	49,90	-	-	-		
30X1.5	8	-	48	20	51,10	48	32	17,55		
30X1.6	8	-	48	20	54,80	48	32	17,70		
30X1.7	8	-	48	20	54,80	-	-	-		
30X1.8	8	-	48	20	58,60	-	-	-		
30X1.9	8	-	48	20	60,40	-	-	-		
30X2	8	-	48	20	62,30	48	32	20,50		
30X2.5	8	-	40	20	70,40	40	24	23,05		
30X3	8	-	40	18	81,00	40	24	27,45		
30X3.5	8	-	-	-	-	40	24	32,65		
30X4	8	-	-	-	-	-	-	35,40		
30X5	8	-	-	-	-	-	-	-		

● **Tipologia utensile** | Tool type  
Werkzeugtyp | Typologie de l'outil  
Tipología herramienta

2 **(HM)** | **Metallo duro** | Solid carbide  
Vollhartmetall | Carbure monobloc  
Metal duro

3 **(HSS-Co5)** | **Acciaio super rapido**  
High speed steel | Hochleistungsschnittstahl  
Acier rapide | Acero rapido

4 **(DIN 1837)**  
**Seghe circolari con dentatura fine**  
Circular saw blades with fine teeth  
Kreissägeblätter feinverzahnt  
Fraises sciés denture fine  
Sierras circulares dentado fino

5 **(DIN 1838)**  
**Seghe circolari con dentatura grossa**  
Circular saw blades with coarse teeth  
Kreissägeblätter großverzahnt  
Fraises sciés denture large  
Sierras circulares dentado grueso

6 **Disegno tecnico** | Technical drawing  
Technische Zeichnung | Plan technique  
Dibujo técnico

7 **Quote dimensionali** | Dimensional quotes  
Abmessungen | Valeurs dimensionnelles  
Tamaño

8 **Codice prodotto** | Item code  
Katalognummer | Référence produit  
Código referencia

1 (D) | 2 (d) | 3 (d1) | 4 (b)

MGS01		MGS02		MGS	
DIN 1837	DIN 1838	DIN 1837	DIN 1838	DIN 18	DIN 18

1 **(D)** | **Diametro utensile** | Tool diameter  
Werkzeugsdurchmesser | Diamètre de l'outil  
Diametro de la herramienta

2 **(d)** | **Diametro mozzo** | Hub diameter  
Bund Durchmesser | Diamètre du moyeu  
Diametro del anillo

3 **(d<sub>1</sub>)** | **Diametro foro** | Central hole diameter  
Bohrung Durchmesser | Diamètre de l'alesage  
Diametro de l'eje

4 **(b)** | **Spessore utensile** | Tool thickness  
Werkzeugsbreite | Épaisseur de l'outil  
Espesor de la herramienta





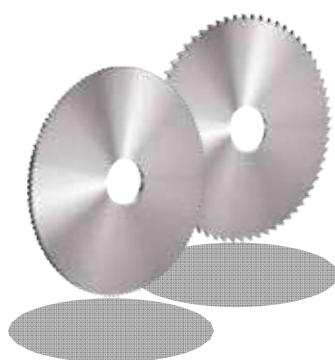
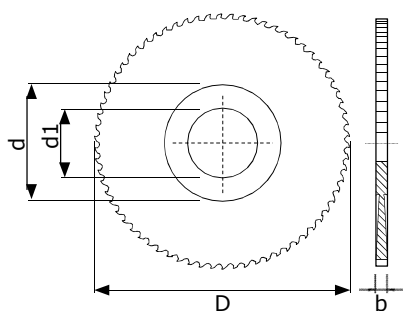

# SEGHE CIRCOLARI CON DENTATURA FINE E GROSSA

CIRCULAR SAW BLADES WITH FINE AND COARSE TEETH | KREISSÄGEBLÄTTER FEIN UND GROSSVERZAHNT  
 FRAISES SCIÉS DENTURE FINE ET LARGE | SIERRAS CIRCULARES DENTADO FINO Y GRUESO

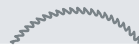
HM	HSS-Co5	DIN 1837	DIN 1838
----	---------	----------	----------

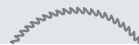

		*MGS03 *MGS04						
			<b>MGS01</b>	<b>MGS02</b>		<b>MGS03</b>	<b>MGS04</b>	
			DIN 1837	DIN 1838		DIN 1837	DIN 1838	
			HM			HSS-Co5		
<b>D x b</b>	d <sub>1</sub>	d	Z		€	Z		€

12X0.2	5	-	48	16	<b>22,40</b>	-	-	-
12X0.25	5	-	48	16	<b>22,40</b>	-	-	-
12X0.3	5	-	48	16	<b>22,40</b>	-	-	-
12X0.35	5	-	48	16	<b>23,30</b>	-	-	-
12X0.4	5	-	48	16	<b>23,30</b>	-	-	-
12X0.45	5	-	40	16	<b>23,30</b>	-	-	-
12X0.5	5	-	40	16	<b>24,10</b>	-	-	-
12X0.6	5	-	40	16	<b>25,80</b>	-	-	-
12X0.7	5	-	40	16	<b>28,30</b>	-	-	-
12X0.8	5	-	32	16	<b>28,30</b>	-	-	-
12X0.9	5	-	32	16	<b>29,05</b>	-	-	-
12X1	5	-	32	16	<b>30,70</b>	-	-	-
12X1.1	5	-	32	16	<b>30,70</b>	-	-	-
12X1.2	5	-	32	16	<b>32,40</b>	-	-	-
12X1.3	5	-	32	16	<b>32,40</b>	-	-	-
12X1.4	5	-	32	12	<b>34,00</b>	-	-	-
12X1.5	5	-	32	12	<b>35,65</b>	-	-	-
12X1.6	5	-	32	12	<b>37,40</b>	-	-	-

Esempio d'ordine | Ordering example | Bestellbeispiel | Exemple de commande | Ejemplo de pedido: **MGS01 - (D x b)**

\* Mozzo presente solo nelle seghe in HSS-Co5 | Hub present only in the HSS-Co5 saws | Bund ist nur in den HSS-Co5 Sägeblätter vorhanden | Epaulement présent seulement sur les fraises sciés en Hss-Co5 | Anillo presente solamente en las sierras in Hss Hss-Co5



# SEGHE CIRCOLARI CON DENTATURA FINE E GROSSA

CIRCULAR SAW BLADES WITH FINE AND COARSE TEETH | KREISSÄGEBLÄTTER FEIN UND GROSSVERZAHNT  
 FRAISES SCIÉS DENTURE FINE ET LARGE | SIERRAS CIRCULARES DENTADO FINO Y GRUESO

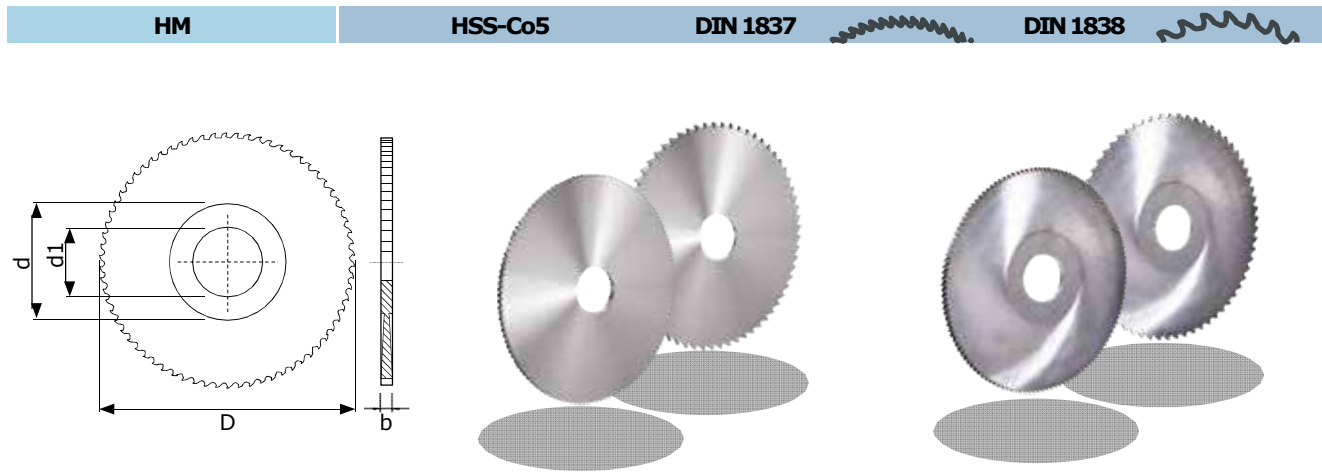

		*MGS03 *MGS04	HM		€	HSS-Co5		€
			MGS01 DIN 1837	MGS02 DIN 1838		MGS03 DIN 1837	MGS04 DIN 1838	
<b>D x b</b>	d <sub>1</sub>	d	Z			Z		

12X1.7	5	-	24	12	<b>39,00</b>	-	-	-
12X1.8	5	-	24	12	<b>40,70</b>	-	-	-
12X1.9	5	-	24	12	<b>40,70</b>	-	-	-
12X2	5	-	24	12	<b>42,30</b>	-	-	-
12X2.5	5	-	24	12	<b>57,30</b>	-	-	-
12X3	5	-	24	12	<b>64,00</b>	-	-	-
12X4	5	-	20	12	<b>90,60</b>	-	-	-
12X5	5	-	20	12	<b>107,00</b>	-	-	-
12X6	5	-	20	12	<b>132,50</b>	-	-	-

15X0.2	5	-	64	24	<b>23,30</b>	-	-	-
15X0.25	5	-	64	24	<b>23,30</b>	-	-	-
15X0.3	5	-	64	24	<b>23,30</b>	-	-	-
15X0.35	5	-	64	24	<b>24,10</b>	-	-	-
15X0.4	5	-	64	24	<b>24,10</b>	-	-	-
15X0.45	5	-	48	20	<b>24,10</b>	-	-	-
15X0.5	5	-	48	20	<b>24,90</b>	-	-	-
15X0.6	5	-	48	20	<b>26,60</b>	-	-	-

Esempio d'ordine | Ordering example | Bestellbeispiel | Exemple de commande | Ejemplo de pedido: **MGS01 - (D x b)**

\* Mozzo presente solo nelle seghe in HSS-Co5 | Hub present only in the HSS-Co5 saws | Bund ist nur in den HSS-Co5 Sägeblätter vorhanden | Epaulement présent seulement sur les fraises sciés en Hss-Co5 | Anillo presente solamente en las sierras en Hss Hss-Co5





# SEGHE CIRCOLARI CON DENTATURA FINE E GROSSA

CIRCULAR SAW BLADES WITH FINE AND COARSE TEETH | KREISSÄGEBLÄTTER FEIN UND GROSSVERZAHNT  
 FRAISES SCIES DENTURE FINE ET LARGE | SIERRAS CIRCULARES DENTADO FINO Y GRUESO

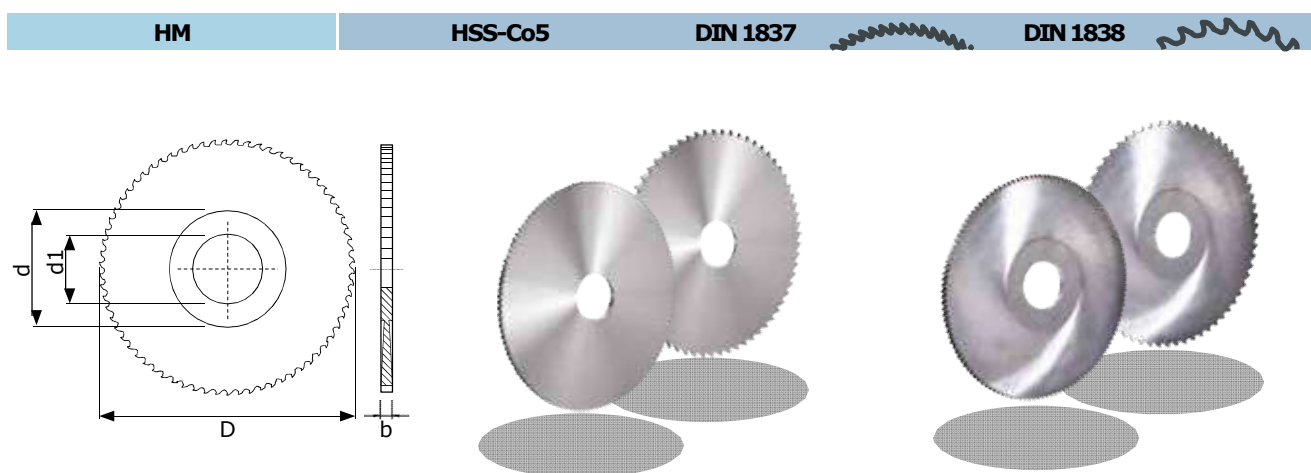

		*MGS03 *MGS04	HM		€	HSS-Co5		€
			MGS01 DIN 1837	MGS02 DIN 1838		MGS03 DIN 1837	MGS04 DIN 1838	
<b>D x b</b>	d <sub>1</sub>	d	Z			Z		

15X0.7	5	-	48	20	<b>29,05</b>	-	-	-
15X0.8	5	-	40	20	<b>29,05</b>	-	-	-
15X0.9	5	-	40	16	<b>29,95</b>	-	-	-
15X1	5	-	40	16	<b>31,50</b>	-	-	-
15X1.1	5	-	40	16	<b>31,50</b>	-	-	-
15X1.2	5	-	40	16	<b>33,20</b>	-	-	-
15X1.3	5	-	40	16	<b>33,20</b>	-	-	-
15X1.4	5	-	40	16	<b>34,90</b>	-	-	-
15X1.5	5	-	40	16	<b>36,60</b>	-	-	-
15X1.6	5	-	40	16	<b>38,20</b>	-	-	-
15X1.7	5	-	28	16	<b>39,85</b>	-	-	-
15X1.8	5	-	28	12	<b>41,60</b>	-	-	-
15X1.9	5	-	28	12	<b>41,60</b>	-	-	-
15X2	5	-	28	12	<b>43,30</b>	-	-	-
15X2.5	5	-	28	12	<b>58,20</b>	-	-	-
15X3	5	-	28	12	<b>64,80</b>	-	-	-
15X4	5	-	24	12	<b>91,40</b>	-	-	-
15X5	5	-	24	12	<b>108,00</b>	-	-	-
15X6	5	-	24	12	<b>133,00</b>	-	-	-

Esempio d'ordine | Ordering example | Bestellbeispiel | Exemple de commande | Ejemplo de pedido: **MGS01 - (D x b)**

\*Mozzo presente solo nelle seghe in HSS-Co5 | Hub present only in the HSS-Co5 saws | Bund ist nur in den HSS-Co5 Sägeblätter vorhanden  
 Epaulement présent seulement sur les fraises scies en Hss-Co5 | Anillo presente solamente en las sierras en Hss Hss-Co5



# SEGHE CIRCOLARI CON DENTATURA FINE E GROSSA

CIRCULAR SAW BLADES WITH FINE AND COARSE TEETH | KREISSÄGEBLÄTTER FEIN UND GROSSVERZAHNT  
 FRAISES SCIÉS DENTURE FINE ET LARGE | SIERRAS CIRCULARES DENTADO FINO Y GRUESO

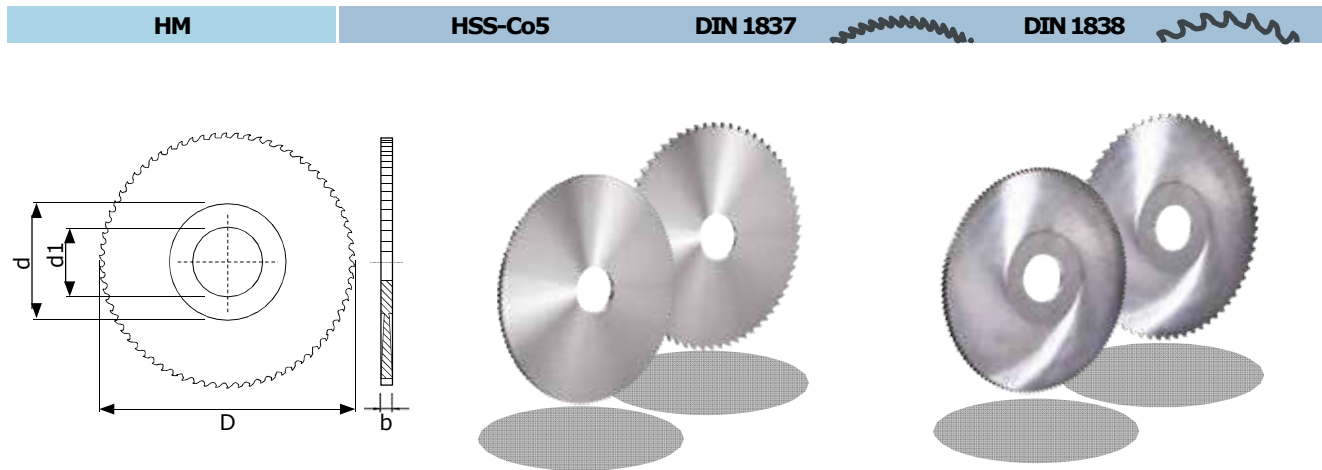

		*MGS03 *MGS04	HM		€	HSS-Co5		€
			MGS01 DIN 1837	MGS02 DIN 1838		MGS03 DIN 1837	MGS04 DIN 1838	
<b>D x b</b>	d <sub>1</sub>	d	Z			Z		
20X0.2	5	-	80	32	<b>26,60</b>	-	-	-
20X0.25	5	-	64	32	<b>24,90</b>	-	-	-
20X0.3	5	10	64	32	<b>26,60</b>	64	-	<b>19,55</b>
20X0.35	5	-	64	32	<b>27,40</b>	-	-	-
20X0.4	5	10	64	32	<b>27,40</b>	64	-	<b>19,55</b>
20X0.45	5	-	48	24	<b>28,30</b>	-	-	-
20X0.5	5	10	48	24	<b>29,05</b>	48	-	<b>18,00</b>
20X0.6	5	10	48	24	<b>29,95</b>	48	-	<b>18,70</b>
20X0.7	5	-	48	24	<b>32,40</b>	-	-	-
20X0.8	5	10	40	24	<b>34,00</b>	48	-	<b>17,75</b>
20X0.9	5	-	40	20	<b>37,40</b>	-	-	-
20X1	5	10	40	20	<b>38,20</b>	40	-	<b>18,10</b>
20X1.1	5	-	40	20	<b>39,00</b>	-	-	-
20X1.2	5	10	40	20	<b>39,85</b>	40	-	<b>19,60</b>
20X1.3	5	-	40	20	<b>42,30</b>	-	-	-
20X1.4	5	-	40	20	<b>44,00</b>	-	-	-

Esempio d'ordine | Ordering example | Bestellbeispiel | Exemple de commande | Ejemplo de pedido: **MGS01 - (D x b)**

\* Mozzo presente solo nelle seghe in HSS-Co5 | Hub present only in the HSS-Co5 saws | Bund ist nur in den HSS-Co5 Sägeblätter vorhanden | Epaulement présent seulement sur les fraises sciés en Hss-Co5 | Anillo presente solamente en las sierras en Hss Hss-Co5





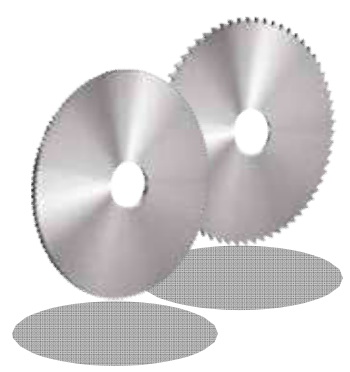
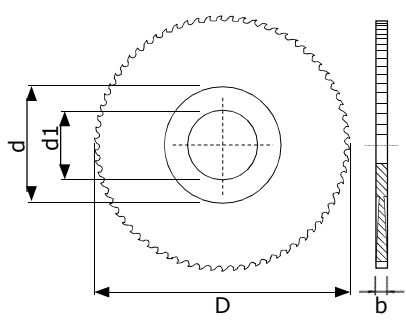

# SEGHE CIRCOLARI CON DENTATURA FINE E GROSSA

CIRCULAR SAW BLADES WITH FINE AND COARSE TEETH | KREISSÄGEBLÄTTER FEIN UND GROSSVERZAHNT  
 FRAISES SCIÉS DENTURE FINE ET LARGE | SIERRAS CIRCULARES DENTADO FINO Y GRUESO

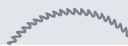
HM	HSS-Co5	DIN 1837		DIN 1838	
----	---------	----------	--	----------	---

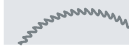

		*MGS03 *MGS04						
			<b>MGS01</b>	<b>MGS02</b>		<b>MGS03</b>	<b>MGS04</b>	
			DIN 1837	DIN 1838		DIN 1837	DIN 1838	
			HM			HSS-Co5		
<b>D x b</b>	d <sub>1</sub>	d	Z		€	Z		€

20X1.5	5	-	40	20	<b>44,00</b>	-	-	-
20X1.6	5	10	40	20	<b>46,50</b>	40	-	<b>20,85</b>
20X1.7	5	-	32	20	<b>48,20</b>	-	-	-
20X1.8	5	-	32	16	<b>48,20</b>	-	-	-
20X1.9	5	-	32	16	<b>49,80</b>	-	-	-
20X2	5	10	32	16	<b>49,80</b>	32	-	<b>22,15</b>
20X2.5	5	10	32	16	<b>62,30</b>	32	-	<b>29,55</b>
20X3	5	10	32	16	<b>69,80</b>	32	-	<b>29,75</b>
20X4	5	10	24	16	<b>93,80</b>	24	-	<b>37,40</b>
20X5	5	10	24	16	<b>116,00</b>	24	-	<b>44,80</b>
20X6	5	10	24	16	<b>136,00</b>	24	-	<b>50,80</b>

25X0.2	8	-	80	32	<b>29,05</b>	-	-	-
25X0.25	8	-	80	32	<b>28,30</b>	-	-	-
25X0.3	8	-	80	32	<b>29,05</b>	80	-	<b>15,55</b>
25X0.35	8	-	64	32	<b>29,95</b>	-	-	-
25X0.4	8	-	64	32	<b>29,95</b>	64	-	<b>15,55</b>
25X0.45	8	-	64	24	<b>32,40</b>	-	-	-

Esempio d'ordine | Ordering example | Bestellbeispiel | Exemple de commande | Ejemplo de pedido: **MGS01 - (D x b)**

\* Mozzo presente solo nelle seghe in HSS-Co5 | Hub present only in the HSS-Co5 saws | Bund ist nur in den HSS-Co5 Sägeblätter vorhanden | Epaulement présent seulement sur les fraises sciés en Hss-Co5 | Anillo presente solamente en las sierras in Hss Hss-Co5





# SEGHE CIRCOLARI CON DENTATURA FINE E GROSSA

CIRCULAR SAW BLADES WITH FINE AND COARSE TEETH | KREISSÄGEBLÄTTER FEIN UND GROSSVERZAHNT  
 FRAISES SCIES DENTURE FINE ET LARGE | SIERRAS CIRCULARES DENTADO FINO Y GRUESO

HM	HSS-Co5	DIN 1837	DIN 1838
----	---------	----------	----------

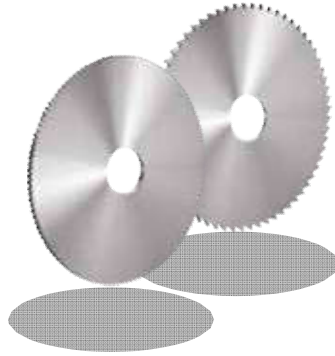
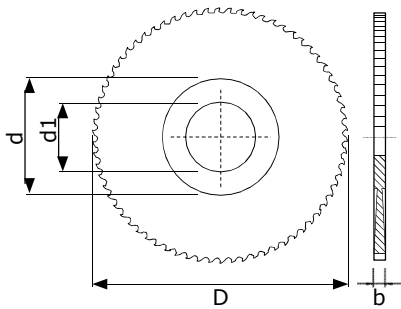

D x b	d <sub>1</sub>	d	HM		HSS-Co5		Z	€
			MGS01 DIN 1837	MGS02 DIN 1838	MGS03 DIN 1837	MGS04 DIN 1838		

25X0.5	8	-	64	24	<b>33,20</b>	64	-	<b>15,55</b>
25X0.6	8	-	64	24	<b>34,90</b>	64	-	<b>15,55</b>
25X0.7	8	-	48	24	<b>38,20</b>	64	-	<b>15,45</b>
25X0.8	8	-	48	24	<b>41,60</b>	48	-	<b>15,90</b>
25X0.9	8	-	48	20	<b>42,30</b>	-	-	-
25X1	8	-	48	20	<b>44,00</b>	48	-	<b>15,90</b>
25X1.1	8	-	48	20	<b>48,20</b>	-	-	-
25X1.2	8	-	48	20	<b>49,80</b>	48	-	<b>16,65</b>
25X1.3	8	-	40	20	<b>52,30</b>	-	-	-
25X1.4	8	-	40	20	<b>54,80</b>	-	-	-
25X1.5	8	-	40	20	<b>56,40</b>	40	-	<b>17,50</b>
25X1.6	8	-	40	20	<b>58,20</b>	40	-	<b>17,50</b>
25X1.7	8	-	40	20	<b>59,10</b>	-	-	-
25X1.8	8	-	40	16	<b>62,30</b>	-	-	-
25X1.9	8	-	40	16	<b>66,40</b>	-	-	-
25X2	8	-	40	16	<b>68,20</b>	40	-	<b>20,25</b>
25X2.5	8	-	40	16	<b>82,10</b>	40	-	<b>22,85</b>
25X3	8	-	32	16	<b>99,60</b>	32	-	<b>27,20</b>
25X3.5	8	-	-	-	-	32	-	<b>32,40</b>
25X4	8	-	32	16	<b>124,50</b>	32	-	<b>35,85</b>
25X5	8	-	32	16	<b>150,00</b>	32	-	<b>39,80</b>
25X6	8	-	32	16	<b>183,50</b>	24	-	<b>43,70</b>

Esempio d'ordine | Ordering example | Bestellbeispiel | Exemple de commande | Ejemplo de pedido: **MGS01 - (D x b)**

\* Mozzo presente solo nelle seghe in HSS-Co5 | Hub present only in the HSS-Co5 saws | Bund ist nur in den HSS-Co5 Sägeblätter vorhanden  
 Epaulement présent seulement sur les fraises scies en Hss-Co5 | Anillo presente solamente en las sierras en Hss Hss-Co5



# SEGHE CIRCOLARI CON DENTATURA FINE E GROSSA

CIRCULAR SAW BLADES WITH FINE AND COARSE TEETH | KREISSÄGEBLÄTTER FEIN UND GROSSVERZAHNT  
FRAISES SCIÉS DENTURE FINE ET LARGE | SIERRAS CIRCULARES DENTADO FINO Y GRUESO

HM	HSS-Co5	DIN 1837	DIN 1838
----	---------	----------	----------

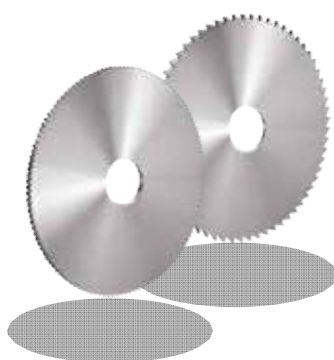
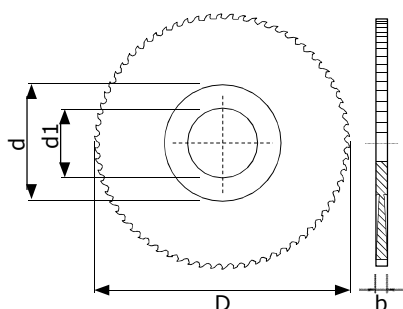

D x b	d <sub>1</sub>	d	HM		€	HSS-Co5		€
			Z	Z		Z	Z	
30X0.2	8	-	100	32	28,05	-	-	-
30X0.25	8	-	100	32	28,05	-	-	-
30X0.3	8	-	80	32	27,40	80	40	15,60
30X0.35	8	-	80	32	28,70	-	-	-
30X0.4	8	-	80	32	28,70	80	40	15,60
30X0.45	8	-	80	24	28,70	-	-	-
30X0.5	8	-	80	24	28,70	80	40	15,60
30X0.6	8	-	64	24	31,15	64	40	15,60
30X0.7	8	-	64	24	33,60	64	40	15,10
30X0.8	8	-	64	24	37,40	64	40	15,95
30X0.9	8	-	64	20	39,90	-	-	-
30X1	8	-	64	20	39,90	64	40	15,95
30X1.1	8	-	48	20	44,80	-	-	-
30X1.2	8	-	48	20	46,80	48	32	16,65
30X1.3	8	-	48	20	48,60	-	-	-
30X1.4	8	-	48	20	49,90	-	-	-
30X1.5	8	-	48	20	51,10	48	32	17,55
30X1.6	8	-	48	20	54,80	48	32	17,70
30X1.7	8	-	48	20	54,80	-	-	-
30X1.8	8	-	48	20	58,60	-	-	-
30X1.9	8	-	48	20	60,40	-	-	-

Esempio d'ordine | Ordering example | Bestellbeispiel | Exemple de commande | Ejemplo de pedido: **MGS01 - (D x b)**

Ordine minimo 20 pezzi | Minimum order q.ty 20 pièces | Mindestbestellmenge 20 Stück | Minimum de commande 20 pièces  
Cantidad minima de pedido 20 uds

\* Mozzo presente solo nelle seghe in HSS-Co5 | Hub present only in the HSS-Co5 saws | Bund ist nur in den HSS-Co5 Sägeblätter vorhanden | Epaulement présent seulement sur les fraises sciés en Hss-Co5 | Anillo presente solamente en las sierras in Hss Hss-Co5



# SEGHE CIRCOLARI CON DENTATURA FINE E GROSSA

CIRCULAR SAW BLADES WITH FINE AND COARSE TEETH | KREISSÄGEBLÄTTER FEIN UND GROSSVERZAHNT  
 FRAISES SCIÉS DENTURE FINE ET LARGE | SIERRAS CIRCULARES DENTADO FINO Y GRUESO

HM	HSS-Co5	DIN 1837	DIN 1838
----	---------	----------	----------

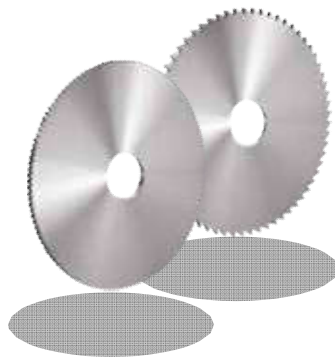
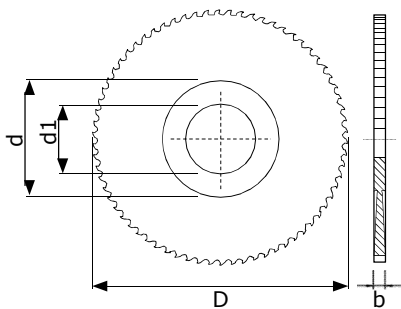

D x b	d <sub>1</sub>	d	HM			HSS-Co5		
			Z	€	Z	€		
30X2	8	-	48	20	62,30	48	32	20,50
30X2.5	8	-	40	20	70,40	40	24	23,05
30X3	8	-	40	18	81,00	40	24	27,45
30X3.5	8	-	-	-	-	40	24	32,65
30X4	8	-	40	18	106,00	40	24	35,40
30X5	8	-	32	18	124,50	32	18	39,30
30X6	8	-	32	18	150,00	32	18	42,10
32X0.2	8	-	100	32	35,50	-	-	-
32X0.25	8	-	100	32	35,50	-	-	-
32X0.3	8	-	80	32	34,90	80	40	15,60
32X0.35	8	-	80	32	36,15	-	-	-
32X0.4	8	-	80	32	36,15	80	40	15,60
32X0.45	8	-	80	24	36,15	-	-	-
32X0.5	8	-	80	24	36,15	80	40	15,60
32X0.6	8	-	64	24	38,60	64	40	15,60
32X0.7	8	-	64	24	41,10	64	40	15,10
32X0.8	8	-	64	24	44,80	64	40	15,95
32X0.9	8	-	64	24	47,30	-	-	-

Esempio d'ordine | Ordering example | Bestellbeispiel | Exemple de commande | Ejemplo de pedido: **MGS01 - (D x b)**

**Ordine minimo 10 pezzi** | Minimum order q.ty 10 pièces | Mindestbestellmenge 10 Stück | Minimum de commande 10 pièces | Cantidad mínima de pedido 10 uds

**Ordine minimo 20 pezzi** | Minimum order q.ty 20 pièces | Mindestbestellmenge 20 Stück | Minimum de commande 20 pièces | Cantidad mínima de pedido 20 uds

\* Mozzo presente solo nelle seghe in HSS-Co5 | Hub present only in the HSS-Co5 saws | Bund ist nur in den HSS-Co5 Sägeblätter vorhanden | Epaulement présent seulement sur les fraises sciés en Hss-Co5 | Anillo presente solamente en las sierras en Hss Hss-Co5





# SEGHE CIRCOLARI CON DENTATURA FINE E GROSSA

CIRCULAR SAW BLADES WITH FINE AND COARSE TEETH | KREISSÄGEBLÄTTER FEIN UND GROSSVERZAHNT  
 FRAISES SCIÉS DENTURE FINE ET LARGE | SIERRAS CIRCULARES DENTADO FINO Y GRUESO

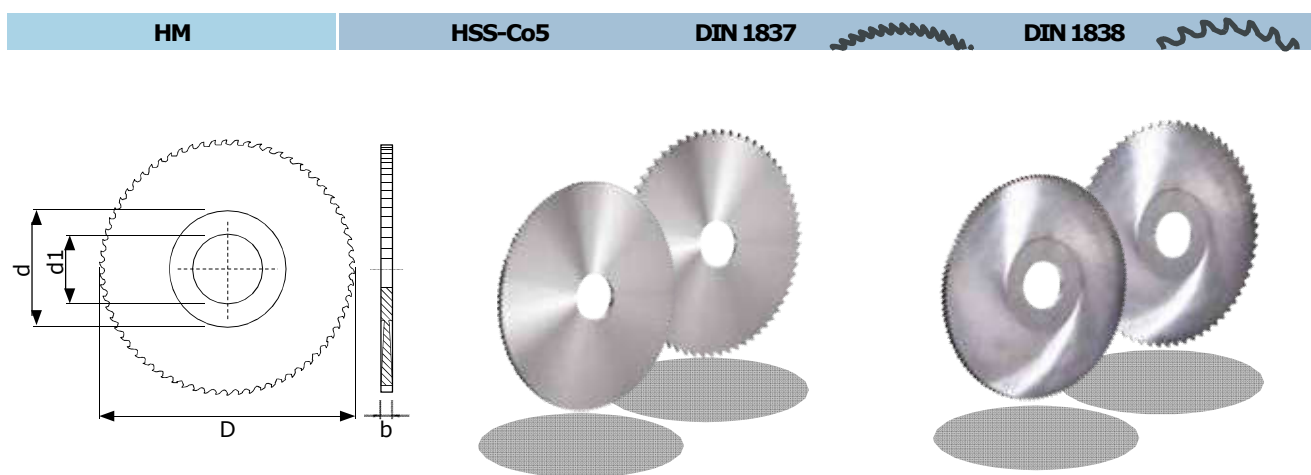

		*MGS03 *MGS04	HM		€	HSS-Co5		€
			MGS01 DIN 1837	MGS02 DIN 1838		MGS03 DIN 1837	MGS04 DIN 1838	
<b>D x b</b>	d <sub>1</sub>	d	Z			Z		

32X1	8	-	64	24	<b>47,30</b>	64	40	<b>15,95</b>
32X1.1	8	-	48	24	<b>52,30</b>	-	-	-
32X1.2	8	-	48	24	<b>54,20</b>	48	32	<b>16,70</b>
32X1.3	8	-	48	20	<b>56,10</b>	-	-	-
32X1.4	8	-	48	20	<b>57,30</b>	-	-	-
32X1.5	8	-	48	20	<b>58,60</b>	48	32	<b>17,70</b>
32X1.6	8	-	48	20	<b>62,30</b>	48	32	<b>17,70</b>
32X1.7	8	-	48	20	<b>62,30</b>	-	-	-
32X1.8	8	-	48	20	<b>66,00</b>	-	-	-
32X1.9	8	-	48	20	<b>68,00</b>	-	-	-
32X2	8	-	48	20	<b>69,80</b>	48	32	<b>20,50</b>
32X2.5	8	-	40	20	<b>77,90</b>	40	24	<b>23,05</b>
32X3	8	-	40	20	<b>88,40</b>	40	24	<b>27,45</b>
32X3.5	8	-	-	-	-	40	24	<b>32,65</b>
32X4	8	-	40	18	<b>113,50</b>	40	24	<b>35,40</b>
32X5	8	-	32	18	<b>132,50</b>	32	18	<b>39,30</b>
32X6	8	-	32	18	<b>157,50</b>	32	18	<b>42,10</b>

Esempio d'ordine | Ordering example | Bestellbeispiel | Exemple de commande | Ejemplo de pedido: **MGS01 - (D x b)**

Ordine minimo 20 pezzi | Minimum order q.ty 20 pièces | Mindestbestellmenge 20 Stück | Minimum de commande 20 pièces | Cantidad minima de pedido 20 uds

\* Mozzo presente solo nelle seghe in HSS-Co5 | Hub present only in the HSS-Co5 saws | Bund ist nur in den HSS-Co5 Sägeblätter vorhanden | Epaulement présent seulement sur les fraises sciés en Hss-Co5 | Anillo presente solamente en las sierras in Hss Hss-Co5



# SEGHE CIRCOLARI CON DENTATURA FINE E GROSSA

CIRCULAR SAW BLADES WITH FINE AND COARSE TEETH | KREISSÄGEBLÄTTER FEIN UND GROSSVERZAHNT  
 FRAISES SCIÉS DENTURE FINE ET LARGE | SIERRAS CIRCULARES DENTADO FINO Y GRUESO

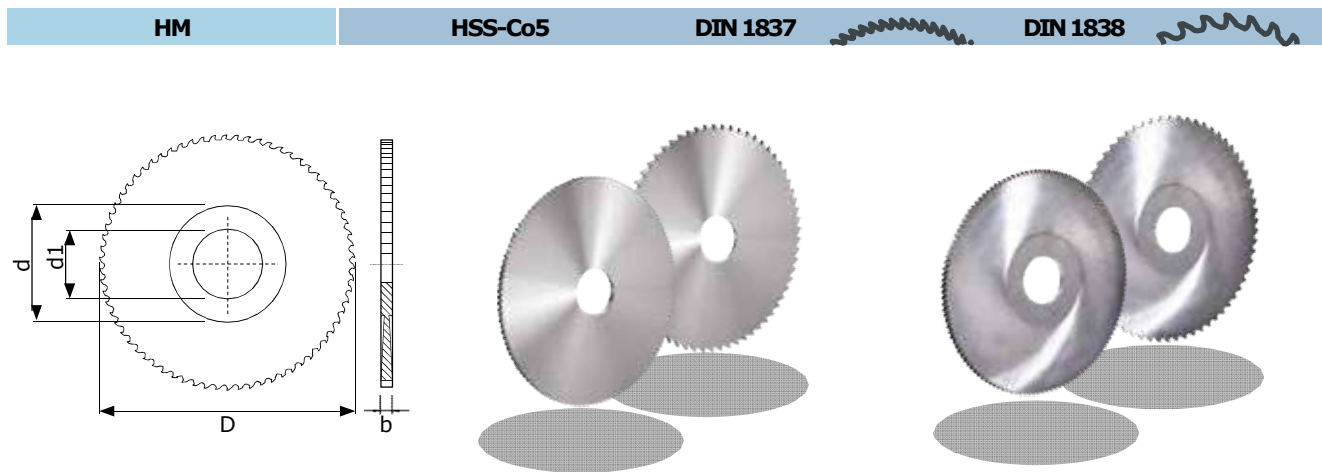

		*MGS03 *MGS04	HM		€	HSS-Co5		€
			MGS01	MGS02		MGS03	MGS04	
			DIN 1837	DIN 1838		DIN 1837	DIN 1838	
<b>D x b</b>	d <sub>1</sub>	d	Z			Z		
40X0.2	10	-	128	48	<b>39,90</b>	-	-	-
40X0.25	10	-	100	48	<b>37,40</b>	-	-	-
40X0.3	10	18	100	48	<b>36,15</b>	100	44	<b>17,80</b>
40X0.35	10	-	100	48	<b>36,75</b>	-	-	-
40X0.4	10	18	100	48	<b>36,75</b>	100	44	<b>17,80</b>
40X0.45	10	-	80	40	<b>37,40</b>	-	-	-
40X0.5	10	18	80	40	<b>39,90</b>	80	44	<b>17,65</b>
40X0.6	10	18	80	40	<b>41,10</b>	80	44	<b>17,65</b>
40X0.7	10	18	80	40	<b>44,80</b>	80	44	<b>17,65</b>
40X0.8	10	18	80	40	<b>46,80</b>	80	44	<b>16,85</b>
40X0.9	10	-	64	32	<b>47,90</b>	-	-	-
40X1	10	18	64	32	<b>51,10</b>	64	44	<b>16,85</b>
40X1.1	10	-	64	32	<b>51,10</b>	-	-	-
40X1.2	10	18	64	32	<b>51,70</b>	64	36	<b>18,20</b>
40X1.3	10	-	64	32	<b>52,30</b>	-	-	-
40X1.4	10	-	64	32	<b>54,80</b>	-	-	-
40X1.5	10	18	64	32	<b>56,70</b>	64	36	<b>19,10</b>
40X1.6	10	18	64	32	<b>58,60</b>	64	36	<b>19,10</b>

Esempio d'ordine | Ordering example | Bestellbeispiel | Exemple de commande | Ejemplo de pedido: **MGS01 - (D x b)**

**Ordine minimo 10 pezzi** | Minimum order q.ty 10 pièces | Mindestbestellmenge 10 Stück | Minimum de commande 10 pièces | Cantidad mínima de pedido 10 uds

\* Mozzo presente solo nelle seghe in HSS-Co5 | Hub present only in the HSS-Co5 saws | Bund ist nur in den HSS-Co5 Sägeblätter vorhanden | Epaulement présent seulement sur les fraises sciés en Hss-Co5 | Anillo presente solamente en las sierras en Hss Hss-Co5



# SEGHE CIRCOLARI CON DENTATURA FINE E GROSSA

CIRCULAR SAW BLADES WITH FINE AND COARSE TEETH | KREISSÄGEBLÄTTER FEIN UND GROSSVERZAHNT  
 FRAISES SCIÉS DENTURE FINE ET LARGE | SIERRAS CIRCULARES DENTADO FINO Y GRUESO

HM	HSS-Co5	DIN 1837	DIN 1838
----	---------	----------	----------

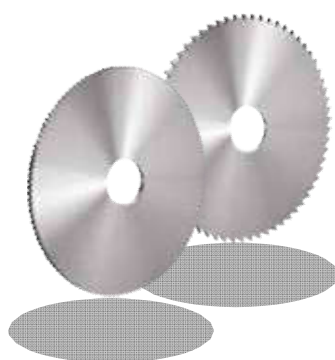
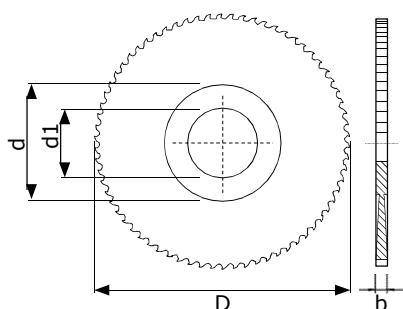

		*MGS03 *MGS04	HM		HSS-Co5			
			MGS01 DIN 1837	MGS02 DIN 1838	MGS03 DIN 1837	MGS04 DIN 1838	Z	€
<b>D x b</b>	d <sub>1</sub>	d	Z		€	Z		€
40X1.7	10	-	48	32	<b>61,70</b>	-	-	-
40X1.8	10	-	48	24	<b>63,50</b>	-	-	-
40X1.9	10	-	48	24	<b>63,50</b>	-	-	-
40X2	10	18	48	24	<b>65,40</b>	48	36	<b>21,80</b>
40X2.5	10	18	48	24	<b>84,60</b>	48	28	<b>23,95</b>
40X3	10	18	48	24	<b>95,90</b>	48	28	<b>28,35</b>
40X3.5	10	18	-	-	-	40	28	<b>31,55</b>
40X4	10	18	40	20	<b>118,50</b>	40	28	<b>36,05</b>
40X5	10	18	40	20	<b>142,50</b>	40	20	<b>43,90</b>
40X6	10	18	40	20	<b>168,50</b>	40	20	<b>47,80</b>

Esempio d'ordine | Ordering example | Bestellbeispiel | Exemple de commande | Ejemplo de pedido: **MGS01 - (D x b)**

**Ordine minimo 10 pezzi** | Minimum order q.ty 10 pièces | Mindestbestellmenge 10 Stück | Minimum de commande 10 pièces | Cantidad mínima de pedido 10 uds

\* Mozzo presente solo nelle seghe in HSS-Co5 | Hub present only in the HSS-Co5 saws | Bund ist nur in den HSS-Co5 Sägeblätter vorhanden | Epaulement présent seulement sur les fraises sciés en Hss-Co5 | Anillo presente solamente en las sierras en Hss Hss-Co5





# SEGHE CIRCOLARI CON DENTATURA FINE E GROSSA

CIRCULAR SAW BLADES WITH FINE AND COARSE TEETH | KREISSÄGEBLÄTTER FEIN UND GROSSVERZAHNT  
 FRAISES SCIES DENTURE FINE ET LARGE | SIERRAS CIRCULARES DENTADO FINO Y GRUESO

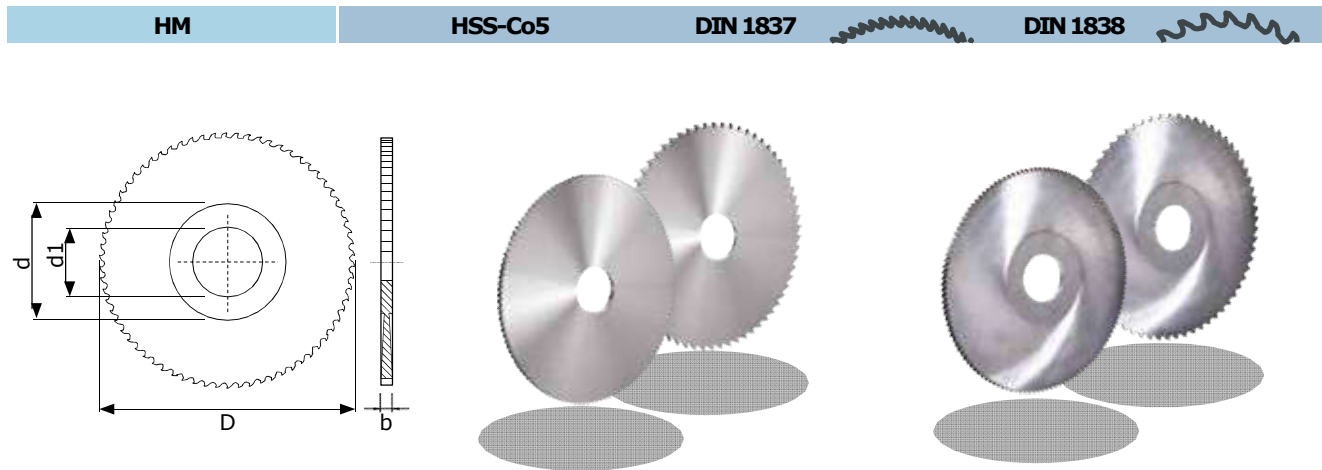

D x b	d <sub>1</sub>	d	HM		€	HSS-Co5		€
			MGS01 DIN 1837	MGS02 DIN 1838		MGS03 DIN 1837	MGS04 DIN 1838	
50X0.2	13	-	128	48	<b>56,70</b>	-	-	-
50X0.25	13	-	128	48	<b>54,20</b>	-	-	-
50X0.3	13	25	128	48	<b>48,60</b>	128	48	<b>21,05</b>
50X0.35	13	-	100	48	<b>48,60</b>	-	-	-
50X0.4	13	25	100	48	<b>47,30</b>	100	48	<b>21,05</b>
50X0.45	13	-	100	48	<b>48,60</b>	-	-	-
50X0.5	13	25	100	48	<b>48,60</b>	100	48	<b>21,05</b>
50X0.6	13	25	100	48	<b>48,60</b>	100	48	<b>21,05</b>
50X0.7	13	25	80	40	<b>50,40</b>	80	48	<b>19,10</b>
50X0.8	13	25	80	40	<b>52,90</b>	80	40	<b>19,10</b>
50X0.9	13	-	80	40	<b>55,40</b>	-	-	-
50X1	13	25	80	40	<b>56,70</b>	80	40	<b>19,10</b>
50X1.1	13	-	80	40	<b>58,60</b>	-	-	-
50X1.2	13	25	80	40	<b>59,80</b>	80	40	<b>20,60</b>
50X1.3	13	-	64	32	<b>66,70</b>	-	-	-
50X1.4	13	-	64	32	<b>69,80</b>	-	-	-

Esempio d'ordine | Ordering example | Bestellbeispiel | Exemple de commande | Ejemplo de pedido: **MGS01 - (D x b)**

\* Mozzo presente solo nelle seghe in HSS-Co5 | Hub present only in the HSS-Co5 saws | Bund ist nur in den HSS-Co5 Sägeblätter vorhanden  
 Epaulement présent seulement sur les fraises scies en Hss-Co5 | Anillo presente solamente en las sierras en Hss Hss-Co5



# SEGHE CIRCOLARI CON DENTATURA FINE E GROSSA

CIRCULAR SAW BLADES WITH FINE AND COARSE TEETH | KREISSÄGEBLÄTTER FEIN UND GROSSVERZAHNT  
 FRAISES SCIES DENTURE FINE ET LARGE | SIERRAS CIRCULARES DENTADO FINO Y GRUESO

HM	HSS-Co5	DIN 1837	DIN 1838
----	---------	----------	----------

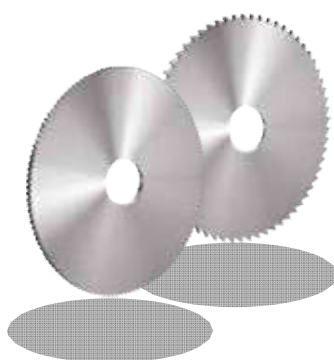
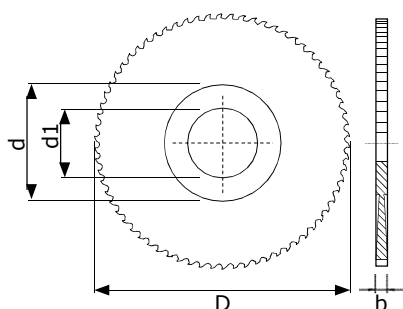

		*MGS03 *MGS04	HM		HSS-Co5		Z	€
			MGS01 DIN 1837	MGS02 DIN 1838	MGS03 DIN 1837	MGS04 DIN 1838		
<b>D x b</b>	d <sub>1</sub>	d	HM		HSS-Co5		Z	€

50X1.5	13	25	64	32	<b>71,70</b>	64	40	<b>21,80</b>
50X1.6	13	25	64	32	<b>73,50</b>	64	32	<b>21,80</b>
50X1.7	13	-	64	32	<b>74,70</b>	-	-	-
50X1.8	13	-	64	32	<b>79,20</b>	-	-	-
50X1.9	13	-	64	32	<b>79,20</b>	-	-	-
50X2	13	25	64	32	<b>82,10</b>	64	32	<b>23,80</b>
50X2.5	13	25	64	32	<b>100,50</b>	64	32	<b>30,55</b>
50X3	13	25	48	24	<b>115,50</b>	48	24	<b>31,85</b>
50X3.5	13	25	-	-	-	48	24	<b>37,35</b>
50X4	13	25	48	24	<b>140,00</b>	48	24	<b>41,20</b>
50X5	13	25	48	24	<b>172,50</b>	48	24	<b>48,90</b>
50X6	13	25	40	20	<b>198,50</b>	40	20	<b>52,80</b>

Esempio d'ordine | Ordering example | Bestellbeispiel | Exemple de commande | Ejemplo de pedido: **MGS01 - (D x b)**

\* Mozzo presente solo nelle seghe in HSS-Co5 | Hub present only in the HSS-Co5 saws | Bund ist nur in den HSS-Co5 Sägeblätter vorhanden  
 Epaulement présent seulement sur les fraises scies en Hss-Co5 | Anillo presente solamente en las sierras en Hss Hss-Co5



# SEGHE CIRCOLARI CON DENTATURA FINE E GROSSA

CIRCULAR SAW BLADES WITH FINE AND COARSE TEETH | KREISSÄGEBLÄTTER FEIN UND GROSSVERZAHNT  
 FRAISES SCIES DENTURE FINE ET LARGE | SIERRAS CIRCULARES DENTADO FINO Y GRUESO

HM	HSS-Co5	DIN 1837	DIN 1838
----	---------	----------	----------

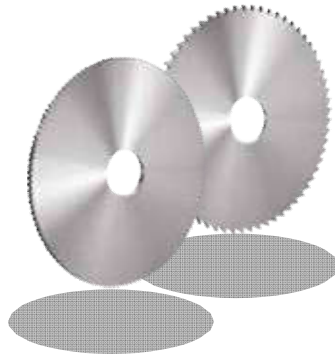
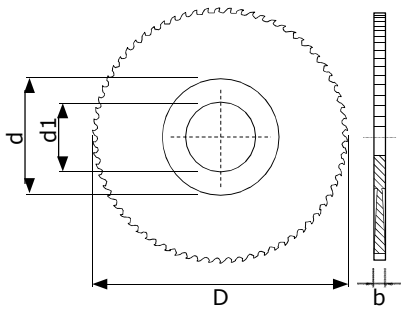

D x b	d <sub>1</sub>	d	HM		HSS-Co5		Z	€
			MGS01 DIN 1837	MGS02 DIN 1838	MGS03 DIN 1837	MGS04 DIN 1838		

63X0.2	16	-	160	64	<b>74,70</b>	-	-	-
63X0.25	16	-	128	64	<b>74,70</b>	-	-	-
63X0.3	16	32	128	64	<b>74,70</b>	128	-	<b>23,45</b>
63X0.35	16	-	128	64	<b>66,00</b>	-	-	-
63X0.4	16	32	128	64	<b>66,00</b>	128	64	<b>23,45</b>
63X0.45	16	-	128	64	<b>63,50</b>	-	-	-
63X0.5	16	32	128	64	<b>63,50</b>	128	64	<b>23,45</b>
63X0.6	16	32	100	48	<b>67,30</b>	100	48	<b>23,45</b>
63X0.7	16	32	100	48	<b>72,90</b>	100	48	<b>22,55</b>
63X0.8	16	32	100	48	<b>79,20</b>	100	48	<b>22,55</b>
63X0.9	16	-	100	48	<b>81,60</b>	-	-	-
63X1	16	32	100	48	<b>84,10</b>	100	48	<b>22,55</b>
63X1.1	16	-	80	40	<b>86,00</b>	-	-	-
63X1.2	16	32	80	40	<b>89,50</b>	80	40	<b>23,15</b>
63X1.3	16	-	80	40	<b>90,30</b>	-	-	-
63X1.4	16	-	80	40	<b>92,30</b>	-	-	-
63X1.5	16	32	80	40	<b>97,10</b>	80	40	<b>25,65</b>
63X1.6	16	32	80	40	<b>99,60</b>	80	40	<b>25,65</b>
63X1.7	16	-	80	40	<b>104,00</b>	-	-	-
63X1.8	16	-	80	40	<b>104,50</b>	-	-	-
63X1.9	16	-	80	40	<b>111,00</b>	-	-	-
63X2	16	32	80	40	<b>114,50</b>	80	40	<b>28,25</b>
63X2.5	16	32	80	32	<b>135,00</b>	80	32	<b>33,25</b>

**Esempio d'ordine** | Ordering example | Bestellbeispiel | Exemple de commande | Ejemplo de pedido: **MGS01 - (D x b)**

\* Mozzo presente solo nelle seghe in HSS-Co5 | Hub present only in the HSS-Co5 saws | Bund ist nur in den HSS-Co5 Sägeblätter vorhanden | Epaulement présent seulement sur les fraises scies en Hss-Co5 | Anillo presente solamente en las sierras en Hss Hss-Co5



# SEGHE CIRCOLARI CON DENTATURA FINE E GROSSA

CIRCULAR SAW BLADES WITH FINE AND COARSE TEETH | KREISSÄGEBLÄTTER FEIN UND GROSSVERZAHNT  
 FRAISES SCIÉS DENTURE FINE ET LARGE | SIERRAS CIRCULARES DENTADO FINO Y GRUESO

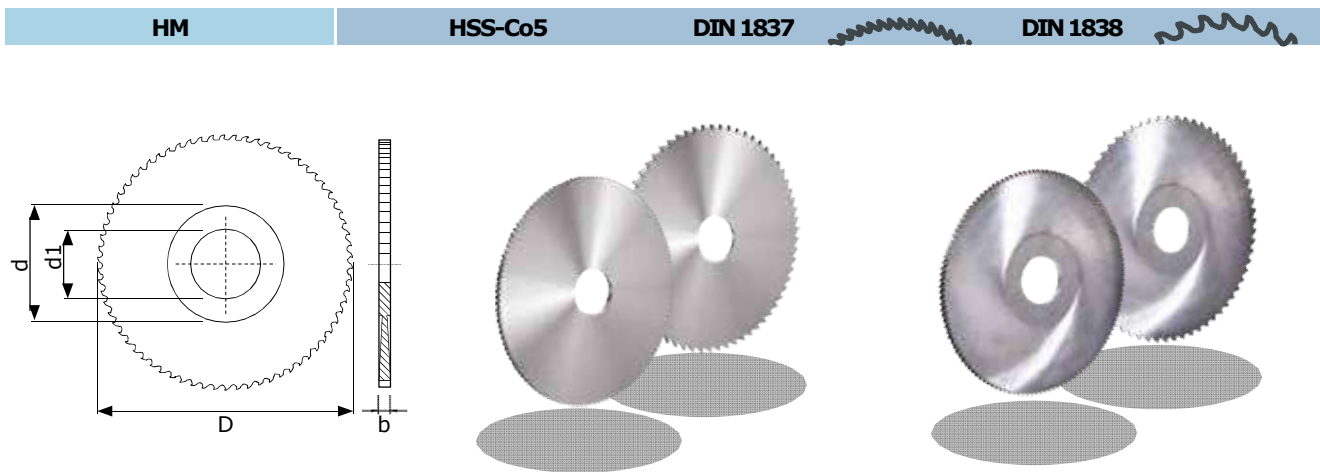

		*MGS03 *MGS04	HM		€	HSS-Co5		€
			MGS01 DIN 1837	MGS02 DIN 1838		MGS03 DIN 1837	MGS04 DIN 1838	
<b>D x b</b>	d <sub>1</sub>	d	Z			Z		
63X3	16	32	64	32	<b>152,50</b>	64	32	<b>35,45</b>
63X3.5	16	32	-	-	-	64	32	<b>39,85</b>
63X4	16	32	64	32	<b>193,50</b>	64	32	<b>44,00</b>
63X5	16	32	48	24	<b>230,50</b>	48	24	<b>52,80</b>
63X6	16	32	48	24	<b>267,00</b>	48	24	<b>57,30</b>
70X0.25	16	-	160	64	<b>104,00</b>	-	-	-
70X0.3	16	-	160	64	<b>104,00</b>	-	-	-
70X0.35	16	-	160	64	<b>95,40</b>	-	-	-
70X0.4	16	-	128	64	<b>95,40</b>	-	-	-
70X0.45	16	-	128	64	<b>92,90</b>	-	-	-
70X0.5	16	-	128	64	<b>92,90</b>	-	-	-
70X0.6	16	-	100	48	<b>96,50</b>	-	-	-
70X0.7	16	-	100	48	<b>102,00</b>	-	-	-
70X0.8	16	-	100	48	<b>108,50</b>	-	-	-
70X0.9	16	-	100	48	<b>111,00</b>	-	-	-
70X1	16	-	100	48	<b>113,50</b>	-	-	-
70X1.1	16	-	80	40	<b>115,00</b>	-	-	-

**Esempio d'ordine** | Ordering example | Bestellbeispiel | Exemple de commande | Ejemplo de pedido: **MGS01 - (D x b)**

\* Mozzo presente solo nelle seghe in HSS-Co5 | Hub present only in the HSS-Co5 saws | Bund ist nur in den HSS-Co5 Sägeblätter vorhanden  
 Epaulement présent seulement sur les fraises sciés en Hss-Co5 | Anillo presente solamente en las sierras en Hss Hss-Co5





# SEGHE CIRCOLARI CON DENTATURA FINE E GROSSA

CIRCULAR SAW BLADES WITH FINE AND COARSE TEETH | KREISSÄGEBLÄTTER FEIN UND GROSSVERZAHNT  
 FRAISES SCIÉS DENTURE FINE ET LARGE | SIERRAS CIRCULARES DENTADO FINO Y GRUESO

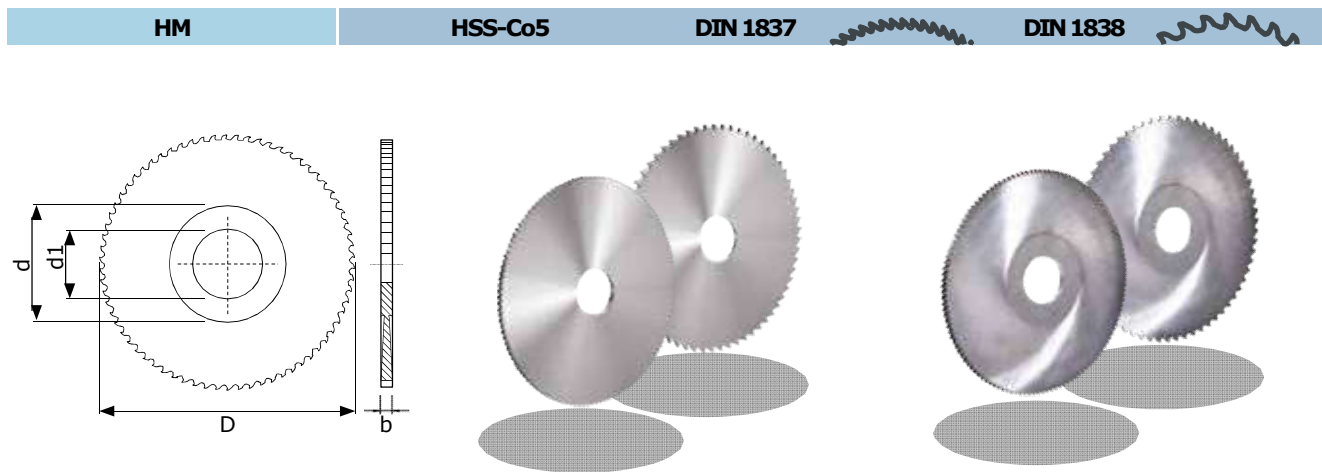

		*MGS03 *MGS04	HM		€	HSS-Co5		€
			MGS01 DIN 1837	MGS02 DIN 1838		MGS03 DIN 1837	MGS04 DIN 1838	
<b>D x b</b>	$d_1$	d	Z			Z		

70X1.2	16	-	80	40	<b>118,50</b>	-	-	-
70X1.3	16	-	80	40	<b>119,50</b>	-	-	-
70X1.4	16	-	80	40	<b>121,50</b>	-	-	-
70X1.5	16	-	80	40	<b>126,50</b>	-	-	-
70X1.6	16	-	80	40	<b>129,00</b>	-	-	-
70X1.7	16	-	80	40	<b>133,50</b>	-	-	-
70X1.8	16	-	80	40	<b>134,00</b>	-	-	-
70X1.9	16	-	80	40	<b>140,50</b>	-	-	-
70X2	16	-	80	40	<b>144,00</b>	-	-	-
70X2.5	16	-	64	32	<b>164,00</b>	-	-	-
70X3	16	-	64	32	<b>182,50</b>	-	-	-
70X4	16	-	64	32	<b>222,00</b>	-	-	-
70X5	16	-	64	24	<b>259,00</b>	-	-	-
70X6	16	-	64	24	<b>297,00</b>	-	-	-

Esempio d'ordine | Ordering example | Bestellbeispiel | Exemple de commande | Ejemplo de pedido: **MGS01 - (D x b)**

\* Mozzo presente solo nelle seghe in HSS-Co5 | Hub present only in the HSS-Co5 saws | Bund ist nur in den HSS-Co5 Sägeblätter vorhanden | Epaulement présent seulement sur les fraises sciés en Hss-Co5 | Anillo presente solamente en las sierras en Hss Hss-Co5



# SEGHE CIRCOLARI CON DENTATURA FINE E GROSSA

CIRCULAR SAW BLADES WITH FINE AND COARSE TEETH | KREISSÄGEBLÄTTER FEIN UND GROSSVERZAHNT  
 FRAISES SCIES DENTURE FINE ET LARGE | SIERRAS CIRCULARES DENTADO FINO Y GRUESO

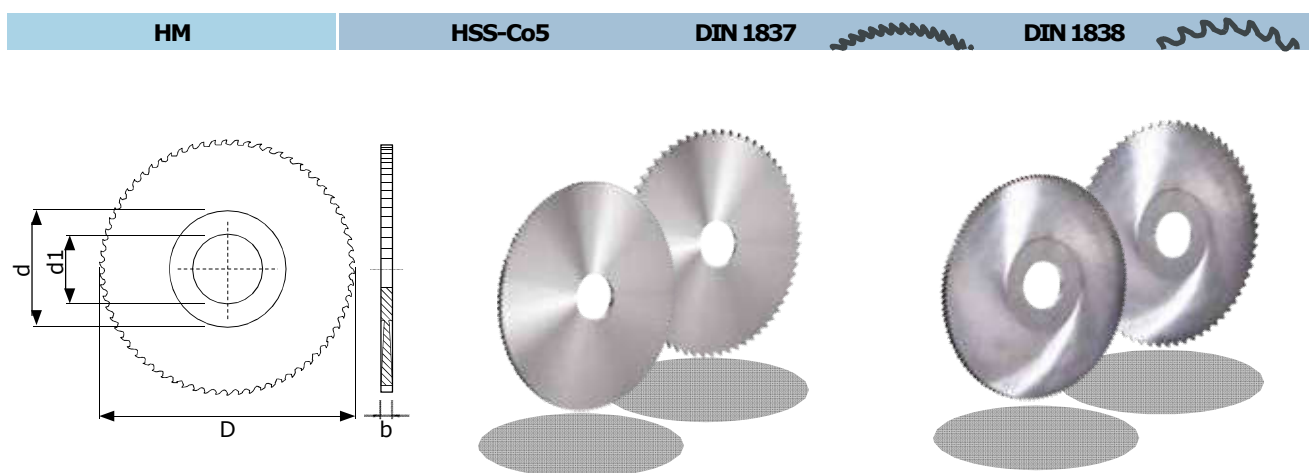

		*MGS03 *MGS04	HM		€	HSS-Co5		€
			MGS01 DIN 1837	MGS02 DIN 1838		MGS03 DIN 1837	MGS04 DIN 1838	
<b>D x b</b>	d <sub>1</sub>	d	Z			Z		
80X0.25	22	-	160	64	<b>146,00</b>	-	-	-
80X0.3	22	36	160	64	<b>146,00</b>	160	80	<b>30,00</b>
80X0.35	22	-	160	64	<b>143,50</b>	-	-	-
80X0.4	22	36	160	64	<b>137,50</b>	160	80	<b>30,00</b>
80X0.45	22	-	128	64	<b>106,00</b>	-	-	-
80X0.5	22	36	128	64	<b>104,00</b>	128	64	<b>29,50</b>
80X0.6	22	36	128	64	<b>99,60</b>	128	64	<b>29,50</b>
80X0.7	22	36	128	64	<b>100,50</b>	128	64	<b>28,25</b>
80X0.8	22	36	128	64	<b>111,00</b>	128	64	<b>28,25</b>
80X0.9	22	-	100	64	<b>115,50</b>	-	-	-
80X1	22	-	100	48	<b>117,00</b>	100	48	<b>28,25</b>
80X1.1	22	-	100	48	<b>119,00</b>	-	-	-
80X1.2	22	36	100	48	<b>122,50</b>	100	48	<b>30,00</b>
80X1.3	22	-	100	48	<b>128,50</b>	-	-	-
80X1.4	22	-	100	48	<b>133,50</b>	-	-	-
80X1.5	22	36	100	48	<b>136,00</b>	100	48	<b>31,30</b>
80X1.6	22	36	100	48	<b>140,00</b>	100	48	<b>31,30</b>
80X1.7	22	-	80	40	<b>151,00</b>	-	-	-
80X1.8	22	-	80	40	<b>153,00</b>	-	-	-
80X1.9	22	-	80	40	<b>156,00</b>	-	-	-
80X2	22	36	80	40	<b>162,50</b>	80	40	<b>35,40</b>

**Esempio d'ordine** | Ordering example | Bestellbeispiel | Exemple de commande | Ejemplo de pedido: **MGS01 - (D x b)**

\*Mozzo presente solo nelle seghe in HSS-Co5 | Hub present only in the HSS-Co5 saws | Bund ist nur in den HSS-Co5 Sägeblätter vorhanden  
 Epaulement présent seulement sur les fraises scies en Hss-Co5 | Anillo presente solamente en las sierras en Hss Hss-Co5



# SEGHE CIRCOLARI CON DENTATURA FINE E GROSSA

CIRCULAR SAW BLADES WITH FINE AND COARSE TEETH | KREISSÄGEBLÄTTER FEIN UND GROSSVERZAHNT  
 FRAISES SCIÉS DENTURE FINE ET LARGE | SIERRAS CIRCULARES DENTADO FINO Y GRUESO

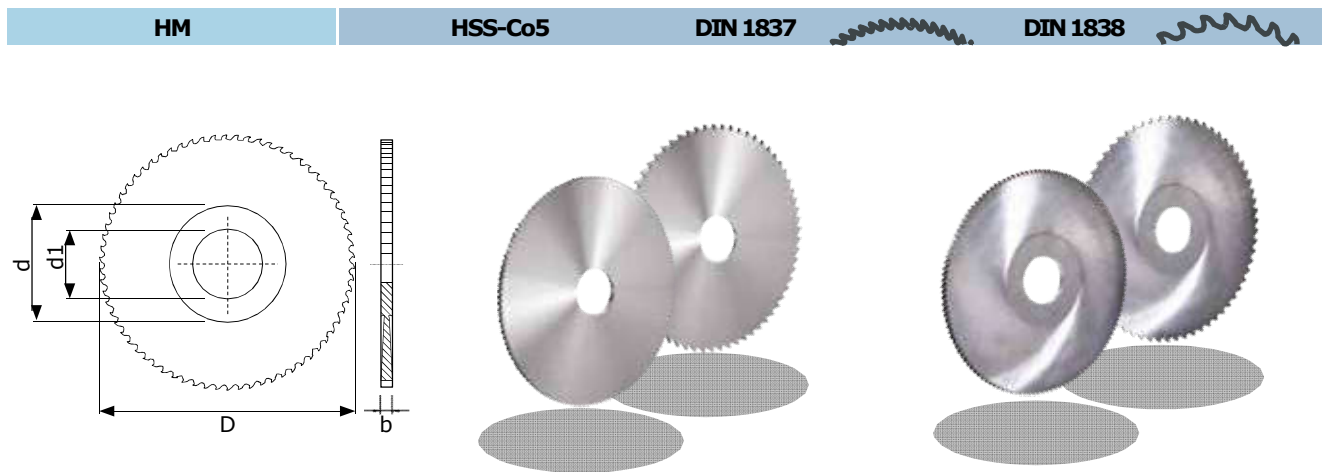

		*MGS03 *MGS04	HM		€	HSS-Co5		€
			MGS01 DIN 1837	MGS02 DIN 1838		MGS03 DIN 1837	MGS04 DIN 1838	
<b>D x b</b>	d <sub>1</sub>	d	Z			Z		

80X2.5	22	36	80	40	<b>190,00</b>	80	40	<b>39,15</b>
80X3	22	36	80	40	<b>225,50</b>	80	40	<b>43,80</b>
80X3.5	22	-	-	-	-	80	40	<b>47,90</b>
80X4	22	36	64	32	<b>270,00</b>	64	32	<b>52,90</b>
80X5	22	36	64	32	<b>328,00</b>	64	32	<b>58,30</b>
80X6	22	36	64	32	<b>373,00</b>	64	32	<b>66,00</b>

100X0.4	22	-	160	80	<b>194,00</b>	-	-	-
100X0.45	22	-	160	80	<b>194,00</b>	-	-	-
100X0.5	22	40	160	80	<b>194,00</b>	160	100	<b>33,30</b>
100X0.6	22	40	160	80	<b>186,50</b>	160	80	<b>33,30</b>
100X0.7	22	40	128	64	<b>177,50</b>	128	64	<b>33,30</b>
100X0.8	22	40	128	64	<b>160,50</b>	128	64	<b>33,30</b>
100X0.9	22	-	128	64	<b>160,50</b>	-	-	-
100X1	22	40	128	64	<b>148,50</b>	128	64	<b>33,30</b>
100X1.1	22	-	128	64	<b>156,00</b>	-	-	-
100X1.2	22	40	128	64	<b>165,50</b>	128	64	<b>35,30</b>
100X1.3	22	-	100	48	<b>174,00</b>	-	-	-

Esempio d'ordine | Ordering example | Bestellbeispiel | Exemple de commande | Ejemplo de pedido: **MGS01 - (D x b)**

\* Mozzo presente solo nelle seghe in HSS-Co5 | Hub present only in the HSS-Co5 saws | Bund ist nur in den HSS-Co5 Sägeblätter vorhanden | Epaulement présent seulement sur les fraises sciés en Hss-Co5 | Anillo presente solamente en las sierras en Hss Hss-Co5



# SEGHE CIRCOLARI CON DENTATURA FINE E GROSSA

CIRCULAR SAW BLADES WITH FINE AND COARSE TEETH | KREISSÄGEBLÄTTER FEIN UND GROSSVERZAHNT  
 FRAISES SCIES DENTURE FINE ET LARGE | SIERRAS CIRCULARES DENTADO FINO Y GRUESO

HM	HSS-Co5	DIN 1837	DIN 1838
----	---------	----------	----------

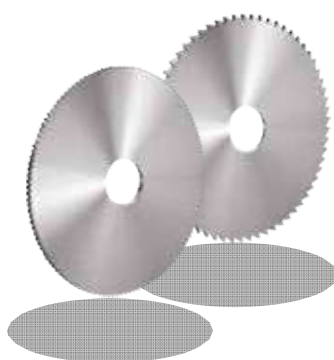
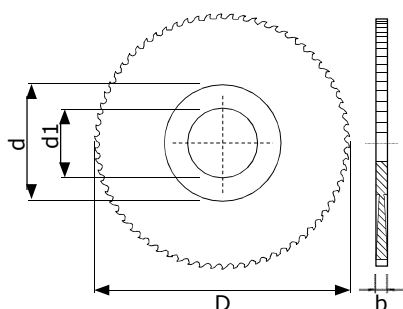

		*MGS03 *MGS04	HM		HSS-Co5			
			MGS01 DIN 1837	MGS02 DIN 1838	MGS03 DIN 1837	MGS04 DIN 1838		
<b>D x b</b>	d <sub>1</sub>	d	Z	€	Z	€		

100X1.4	22	-	100	48	<b>180,50</b>	-	-	-
100X1.5	22	40	100	48	<b>186,50</b>	100	64	<b>39,15</b>
100X1.6	22	40	100	48	<b>196,50</b>	100	48	<b>39,15</b>
100X1.7	22	-	100	48	<b>205,50</b>	-	-	-
100X1.8	22	-	100	48	<b>209,50</b>	-	-	-
100X1.9	22	-	100	48	<b>226,50</b>	-	-	-
100X2	22	-	100	48	<b>233,50</b>	100	48	<b>43,60</b>
100X2.5	22	-	100	48	<b>265,00</b>	100	48	<b>47,90</b>
100X3	22	-	100	40	<b>303,00</b>	80	40	<b>54,10</b>
100X3.5	22	40	-	-	-	80	40	<b>59,70</b>
100X4	22	40	80	40	<b>378,00</b>	80	40	<b>65,20</b>
100X5	22	40	80	40	<b>458,00</b>	80	40	<b>73,10</b>
100X6	22	40	64	32	<b>529,00</b>	64	32	<b>81,30</b>

Esempio d'ordine | Ordering example | Bestellbeispiel | Exemple de commande | Ejemplo de pedido: **MGS01 - (D x b)**

\* Mozzo presente solo nelle seghe in HSS-Co5 | Hub present only in the HSS-Co5 saws | Bund ist nur in den HSS-Co5 Sägeblätter vorhanden | Epaulement présent seulement sur les fraises scies en Hss-Co5 | Anillo presente solamente en las sierras en Hss Hss-Co5





# SEGHE CIRCOLARI CON DENTATURA FINE E GROSSA

CIRCULAR SAW BLADES WITH FINE AND COARSE TEETH | KREISSÄGEBLÄTTER FEIN UND GROSSVERZAHNT  
 FRAISES SCIES DENTURE FINE ET LARGE | SIERRAS CIRCULARES DENTADO FINO Y GRUESO

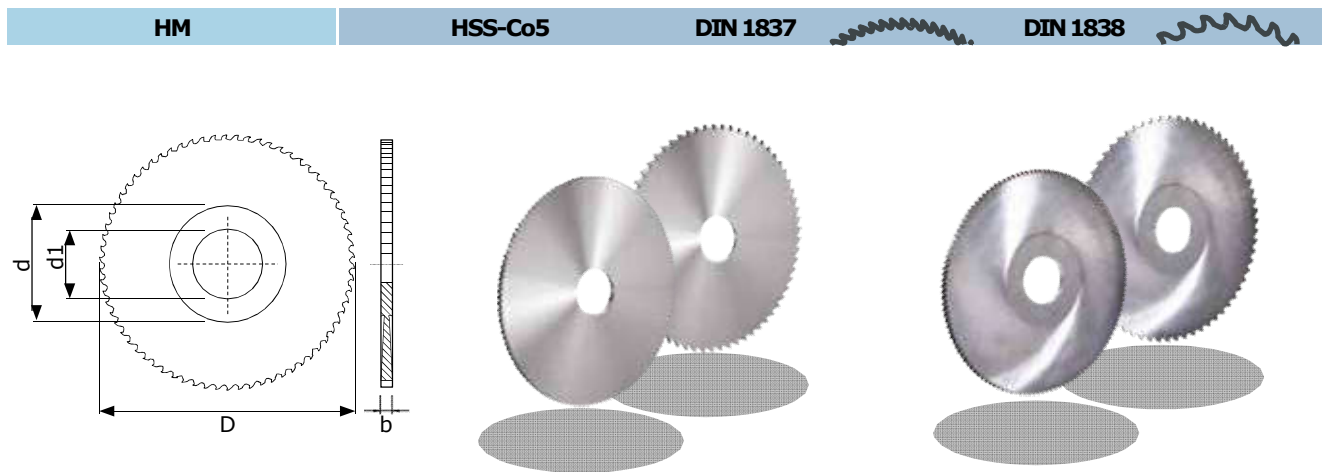

		*MGS03 *MGS04	HM		HSS-Co5		
			DIN 1837	DIN 1838	DIN 1837	DIN 1838	
<b>D x b</b>	d <sub>1</sub>	d	Z		€	Z	€
125X0.4	22	-	160	-	<b>337,00</b>	-	-
125X0.45	22	-	160	-	<b>337,00</b>	-	-
125X0.5	22	-	160	80	<b>337,00</b>	-	-
125X0.6	22	40	160	80	<b>318,00</b>	160	100 <b>47,20</b>
125X0.7	22	40	160	80	<b>306,00</b>	160	100 <b>47,20</b>
125X0.8	22	40	160	80	<b>272,00</b>	160	80 <b>45,90</b>
125X0.9	22	-	160	80	<b>272,00</b>	-	-
125X1	22	40	160	80	<b>241,00</b>	160	80 <b>45,90</b>
125X1.1	22	-	128	64	<b>249,00</b>	-	-
125X1.2	22	40	128	64	<b>265,00</b>	128	64 <b>47,90</b>
125X1.3	22	-	128	64	<b>290,00</b>	-	-
125X1.4	22	-	128	64	<b>290,00</b>	-	-
125X1.5	22	40	128	64	<b>303,00</b>	128	64 <b>53,00</b>
125X1.6	22	40	128	64	<b>313,00</b>	128	64 <b>53,00</b>
125X1.7	22	-	128	64	<b>337,00</b>	-	-
125X1.8	22	-	128	64	<b>337,00</b>	-	-
125X1.9	22	-	128	64	<b>371,00</b>	-	-
125X2	22	40	128	64	<b>371,00</b>	128	64 <b>57,00</b>
125X2.5	22	40	100	48	<b>434,00</b>	100	48 <b>62,20</b>
125X3	22	40	100	48	<b>498,00</b>	100	48 <b>70,20</b>
125X3.5	22	40	-	-	-	100	48 <b>77,30</b>
125X4	22	40	100	48	<b>657,00</b>	100	48 <b>84,60</b>

Esempio d'ordine | Ordering example | Bestellbeispiel | Exemple de commande | Ejemplo de pedido: **MGS01 - (D x b)**

**Ordine minimo 10 pezzi** | Minimum order q.ty 10 pièces | Mindestbestellmenge 10 Stück | Minimum de commande 10 pièces | Cantidad mínima de pedido 10 uds

\* Mozzo presente solo nelle seghe in HSS-Co5 | Hub present only in the HSS-Co5 saws | Bund ist nur in den HSS-Co5 Sägeblätter vorhanden | Epaulement présent seulement sur les fraises scies en Hss-Co5 | Anillo presente solamente en las sierras en Hss Hss-Co5



# SEGHE CIRCOLARI CON DENTATURA FINE E GROSSA

CIRCULAR SAW BLADES WITH FINE AND COARSE TEETH | KREISSÄGEBLÄTTER FEIN UND GROSSVERZAHNT  
 FRAISES SCIÉS DENTURE FINE ET LARGE | SIERRAS CIRCULARES DENTADO FINO Y GRUESO

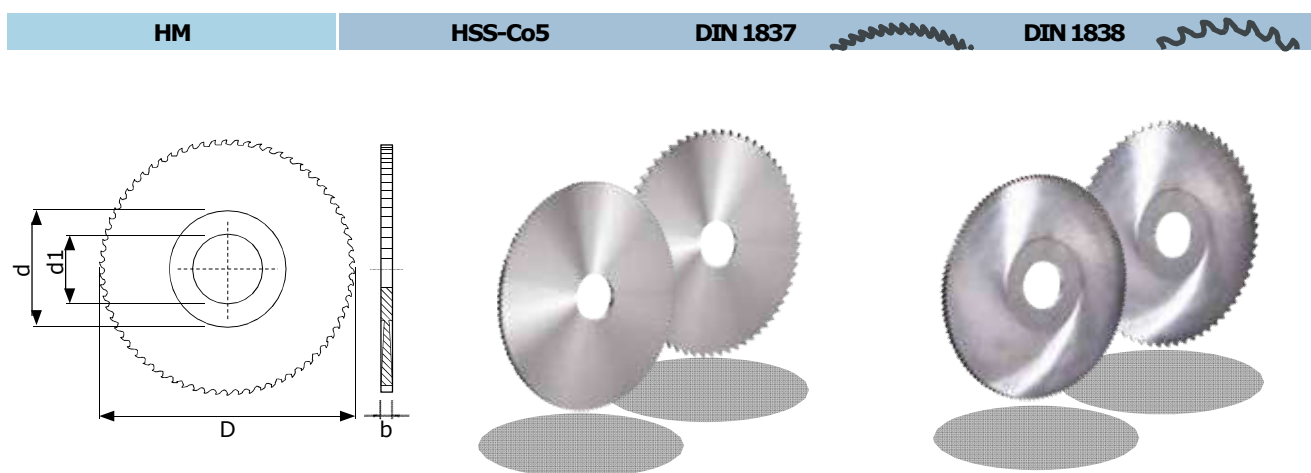

	HM	HSS-Co5	DIN 1837		€	DIN 1838		€
			MGS01	MGS02		MGS03	MGS04	
			DIN 1837	DIN 1838		DIN 1837	DIN 1838	
			HM			HSS-Co5		
<b>D x b</b>	d <sub>1</sub>	d	Z		€	Z		€
125X5	22	40	80	40	<b>753,00</b>	80	40	<b>96,40</b>
125X6	22	40	80	40	<b>921,00</b>	80	40	<b>110,50</b>
150X0.7	32	-	150	80	<b>474,00</b>	-	-	-
150X0.8	32	-	150	80	<b>447,00</b>	-	-	-
150X0.9	32	-	150	80	<b>447,00</b>	-	-	-
150X1	32	63	150	80	<b>406,00</b>	160	100	<b>57,10</b>
150X1.1	32	-	150	80	<b>368,00</b>	-	-	-
150X1.2	32	63	150	80	<b>362,00</b>	160	100	<b>60,30</b>
150X1.3	32	-	150	80	<b>411,00</b>	-	-	-
150X1.4	32	-	150	80	<b>411,00</b>	-	-	-
150X1.5	32	63	150	80	<b>368,00</b>	160	100	<b>61,40</b>
150X1.6	32	63	150	64	<b>368,00</b>	160	80	<b>65,70</b>
150X1.7	32	-	128	64	<b>451,00</b>	-	-	-
150X1.8	32	-	128	64	<b>468,00</b>	-	-	-
150X1.9	32	-	128	64	<b>549,00</b>	-	-	-
150X2	32	63	128	64	<b>549,00</b>	128	80	<b>69,30</b>
150X2.5	32	63	128	64	<b>618,00</b>	128	80	<b>77,70</b>
150X3	32	63	128	64	<b>687,00</b>	128	64	<b>87,20</b>
150X3.5	32	-	-	-	-	128	64	<b>96,80</b>
150X4	32	63	100	64	<b>885,00</b>	100	64	<b>107,50</b>
150X5	32	63	100	48	<b>984,00</b>	80	64	<b>123,50</b>
150X6	32	63	100	48	<b>1.140,00</b>	80	48	<b>139,00</b>

Esempio d'ordine | Ordering example | Bestellbeispiel | Exemple de commande | Ejemplo de pedido: **MGS01 - (D x b)**

Ordine minimo 10 pezzi | Minimum order q.ty 10 pièces | Mindestbestellmenge 10 Stück | Minimum de commande 10 pièces  
 Cantidad mínima de pedido 10 uds

\* Mozzo presente solo nelle seghe in HSS-Co5 | Hub present only in the HSS-Co5 saws | Bund ist nur in den HSS-Co5 Sägeblätter vorhanden | Epaulement présent seulement sur les fraises sciés en Hss-Co5 | Anillo presente solamente en las sierras en Hss Hss-Co5



# SEGHE CIRCOLARI CON DENTATURA FINE E GROSSA

CIRCULAR SAW BLADES WITH FINE AND COARSE TEETH | KREISSÄGEBLÄTTER FEIN UND GROSSVERZAHNT  
 FRAISES SCIÉS DENTURE FINE ET LARGE | SIERRAS CIRCULARES DENTADO FINO Y GRUESO

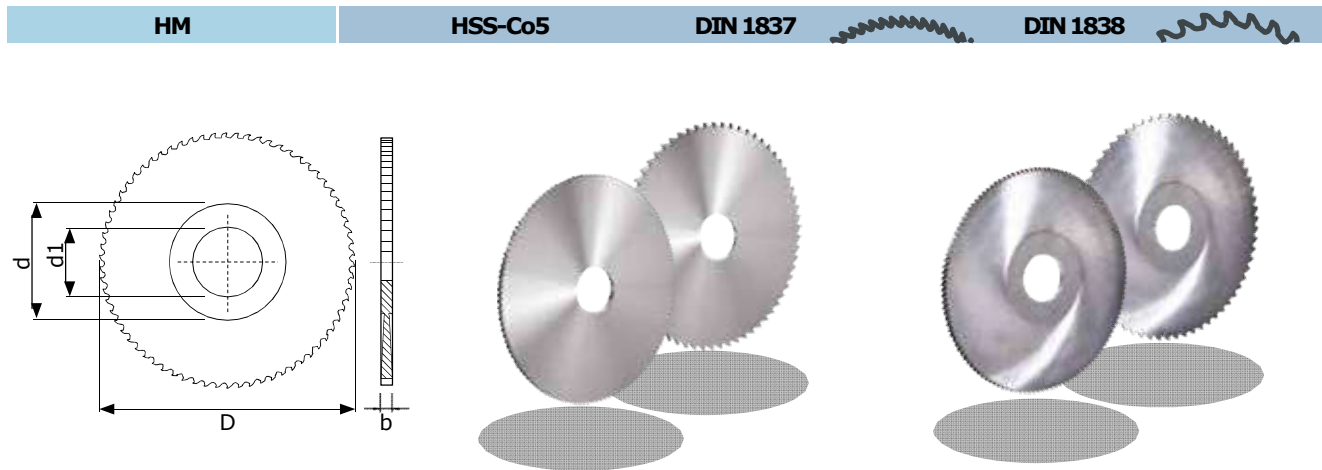

D x b	d <sub>1</sub>	d	HM		€	HSS-Co5		€
			Z			Z		
160X0.8	32	-	160	80	<b>524,00</b>	-	-	-
160X0.9	32	-	160	80	<b>486,00</b>	-	-	-
160X1	32	63	160	80	<b>474,00</b>	160	80	<b>61,90</b>
160X1.1	32	-	160	80	<b>424,00</b>	-	-	-
160X1.2	32	63	160	80	<b>424,00</b>	160	80	<b>61,90</b>
160X1.3	32	-	160	80	<b>468,00</b>	-	-	-
160X1.4	32	-	160	80	<b>468,00</b>	-	-	-
160X1.5	32	63	160	80	<b>422,00</b>	160	80	<b>66,00</b>
160X1.6	32	63	160	80	<b>424,00</b>	160	80	<b>66,00</b>
160X1.7	32	-	160	80	<b>518,00</b>	-	-	-
160X1.8	32	-	128	80	<b>539,00</b>	-	-	-
160X1.9	32	-	128	80	<b>634,00</b>	-	-	-
160X2	32	-	128	64	<b>634,00</b>	128	64	<b>75,50</b>
160X2.5	32	-	128	64	<b>723,00</b>	128	64	<b>85,90</b>
160X3	32	-	128	64	<b>780,00</b>	128	64	<b>98,20</b>
160X3.5	32	63	-	-	-	128	64	<b>105,00</b>
160X4	32	63	100	64	<b>1.022,00</b>	100	48	<b>120,50</b>
160X5	32	63	100	64	<b>1.277,00</b>	100	48	<b>139,00</b>
160X6	32	63	100	48	<b>1.557,00</b>	100	48	<b>164,50</b>

Esempio d'ordine | Ordering example | Bestellbeispiel | Exemple de commande | Ejemplo de pedido: **MGS01 - (D x b)**

**Ordine minimo 10 pezzi** | Minimum order q.ty 10 pièces | Mindestbestellmenge 10 Stück | Minimum de commande 10 pièces | Cantidad mínima de pedido 10 uds

\* Mozzo presente solo nelle seghe in HSS-Co5 | Hub present only in the HSS-Co5 saws | Bund ist nur in den HSS-Co5 Sägeblätter vorhanden | Epaulement présent seulement sur les fraises sciés en Hss-Co5 | Anillo presente solamente en las sierras en Hss Hss-Co5



# SEGHE CIRCOLARI CON DENTATURA FINE E GROSSA

CIRCULAR SAW BLADES WITH FINE AND COARSE TEETH | KREISSÄGEBLÄTTER FEIN UND GROSSVERZAHNT  
 FRAISES SCIES DENTURE FINE ET LARGE | SIERRAS CIRCULARES DENTADO FINO Y GRUESO

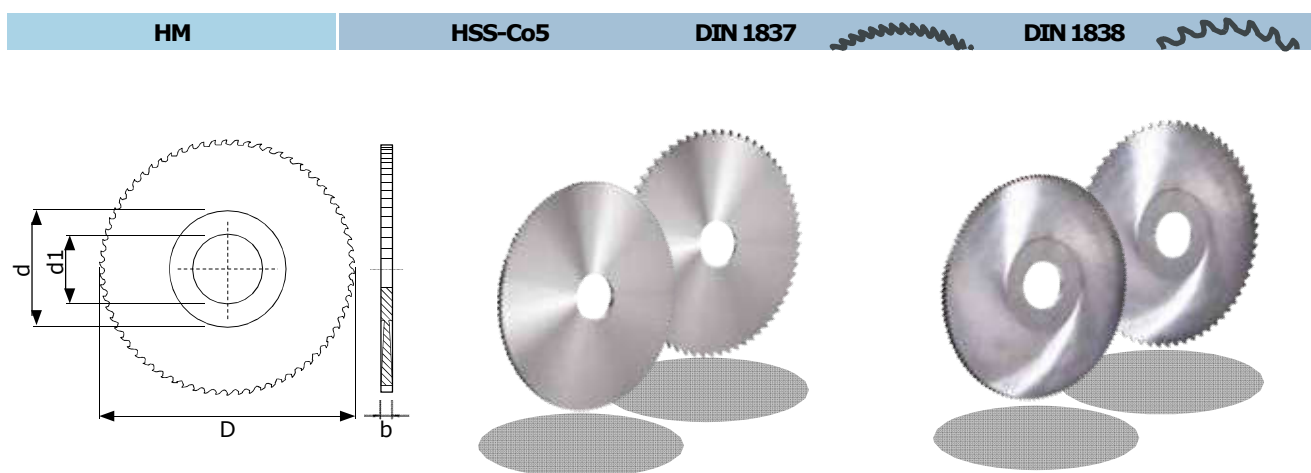

		*MGS03 *MGS04	HM			HSS-Co5		
			MGS01 DIN 1837	MGS02 DIN 1838		MGS03 DIN 1837	MGS04 DIN 1838	
<b>D x b</b>	d <sub>1</sub>	d	Z		€	Z		€
175X1	32	63	-	-	-	160	100	<b>73,90</b>
175X1.2	32	63	-	-	-	160	100	<b>79,50</b>
175X1.5	32	63	-	-	-	160	100	<b>80,00</b>
175X1.6	32	63	-	-	-	160	100	<b>83,40</b>
175X2	32	63	-	-	-	128	80	<b>87,20</b>
175X2.5	32	63	-	-	-	128	80	<b>99,60</b>
175X3	32	63	-	-	-	128	80	<b>114,00</b>
175X3.5	32	63	-	-	-	128	64	<b>127,50</b>
175X4	32	63	-	-	-	128	64	<b>150,50</b>
175X5	32	63	-	-	-	100	64	<b>175,00</b>
175X6	32	63	-	-	-	100	48	<b>197,00</b>

Esempio d'ordine | Ordering example | Bestellbeispiel | Exemple de commande | Ejemplo de pedido: **MGS01 - (D x b)**

**Ordine minimo 10 pezzi** | Minimum order q.ty 10 pièces | Mindestbestellmenge 10 Stück | Minimum de commande 10 pièces | Cantidad mínima de pedido 10 uds

\* Mozzo presente solo nelle seghe in HSS-Co5 | Hub present only in the HSS-Co5 saws | Bund ist nur in den HSS-Co5 Sägeblätter vorhanden | Epaulement présent seulement sur les fraises scies en Hss-Co5 | Anillo presente solamente en las sierras en Hss Hss-Co5





# SEGHE CIRCOLARI CON DENTATURA FINE E GROSSA

CIRCULAR SAW BLADES WITH FINE AND COARSE TEETH | KREISSÄGEBLÄTTER FEIN UND GROSSVERZAHNT  
 FRAISES SCIÉS DENTURE FINE ET LARGE | SIERRAS CIRCULARES DENTADO FINO Y GRUESO

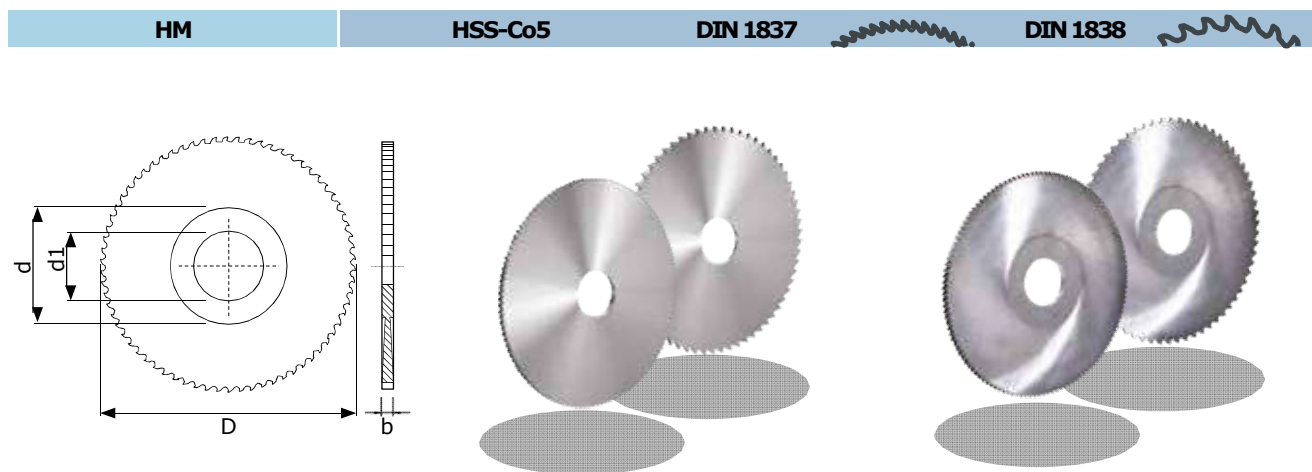

D x b	d <sub>1</sub>	d	HM		HSS-Co5		
			Z	€	Z	€	
200X1	32	63	-	-	200	100	87,20
200X1.2	32	-	200	100	200	100	87,20
200X1.3	32	-	200	80	-	-	-
200X1.4	32	-	200	80	-	-	-
200X1.5	32	63	200	80	200	100	91,30
200X1.6	32	63	160	80	160	80	91,30
200X1.7	32	-	160	80	-	-	-
200X1.8	32	-	160	80	-	-	-
200X1.9	32	-	160	80	-	-	-
200X2	32	63	160	80	160	80	98,80
200X2.5	32	63	160	64	160	80	112,00
200X3	32	63	128	-	128	64	130,00
200X3.5	32	63	-	-	128	64	144,50
200X4	32	63	128	64	128	64	171,00
200X5	32	63	128	64	128	64	197,00
200X6	32	63	128	64	100	48	220,50

Esempio d'ordine | Ordering example | Bestellbeispiel | Exemple de commande | Ejemplo de pedido: **MGS01 - (D x b)**

Ordine minimo 10 pezzi | Minimum order q.ty 10 pièces | Mindestbestellmenge 10 Stück | Minimum de commande 10pièces  
 Cantidad mínima de pedido 10 uds

\* Mozzo presente solo nelle seghe in HSS-Co5 | Hub present only in the HSS-Co5 saws | Bund ist nur in den HSS-Co5 Sägeblätter  
 vorhanden Epaulement présent seulement sur les fraises sciés en Hss-Co5 | Anillo presente solamente en las sierras en Hss Hss-Co5



# SEGHE CIRCOLARI CON DENTATURA FINE E GROSSA

CIRCULAR SAW BLADES WITH FINE AND COARSE TEETH | KREISSÄGEBLÄTTER FEIN UND GROSSVERZAHNT  
 FRAISES SCIÉS DENTURE FINE ET LARGE | SIERRAS CIRCULARES DENTADO FINO Y GRUESO

HM	HSS-Co5	DIN 1837	DIN 1838
----	---------	----------	----------

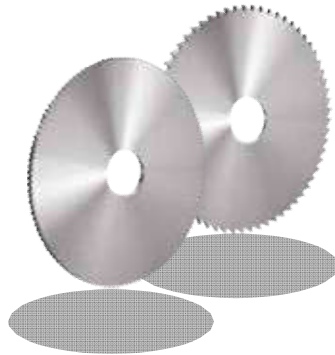
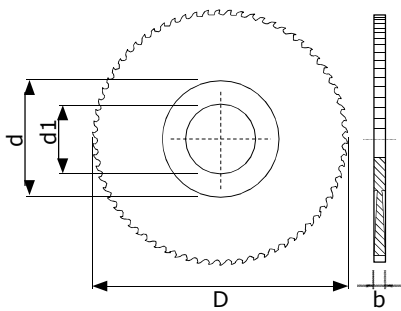

D x b	d <sub>1</sub>	d	HM		€	HSS-Co5		€
			Z	Z		Z	Z	
			MGS01	MGS02		MGS03	MGS04	
			DIN 1837	DIN 1838		DIN 1837	DIN 1838	
			HM			HSS-Co5		

250X1.5	32	63	-	-	-	200	128	<b>138,50</b>
250X1.6	32	63	-	-	-	200	100	<b>138,50</b>
250X2	32	63	200	100	<b>2.303,00</b>	200	100	<b>135,50</b>
250X2.5	32	63	160	80	<b>1.371,00</b>	160	80	<b>152,00</b>
250X3	32	63	160	80	<b>2.366,00</b>	160	80	<b>172,50</b>
250X3.5	32	63	-	-	-	160	80	<b>191,00</b>
250X4	32	63	160	80	<b>2.738,00</b>	160	80	<b>225,50</b>
250X5	32	63	128	80	<b>3.112,00</b>	128	64	<b>263,00</b>
250X6	32	63	128	80	<b>3.484,00</b>	128	64	<b>316,00</b>

315X2.5	40	80	-	-	-	200	100	<b>244,50</b>
315X3	40	80	-	-	-	200	100	<b>277,00</b>
315X4	40	80	-	-	-	160	80	<b>347,00</b>
315X5	40	80	-	-	-	160	80	<b>413,00</b>
315X6	40	80	-	-	-	160	80	<b>483,00</b>

Esempio d'ordine | Ordering example | Bestellbeispiel | Exemple de commande | Ejemplo de pedido: **MGS01 - (D x b)**

Ordine minimo 10 pezzi | Minimum order q.ty 10 pièces | Mindestbestellmenge 10 Stück | Minimum de commande 10 pièces | Cantidad mínima de pedido 10 uds

\* Mozzo presente solo nelle seghe in HSS-Co5 | Hub present only in the HSS-Co5 saws | Bund ist nur in den HSS-Co5 Sägeblätter vorhanden | Epaulement présent seulement sur les fraises sciés en Hss-Co5 | Anillo presente solamente en las sierras en Hss Hss-Co5



## SEGHE CIRCOLARI PER TRONCATRICI

CIRCULAR SAW BLADES FOR CUT-OFF MACHINES | MASCHINENKREISSÄGEBLÄTTER | FRAISES SCIES  
POUR MACHINES A TRONCONNER | SIERRAS CIRCULARES PARA MÁQUINAS TRONZADORAS

HSS-Co5

TICN/COATING

HSS-Co5

TIN/COATING

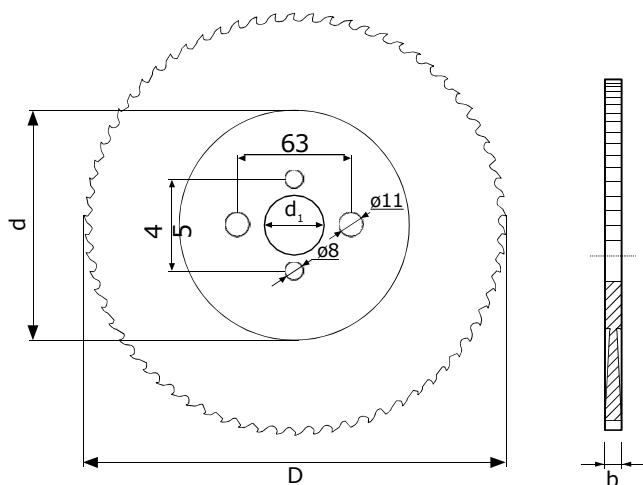

MGS05

HSS-Co5

D x b	d <sub>1</sub>	d	MGS05	
			Z	€
200X1.8	32	90	130	<b>75,90</b>
200X1.8	32	90	200	<b>75,90</b>
225X2	32	90	140	<b>86,60</b>
225X2	32	90	220	<b>86,60</b>
250X2	32	100	128	<b>100,50</b>
250X2	32	100	160	<b>100,50</b>
250X2	32	100	200	<b>100,50</b>
250X2	32	100	260	<b>100,50</b>
275X2	32	100	140	<b>128,00</b>
275X2	32	100	220	<b>128,00</b>
300X2.5	32	100	160	<b>160,00</b>
300X2.5	32	100	180	<b>160,00</b>
300X2.5	32	100	220	<b>160,00</b>
300X2.5	32	100	300	<b>160,00</b>
315X2.5	32	100	160	<b>183,50</b>
315X2.5	32	100	220	<b>183,50</b>
350X2.5**	32	120	180	<b>215,00</b>
350X2.5**	32	120	220	<b>215,00</b>

Esempio d'ordine | Ordering example | Bestellbeispiel | Exemple de commande | Ejemplo de pedido: **MGS05 + (D x b)**

\* **(BLACK)** Con trattamento di vaporizzazione | With vaporization treatment | Dampfbehandelt | Avec traitement de vaporisation  
Con tratamiento de vaporización

\*\* **(d<sub>1</sub> 40 mm)** A richiesta | Upon request | Auf Anfrage | Sur demande | Bajo pedido



# GUIDA TECNICA

TECHNICAL GUIDE | TECHNISCHE DATEN  
GUIDE TECHNIQUE | GUÍA TÉCNICA

**MEGACUT**  
**2024**





# GUIDA TECNICA

TECHNICAL GUIDE | TECHNISCHE DATEN  
GUIDE TECHNIQUE | GUÍA TÉCNICA

## PARAMETRI DI TAGLIO CONSIGLIATI

CUTTING PARAMETERS SUGGESTED | EMPFOHLENE SCHNITTDATEN  
PARAMÈTRES DE COUPE RECOMMANDÉS | PARÁMETROS DE CORTE RECOMENDADOS

GRUPPI MATERIALI Material groups   Beispiele Material Groupes de matériaux   Grupos demateriales	$V_c$ (m/1)		$f_z$ (mm)	
	HM	HSS-Co5	HM	HSS-Co5
<b>P<sub>1</sub></b> ACCIAIO NON LEGATO Unalloyed Steel <800N/mm <sup>2</sup>	100/150	50/70	0,005 - 0,08	
<b>P<sub>2</sub></b> ACCIAIO BASSO E MEDIOLEGATO Low and Medium Steel 700/1000 N/mm <sup>2</sup>	60/120	40/50	0,003 - 0,06	
<b>P<sub>3</sub></b> ACCIAIO ALTO LEGATO High-Alloyed Steel 1000/1300 N/mm <sup>2</sup>	30/50	15/20	0,002 - 0,04	
<b>M<sub>1</sub></b> ACCIAIO INOSSIDABILE - FERRITICO/MARTENSITICO Stainless Steel - Ferritic/Martensitic	30/45	15/25	0,002 - 0,04	
<b>M<sub>2</sub></b> ACCIAIO INOSSIDABILE - AUSTENICO Stainless Steel - Austenitic	60/120	15/30	0,003 - 0,06	
<b>K<sub>1</sub></b> GHISA GRIGIA Gray Cast Iron	50/140	25/35	0,003 - 0,06	
<b>K<sub>2</sub></b> GHISA SFEROIDALE Nodular Cast Iron	30/60	15/20	0,002 - 0,04	
<b>N<sub>1</sub></b> ALLUMINIO E LEGHE DI ALLUMINIO Aluminum & Aluminum Alloys	400/800	300/600	0,007 - 0,09	
<b>N<sub>2</sub></b> OTTONE E LEGHE DI RAME Brass and Copper Alloys	120/500	250/500	0,005 - 0,06	
<b>S<sub>1</sub></b> TITANIO E LEGHE DI TITANIO Titanium and Titanium Alloys	20/70	15/25	0,003 - 0,05	
<b>S<sub>2</sub></b> LEGHE RESISTENTI AL CALORE Heat Resistant Super Alloys HRSA	20/40	10/20	0,002 - 0,04	



## FORMULE

FORMULAS | FORMEL  
 FORMULE | FÓRMULAS

$$V_c = \frac{3,14 \times D \times n}{1000}$$

$$n = \frac{V_c \times 1000}{D \times 3,14}$$

$$V_f = f_z \times Z \times n$$

- 1 **(D) mm | Diametro utensile** | Tool diameter | Werkzeugdurchmesser | Diamètre de l'outil | Diámetro de la herramienta
- 2 **(V<sub>c</sub>) m/1'** | **Velocità di taglio** | Cutting speed | Schnittgeschwindigkeit | Vitesse de coupe | Velocidad de corte
- 3 **(n)** | **Numeri di giri/minuto** | Revolution per minute | Um- Drehungen pro Minute | Tours par minute | Revoluciones por minuto
- 4 **(V<sub>f</sub>) mm/1'** | **Velocità di avanzamento** | Feed Speed | Vorschubgeschwindigkeit | Vitesse d'avance | Factor de avance
- 5 **(f<sub>z</sub>) mm** | **Avanzamento per dente** | Tooth Speed | Zahnvorschub | Avancement au dent | Avance por diente
- 6 **(Z)** | **Numero di denti** | Number of teeth | Zähnezahl | Nombre de dents | Número de cortes

**AVANZAMENTO (f<sub>z</sub>) COMPRESO TRA 0,001-0,005 PER DENTE IN RELAZIONE AL RAPPORTO: DIAMETRO FRESA, SPESSORE, PROFONDITÀ RADIALE (a<sub>e</sub>), REFRIGERANTE, TIPO DI LAVORAZIONE RIGIDITÀ MACCHINA.**

**FEED (f<sub>z</sub>) BETWEEN 0,001-0,005 PER TOOTH ACCORDING TO THE RELATION WITH: SAW BLADE DIAMETER, THICKNESS, RADIAL DEPTH (a<sub>e</sub>), COOLANT, TYPE OF MACHINE WORK, RIGIDITY OF THE MACHINE.**

**VORSCHUB (f<sub>z</sub>) ZWISCHEN 0,001-0,005 PRO ZAHN, IN BEZUG AUF: KREISSÄGEBLATT DURCHMESSER, BREITE, RADIALE TIEFE (a<sub>e</sub>), SCHMIERUNG, BEARBEITUNGSART, STEIFHEIT DER MASCHINE.**

**AVANCEMENT (f<sub>z</sub>) ENTRE 0,001-0,005 AU DENT, EN RELATION DE: DIAMÈTRE DE LA FRAISE, ÉPAISSEUR, PROFONDITÉ RADIALE (a<sub>e</sub>), LUBRIFICATION, TYPE DE USINAGE, RIGIDITÉ DE LA MACHINE.**

**AVANCE (f<sub>z</sub>) ENTRE 0,001-0,005 POR LABIOS, EN RELACIÓN CON: DIÁMETRO DE LA SIERRA, ESPESOR, PROFUNDIDAD RADIAL (a<sub>e</sub>), LUBRIFICACIÓN, TIPO DE APLICACIÓN, RIGIDEZ DE LA MÁQUINA.**



## GUIDA TECNICA

TECHNICAL GUIDE | TECHNISCHE DATEN  
GUIDE TECHNIQUE | GUÍA TÉCNICA

### CALCOLO DELLO SPESSORE MEDIO DEL TRUCIOLO ( $h_m$ )

CALCULATION AVERAGE CHIP THICKNESS ( $h_m$ ) | BERECHNUNG DER DURCHSCHNITTLICHEN SPANDICKE ( $h_m$ )  
CALCUL POUR L'ÉPAISSEUR MOYENNE DU COPEAU ( $h_m$ ) | CALCULO DEL ESPESOR MEDIO DE LA VIRUTA ( $h_m$ )

$$h_m = f_z \times \sqrt{\frac{a_e}{D}}$$

$$f_z = h_m \times \sqrt{\frac{D}{a_e}}$$

- 1 **(D) mm | Diametro utensile** | Tool diameter  
Werkzeugdurchmesser | Diamètre de l'outil  
Diámetro de la herramienta
- 2 **( $a_e$ ) | Impegno radiale utensile** |  
Radial depth  
Radiale Tiefe | Profondeur radiale  
Profundidad radial
- 3 **( $f_z$ ) mm | Avanzamento per dente** | Tooth  
Speed Zahnvorschub | Avancement au dent  
Avance por diente
- 4 **( $h_m$ ) | Spessore medio del truciolo** |  
Average chip thickness | Durchschnittliche  
Spandicke | Epaisseur moyenne du  
copeau | Espesor medio de la viruta

#### GRUPPO MATERIALI

Material groups  
Beispiele Material  
Groupes de matériaux  
Grupos de materiales

$h_m$

$P_1$	0,015 ÷ 0,030
$P_2$	0,015 ÷ 0,025
$P_3$	0,010 ÷ 0,025
$M_1$	0,010 ÷ 0,025
$M_2$	0,008 ÷ 0,020
$K_1$	0,020 ÷ 0,030
$K_2$	0,015 ÷ 0,030
$N_1$	0,020 ÷ 0,045
$N_2$	0,015 ÷ 0,035
$S_1$	0,010 ÷ 0,025
$S_2$	0,008 ÷ 0,020

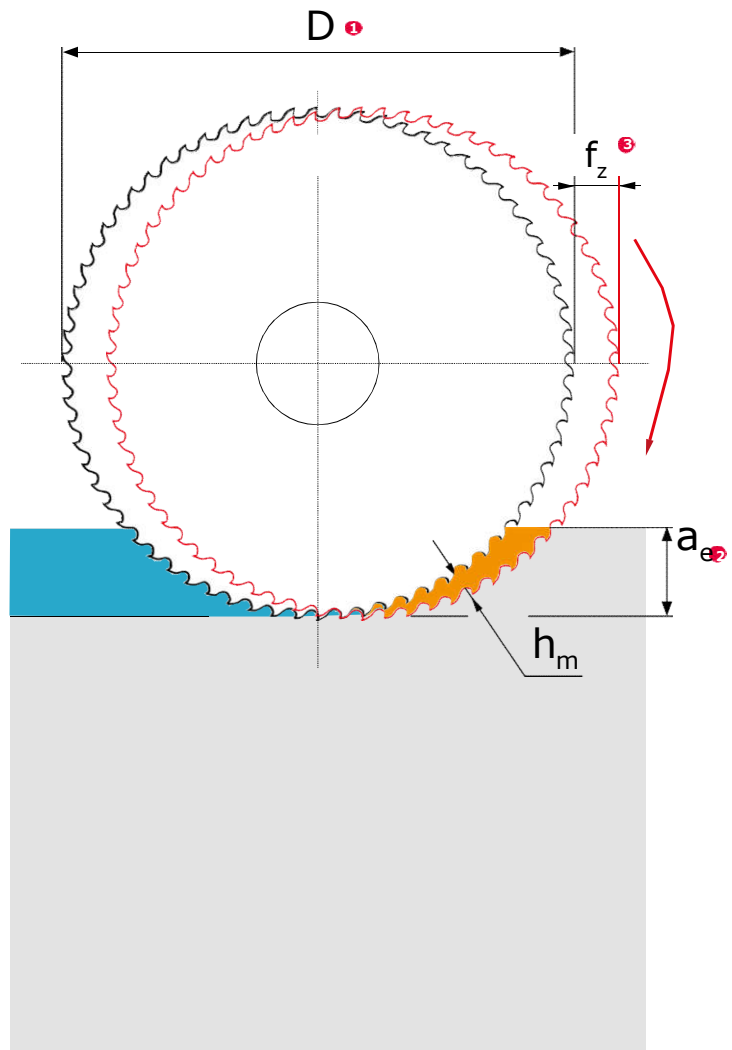

## TOLLERANZE COSTRUTTIVE SEGHE CIRCOLARI

TOLERANCES CIRCULAR SAW BLADES | BAUTOLERANZEN KREISSÄGEBLÄTTER  
 TOLÉRANCES DE CONSTRUCTIONS FRAISES SCIÉS | TOLERANCIAS DE CONSTRUCCIÓN SIERRA CIRCULARES

### UNI DIN 1837 A - DIN 1838 B

D	Tolleranze (D)   Tolerances (D) Toleranzen (D)   Tolérances (D) Tolerancias (D)		Tolleranze (b)   Tolerances (b) Toleranzen (b)   Tolérances (b) Tolerancias (b)	
	HM	HSS-Co5	HM	HSS-Co5
10÷18 mm	±0.35 mm	±0.35 mm	- 0,005 mm + 0,015 mm	±0.02 mm
18÷30 mm	±0.42 mm	±0.42 mm	- 0,005 mm + 0,015 mm	±0.02 mm
30÷50 mm	±0.50 mm	±0.50 mm	- 0,005 mm + 0,015 mm	±0.02 mm
50÷80 mm	±0.60 mm	±0.60 mm	- 0,005 mm + 0,015 mm	±0.02 mm
80÷120 mm	±0.70 mm	±0.70 mm	- 0,005 mm + 0,015 mm	±0.02 mm
120÷180 mm	±0.80 mm	±0.80 mm	- 0,005 mm + 0,015 mm	±0.02 mm
180÷250 mm	±0.92 mm	±0.92 mm	- 0,005 mm + 0,015 mm	±0.02 mm
250÷400 mm	±1.00 mm	±1.00 mm	- 0,005 mm + 0,015 mm	±0.02 mm

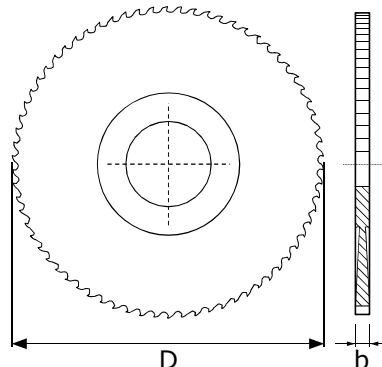

## RIVESTIMENTI E AFFILATURE SPECIALI A RICHIESTA

SPECIAL COATINGS AND SHARPENINGS ON REQUEST | BESCHICHTUNGEN UND SONDRSCHLEIFEN AUF ANFRAGE  
 REVÊTEMENTS ET AFFÛTAGES SPÉCIAUX SUR DEMANDE | RECUBRIMIENTOS Y AFILADOS ESPECIALES BAJO DEMANDA

### ■ Rivestimento |Coating |Beschichtung |Revêtement |Recubrimiento

TiN

TiCN

TiAlN

### ■ Affilature speciali | Special sharpening | Sonderschleifen | Affûtages spéciaux | Afilado especial

VP ▶

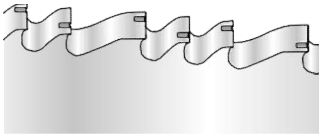

- **Passo variabile utilizzato per il taglio di sezioni molto irregolari che causano forti vibrazioni e rumorosità di taglio.**
- Variable pitch used to cut very irregular sections which cause severe vibrations and noises.
- Variozahn ist geeignet zum Schneiden sehr unregelmäßiger Abschnitte, die starke Vibrationen und Lärm verursachen.
- Pas variable utilisé pour la coupe de sections très irrégulières qui causent fortes vibrations et bruit.
- Paso variable utilizado para secciones de corte muy irregulares que causan grandes vibraciones y ruidos de corte.

AW ▶

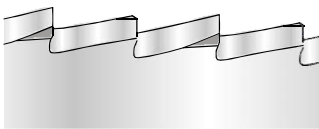

- **Aggiunge al dente standard lo smusso che consente una migliore frantumazione del truciolo.**
- Add to the standard tooth the bevel that allow to optimize the chip shredding.
- Wie Standard Zahn jedoch mit zusätzlicher Fase, was eine bessere Spanteilung garantiert.
- Ajoute au dent standard le chanfrein qui permet une meilleure écrasement du copeau.
- Añade al diente estándar el chaflán que permite una mejor fragmentación de las virutas.

HZ ▶

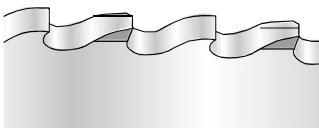

- **Utilizzato per il taglio di solidi o tubi di spessore grosso (>3mm).**
- Used in the solid cutting or to cut thick (>3mm) pipes.
- Geeignet zum Schneiden von Vollmaterialien und Röhren mit dicker Wandstärke(>3mm).
- Utilisé pour la coupe de solides or tuyaux de grande épaisseur (>3mm).
- Utilizado para el corte de sólidos o de tubos con gran grosor (>3mm).

BR ▶

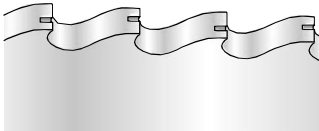

- **Miglior forma dente per il taglio di tubi su macchine automatiche.**
- Best tooth shape to cut pipe on automatic machines.
- Beste Zahnform zum Schneiden von Röhren auf automatische Maschinen.
- Meilleure forme du dent pour la coupe de tuyaux sur machines automatiques.
- Mejor forma del diente para el corte de tubos con máquinas automáticas

BW ▶

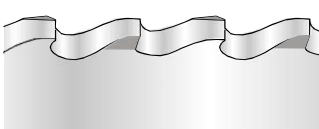

- **Forma standard per il taglio di tubi.**
- Standard tooth shape for the pipe cutting.
- Standard-Zahnform zum Schneiden von Röhren.
- Forme standard pour la coupe de tuyaux.
- Forma estandard para el corte de tubos.





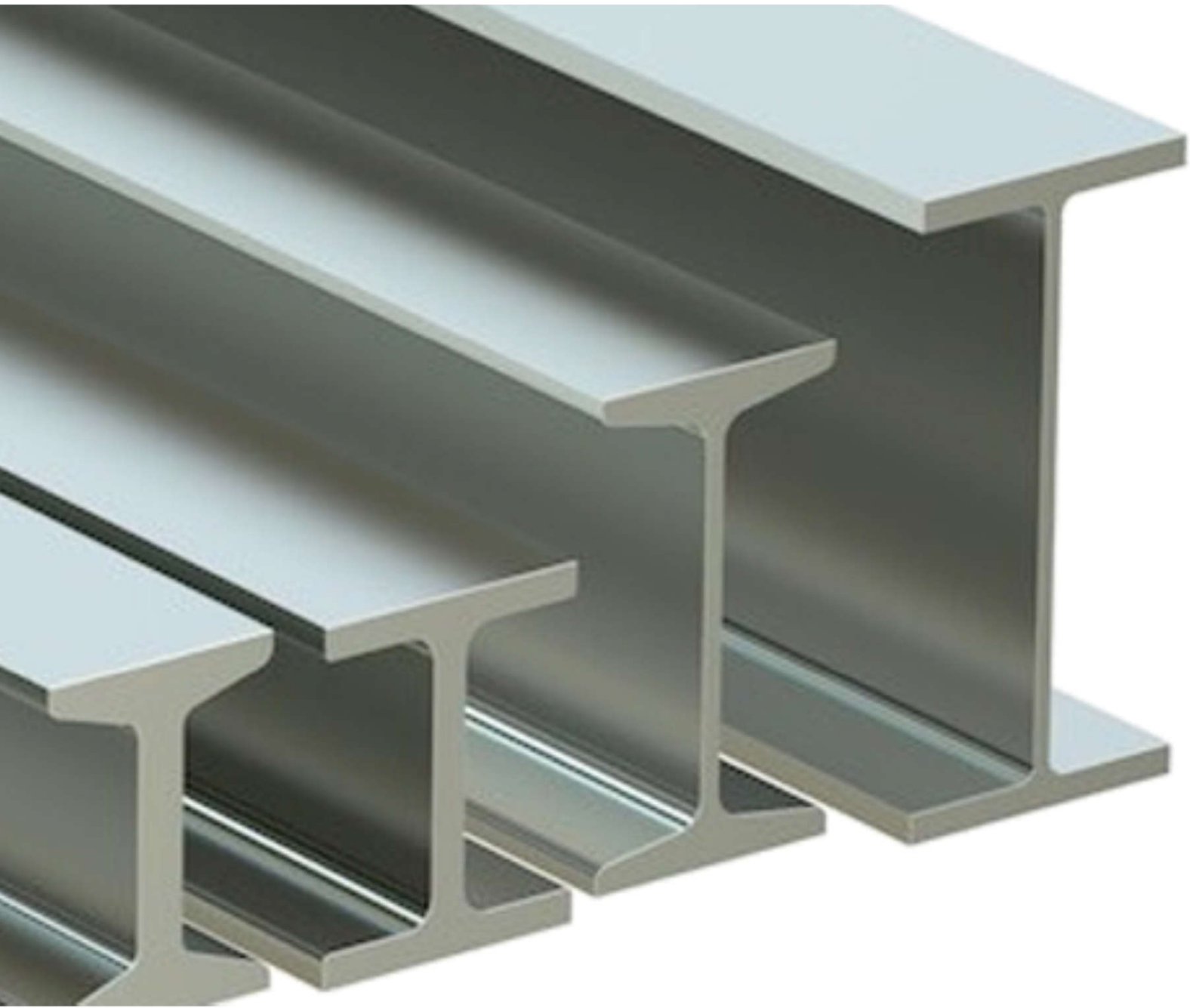

# CARBIDE TIPPED ANNULAE CUTTER WITH UNIVERSAL SHANK

\* Carbide annular cutter with universal shank

## MGX35N Type

Model	MGX35N	MGX50N	MGX75N	MGX100N
Diameter/D (mm )	Ø12-100	Ø12-65	Ø14-65	Ø14-65
Cutting Depl't L (mm )	35	50	75	100

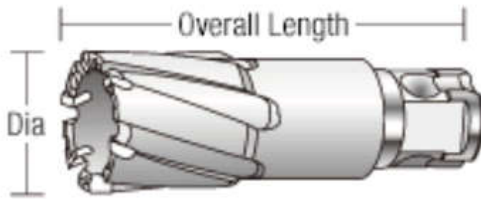

Model	Dia	L	Model	Dia	L	Model	Dia	L
MGX35N	12	35	MGX35N	27	35	MGX35N	42	35
MGX35N	13	35	MGX35N	28	35	MGX35N	43	35
MGX35N	14	35	MGX35N	29	35	MGX35N	44	35
MGX35N	15	35	MGX35N	30	35	MGX35N	45	35
MGX35N	16	35	MGX35N	31	35	MGX35N	46	35
MGX35N	17	35	MGX35N	32	35	MGX35N	47	35
MGX35N	18	35	MGX35N	33	35	MGX35N	48	35
MGX35N	19	35	MGX35N	34	35	MGX35N	49	35
MGX35N	20	35	MGX35N	35	35	MGX35N	50	35
MGX35N	21	35	MGX35N	36	35	MGX35N	51	35
MGX35N	22	35	MGX35N	37	35	MGX35N	52	35
MGX35N	23	35	MGX35N	38	35	MGX35N	53	35
MGX35N	24	35	MGX35N	39	35	MGX35N	54	35
MGX35N	25	35	MGX35N	40	35	MGX35N	55	35
MGX35N	26	35	MGX35N	41	35	MGX35N	56	35

## Center Pin For MGX



Model	Dia(mm)	Overall Length(mm)	Hole Saw Size(mm)
PIN35-6	6.35	90	MGX35N 12.0~17.0
PIN35-8	7.98	90	MGX35N 18.0~65.0
PIN50-6	6.35	102	MGX50N 12.0~17.0
PIN50-8	7.98	102	MGX50N 18.0~65.0
PIN75-6	6.35	130	MGX75N 12.0~17.0
PIN75-8	7.98	130	MGX75N 18.0~65.0
PIN100-6	6.35	160	MGX100N 12.0~17.0
PIN100-8	7.98	160	MGX100N 18.0~65.0

Ordering example | : **Model - ( D x L )**  
| **Minimum order q.ty 10 pieces**



# CARBIDE TIPPED ANNULAE CUTTER WITH UNIVERSAL SHANK

\* Carbide annular cutter with universal shank

## MGX35N Type

Model	MGX35N	MGX50N	MGX75N	MGX100N
Diameter/D (mm )	Ø12-100	Ø12-65	Ø14-65	Ø14-65
Cutting Depl't L (mm )	35	50	75	100

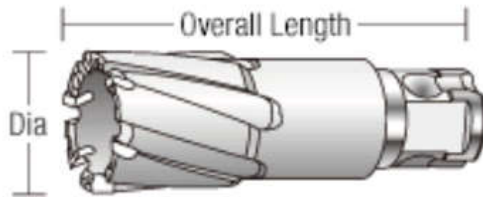

Model	Dia	L	Model	Dia	L	Model	Dia	L
MGX35N	57	35	MGX35N	73	35	MGX35N	88	35
MGX35N	58	35	MGX35N	74	35	MGX35N	89	35
MGX35N	59	35	MGX35N	75	35	MGX35N	90	35
MGX35N	60	35	MGX35N	76	35	MGX35N	91	35
MGX35N	61	35	MGX35N	77	35	MGX35N	92	35
MGX35N	62	35	MGX35N	78	35	MGX35N	93	35
MGX35N	63	35	MGX35N	79	35	MGX35N	94	35
MGX35N	64	35	MGX35N	80	35	MGX35N	95	35
MGX35N	65	35	MGX35N	81	35	MGX35N	96	35
MGX35N	66	35	MGX35N	82	35	MGX35N	97	35
MGX35N	67	35	MGX35N	83	35	MGX35N	98	35
MGX35N	68	35	MGX35N	84	35	MGX35N	99	35
MGX35N	69	35	MGX35N	85	35	MGX35N	100	35
MGX35N	70	35	MGX35N	86	35	MGX35N		
MGX35N	71	35	MGX35N	87	35	MGX35N		

## Center Pin For MGX



Model	Dia(mm)	Overall Length(mm)	Hole Saw Size(mm)
PIN35-6	6.35	90	MGX35N 12.0~17.0
PIN35-8	7.98	90	MGX35N 18.0~65.0
PIN50-6	6.35	102	MGX50N 12.0~17.0
PIN50-8	7.98	102	MGX50N 18.0~65.0
PIN75-6	6.35	130	MGX75N 12.0~17.0
PIN75-8	7.98	130	MGX75N 18.0~65.0
PIN100-6	6.35	160	MGX100N 12.0~17.0
PIN100-8	7.98	160	MGX100N 18.0~65.0

Ordering example | : **Model - ( D x L )**  
| **Minimum order q.ty 10 pieces**



# CARBIDE TIPPED ANNULAE CUTTER WITH UNIVERSAL SHANK

\* Carbide annular cutter with universal shank

## MGX50N Type

Model	MGX35N	MGX50N	MGX75N	MGX100N
Diameter/D (mm )	Ø12-100	Ø12-65	Ø14-65	Ø14-65
Cutting Depl't L (mm )	35	50	75	100

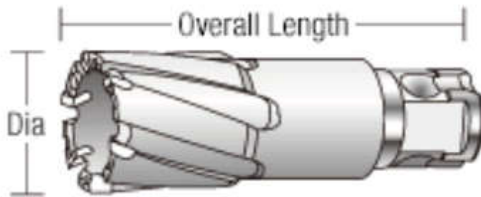

Model	Dia	L	Model	Dia	L	Model	Dia	L
MGX50N	12	50	MGX50N	27	50	MGX50N	42	50
MGX50N	13	50	MGX50N	28	50	MGX50N	43	50
MGX50N	14	50	MGX50N	29	50	MGX50N	44	50
MGX50N	15	50	MGX50N	30	50	MGX50N	45	50
MGX50N	16	50	MGX50N	31	50	MGX50N	46	50
MGX50N	17	50	MGX50N	32	50	MGX50N	47	50
MGX50N	18	50	MGX50N	33	50	MGX50N	48	50
MGX50N	19	50	MGX50N	34	50	MGX50N	49	50
MGX50N	20	50	MGX50N	35	50	MGX50N	50	50
MGX50N	21	50	MGX50N	36	50	MGX50N	51	50
MGX50N	22	50	MGX50N	37	50	MGX50N	52	50
MGX50N	23	50	MGX50N	38	50	MGX50N	53	50
MGX50N	24	50	MGX50N	39	50	MGX50N	54	50
MGX50N	25	50	MGX50N	40	50	MGX50N	55	50
MGX50N	26	50	MGX50N	41	50	MGX50N	56	50

## Center Pin For MGX



Model	Dia(mm)	Overall Length(mm)	Hole Saw Size(mm)
PIN35-6	6.35	90	MGX35N 12.0~17.0
PIN35-8	7.98	90	MGX35N 18.0~65.0
PIN50-6	6.35	102	MGX50N 12.0~17.0
PIN50-8	7.98	102	MGX50N 18.0~65.0
PIN75-6	6.35	130	MGX75N 12.0~17.0
PIN75-8	7.98	130	MGX75N 18.0~65.0
PIN100-6	6.35	160	MGX100N 12.0~17.0
PIN100-8	7.98	160	MGX100N 18.0~65.0

Ordering example | : **Model - ( D x L )**  
| **Minimum order qty 10 pieces**



# CARBIDE TIPPED ANNULAE CUTTER WITH UNIVERSAL SHANK

\* Carbide annular cutter with universal shank

## MGX50N Type

Model	MGX35N	MGX50N	MGX75N	MGX100N
Diameter/D (mm )	Ø12-100	Ø12-65	Ø14-65	Ø14-65
Cutting Depl't L (mm )	35	50	75	100

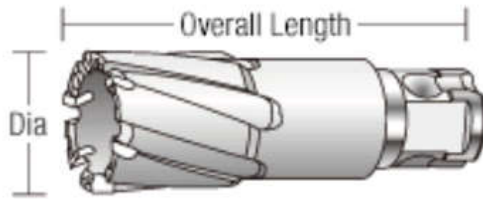

Model	Dia	L	Model	Dia	L	Model	Dia	L
MGX50N	57	50						
MGX50N	58	50						
MGX50N	59	50						
MGX50N	60	50						
MGX50N	61	50						
MGX50N	62	50						
MGX50N	63	50						
MGX50N	64	50						
MGX50N	65	50						

## Center Pin For MGX



Model	Dia(mm)	Overall Length(mm)	Hole Saw Size(mm)
PIN35-6	6.35	90	MGX35N 12.0~17.0
PIN35-8	7.98	90	MGX35N 18.0~65.0
PIN50-6	6.35	102	MGX50N 12.0~17.0
PIN50-8	7.98	102	MGX50N 18.0~65.0
PIN75-6	6.35	130	MGX75N 12.0~17.0
PIN75-8	7.98	130	MGX75N 18.0~65.0
PIN100-6	6.35	160	MGX100N 12.0~17.0
PIN100-8	7.98	160	MGX100N 18.0~65.0

Ordering example | : **Model - ( D x L )**  
| **Minimum order q.ty 10 pieces**





# CARBIDE TIPPED ANNULAE CUTTER WITH UNIVERSAL SHANK

\* Carbide annular cutter with universal shank

## MGX75N Type

Model	MGX35N	MGX50N	MGX75N	MGX100N
Diameter/D (mm )	Ø12-100	Ø12-65	Ø14-65	Ø14-65
Cutting Depl't L (mm )	35	50	75	100

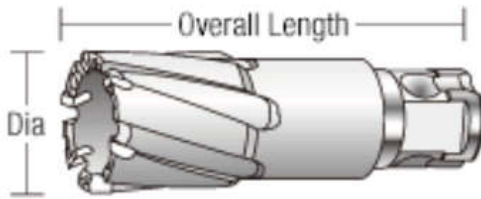

Model	Dia	L	Model	Dia	L	Model	Dia	L
MGX75N	12	75	MGX75N	27	75	MGX75N	42	75
MGX75N	13	75	MGX75N	28	75	MGX75N	43	75
MGX75N	14	75	MGX75N	29	75	MGX75N	44	75
MGX75N	15	75	MGX75N	30	75	MGX75N	45	75
MGX75N	16	75	MGX75N	31	75	MGX75N	46	75
MGX75N	17	75	MGX75N	32	75	MGX75N	47	75
MGX75N	18	75	MGX75N	33	75	MGX75N	48	75
MGX75N	19	75	MGX75N	34	75	MGX75N	49	75
MGX75N	20	75	MGX75N	35	75	MGX75N	50	75
MGX75N	21	75	MGX75N	36	75	MGX75N	51	75
MGX75N	22	75	MGX75N	37	75	MGX75N	52	75
MGX75N	23	75	MGX75N	38	75	MGX75N	53	75
MGX75N	24	75	MGX75N	39	75	MGX75N	54	75
MGX75N	25	75	MGX75N	40	75	MGX75N	55	75
MGX75N	26	75	MGX75N	41	75	MGX75N	56	75

## Center Pin For MGX



Model	Dia(mm)	Overall Length(mm)	Hole Saw Size(mm)
PIN35-6	6.35	90	MGX35N 12.0~17.0
PIN35-8	7.98	90	MGX35N 18.0~65.0
PIN50-6	6.35	102	MGX50N 12.0~17.0
PIN50-8	7.98	102	MGX50N 18.0~65.0
PIN75-6	6.35	130	MGX75N 12.0~17.0
PIN75-8	7.98	130	MGX75N 18.0~65.0
PIN100-6	6.35	160	MGX100N 12.0~17.0
PIN100-8	7.98	160	MGX100N 18.0~65.0

Ordering example | : **Model - ( D x L )**  
| **Minimum order qty 10 pieces**



# CARBIDE TIPPED ANNULAE CUTTER WITH UNIVERSAL SHANK

\* Carbide annular cutter with universal shank

## MGX75N Type

Model	MGX35N	MGX50N	MGX75N	MGX100N
Diameter/D (mm )	Ø12-100	Ø12-65	Ø14-65	Ø14-65
Cutting Depl't L (mm )	35	50	75	100

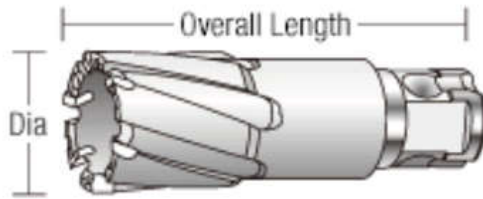

Model	Dia	L	Model	Dia	L	Model	Dia	L
MGX75N	57	75						
MGX75N	58	75						
MGX75N	59	75						
MGX75N	60	75						
MGX75N	61	75						
MGX75N	62	75						
MGX75N	63	75						
MGX75N	64	75						
MGX75N	65	75						

## Center Pin For MGX



Model	Dia(mm)	Overall Length(mm)	Hole Saw Size(mm)
PIN35-6	6.35	90	MGX35N 12.0~17.0
PIN35-8	7.98	90	MGX35N 18.0~65.0
PIN50-6	6.35	102	MGX50N 12.0~17.0
PIN50-8	7.98	102	MGX50N 18.0~65.0
PIN75-6	6.35	130	MGX75N 12.0~17.0
PIN75-8	7.98	130	MGX75N 18.0~65.0
PIN100-6	6.35	160	MGX100N 12.0~17.0
PIN100-8	7.98	160	MGX100N 18.0~65.0

Ordering example | : **Model - ( D x L )**  
| **Minimum order q.ty 10 pieces**



# CARBIDE TIPPED ANNULAE CUTTER WITH UNIVERSAL SHANK

\* Carbide annular cutter with universal shank

## MGX100N Type

Model	MGX35N	MGX50N	MGX75N	MGX100N
Diameter/D (mm )	Ø12-100	Ø12-65	Ø14-65	Ø14-65
Cutting Depl't L (mm )	35	50	75	100

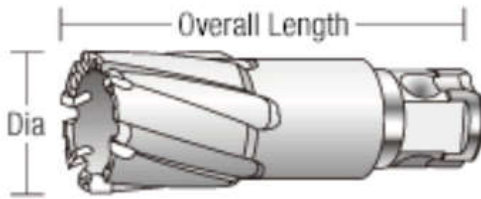

Model	Dia	L	Model	Dia	L	Model	Dia	L
MGX100N	12	100	MGX100N	27	100	MGX100N	42	100
MGX100N	13	100	MGX100N	28	100	MGX100N	43	100
MGX100N	14	100	MGX100N	29	100	MGX100N	44	100
MGX100N	15	100	MGX100N	30	100	MGX100N	45	100
MGX100N	16	100	MGX100N	31	100	MGX100N	46	100
MGX100N	17	100	MGX100N	32	100	MGX100N	47	100
MGX100N	18	100	MGX100N	33	100	MGX100N	48	100
MGX100N	19	100	MGX100N	34	100	MGX100N	49	100
MGX100N	20	100	MGX100N	35	100	MGX100N	50	100
MGX100N	21	100	MGX100N	36	100	MGX100N	51	100
MGX100N	22	100	MGX100N	37	100	MGX100N	52	100
MGX100N	23	100	MGX100N	38	100	MGX100N	53	100
MGX100N	24	100	MGX100N	39	100	MGX100N	54	100
MGX100N	25	100	MGX100N	40	100	MGX100N	55	100
MGX100N	26	100	MGX100N	41	100	MGX100N	56	100

## Center Pin For MGX



Model	Dia(mm)	Overall Length(mm)	Hole Saw Size(mm)
PIN35-6	6.35	90	MGX35N 12.0~17.0
PIN35-8	7.98	90	MGX35N 18.0~65.0
PIN50-6	6.35	102	MGX50N 12.0~17.0
PIN50-8	7.98	102	MGX50N 18.0~65.0
PIN75-6	6.35	130	MGX75N 12.0~17.0
PIN75-8	7.98	130	MGX75N 18.0~65.0
PIN100-6	6.35	160	MGX100N 12.0~17.0
PIN100-8	7.98	160	MGX100N 18.0~65.0

Ordering example | : **Model - ( D x L )**  
| **Minimum order q.ty 10 pieces**



# CARBIDE TIPPED ANNULAE CUTTER WITH UNIVERSAL SHANK

\* Carbide annular cutter with universal shank

## MGX100N Type

Model	MGX35N	MGX50N	MGX75N	MGX100N
Diameter/D (mm )	Ø12-100	Ø12-65	Ø14-65	Ø14-65
Cutting Depl't L (mm )	35	50	75	100

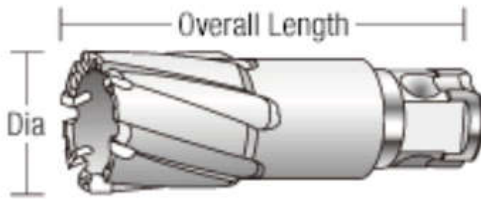

Model	Dia	L	Model	Dia	L	Model	Dia	L
MGX100N	57	100						
MGX100N	58	100						
MGX100N	59	100						
MGX100N	60	100						
MGX100N	61	100						
MGX100N	62	100						
MGX100N	63	100						
MGX100N	64	100						
MGX100N	65	100						

## Center Pin For MGX



Model	Dia(mm)	Overall Length(mm)	Hole Saw Size(mm)
PIN35-6	6.35	90	MGX35N 12.0~17.0
PIN35-8	7.98	90	MGX35N 18.0~65.0
PIN50-6	6.35	102	MGX50N 12.0~17.0
PIN50-8	7.98	102	MGX50N 18.0~65.0
PIN75-6	6.35	130	MGX75N 12.0~17.0
PIN75-8	7.98	130	MGX75N 18.0~65.0
PIN100-6	6.35	160	MGX100N 12.0~17.0
PIN100-8	7.98	160	MGX100N 18.0~65.0

Ordering example | : **Model - ( D x L )**  
| **Minimum order q.ty 10 pieces**



## CARBIDE TIPPED ANNULAE CUTTER WITH UNIVERSAL SHANK

### \* Shank Assembly - Side Lock



Model	Dia Hole Clamping	Hole Saw Size(mm)	Depth cutting L1
MGX-MT2	19.05	Ø11-100	50
MGX-MT3	19.05	Ø17-65	50
MGX-MT4	19.05	Ø11-100	50
MGX-MT5	19.05	Ø17-65	50
MGX-MT2	19.05	Ø11-100	75
MGX-MT3	19.05	Ø17-65	75
MGX-MT4	19.05	Ø11-100	75
MGX-MT5	19.05	Ø17-65	75
MGX-MT2	19.05	Ø11-100	100
MGX-MT3	19.05	Ø17-65	100
MGX-MT4	19.05	Ø11-100	100
MGX-MT5	19.05	Ø17-65	100

Ordering example | : **Model - ( D x L )**  
 | **Minimum order q.ty 10 pieces**





# CARBIDE TIPPED THICK PLATE HOLE SAW WITH TRIANGLE SHANK

\* Carbide Tips cutter with Triangle shank

## MGTR ( 25mm )Type

Model	MGTR	MGTL
Diameter/D ( mm )	Ø12-150	Ø19-100
Cutting Depl L ( mm )	25	50
Dia shank Shape d ( mm )	Ø12-69 : d = 10mm Ø70-150 : d = 13mm	Ø19-69 : d = 10mm Ø70-100 : d = 13mm

- Newly developed step center drill .
- Cutting waste drainage groove .
- It is applicable to drilling through 25mm, 50mm height round tube, square tube, thin plate and other metal materials.

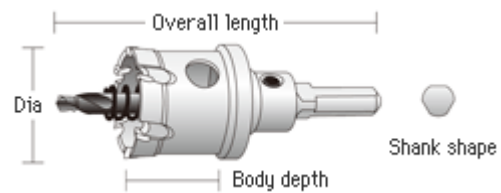

Model	Dia	L	Model	Dia	L	Model	Dia	L
MGTR	12	25	MGTR	36	25	MGTR	60	25
MGTR	13	25	MGTR	37	25	MGTR	61	25
MGTR	14	25	MGTR	38	25	MGTR	62	25
MGTR	15	25	MGTR	39	25	MGTR	63	25
MGTR	16	25	MGTR	40	25	MGTR	64	25
MGTR	17	25	MGTR	41	25	MGTR	65	25
MGTR	18	25	MGTR	42	25	MGTR	66	25
MGTR	19	25	MGTR	43	25	MGTR	67	25
MGTR	20	25	MGTR	44	25	MGTR	68	25
MGTR	21	25	MGTR	45	25	MGTR	69	25
MGTR	22	25	MGTR	46	25	MGTR	70	25
MGTR	23	25	MGTR	47	25	MGTR	71	25
MGTR	24	25	MGTR	48	25	MGTR	72	25
MGTR	25	25	MGTR	49	25	MGTR	73	25
MGTR	26	25	MGTR	50	25	MGTR	74	25
MGTR	27	25	MGTR	51	25	MGTR	75	25
MGTR	28	25	MGTR	52	25	MGTR	76	25
MGTR	29	25	MGTR	53	25	MGTR	77	25
MGTR	30	25	MGTR	54	25	MGTR	78	25
MGTR	31	25	MGTR	55	25	MGTR	79	25
MGTR	32	25	MGTR	56	25	MGTR	80	25
MGTR	33	25	MGTR	57	25	MGTR	81	25
MGTR	34	25	MGTR	58	25	MGTR	82	25
MGTR	35	25	MGTR	59	25	MGTR	83	25

Ordering example | : Model - ( D x L )

| Minimum order q.ty 10 pieces



## CARBIDE TIPPED THICK PLATE HOLE SAW WITH TRIANGLE SHANK

\* Carbide Tips cutter with Triangle shank

### MGTR ( 25mm )Type

Model	MGTR	MGTL
Diameter/D ( mm )	Ø12-150	Ø19-100
Cutting Depl L ( mm )	25	50
Dia shank Shape d ( mm )	Ø12-69 : d = 10mm Ø70-150 : d = 13mm	Ø19-69 : d = 10mm Ø70-100 : d = 13mm

- Newly developed step center drill .
- Cutting waste drainage groove .
- It is applicable to drilling through 25mm, 50mm height round tube, square tube, thin plate and other metal materials.

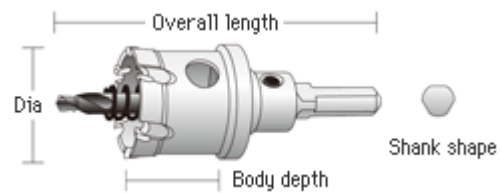

Model	Dia	L	Model	Dia	L	Model	Dia	L
MGTR	84	25	MGTR	108	25	MGTR	132	25
MGTR	85	25	MGTR	109	25	MGTR	133	25
MGTR	86	25	MGTR	110	25	MGTR	134	25
MGTR	87	25	MGTR	111	25	MGTR	135	25
MGTR	88	25	MGTR	112	25	MGTR	136	25
MGTR	89	25	MGTR	113	25	MGTR	137	25
MGTR	90	25	MGTR	114	25	MGTR	138	25
MGTR	91	25	MGTR	115	25	MGTR	139	25
MGTR	92	25	MGTR	116	25	MGTR	140	25
MGTR	93	25	MGTR	117	25	MGTR	141	25
MGTR	94	25	MGTR	118	25	MGTR	142	25
MGTR	95	25	MGTR	119	25	MGTR	143	25
MGTR	96	25	MGTR	120	25	MGTR	144	25
MGTR	97	25	MGTR	121	25	MGTR	145	25
MGTR	98	25	MGTR	122	25	MGTR	146	25
MGTR	99	25	MGTR	123	25	MGTR	147	25
MGTR	100	25	MGTR	124	25	MGTR	148	25
MGTR	101	25	MGTR	125	25	MGTR	149	25
MGTR	102	25	MGTR	126	25	MGTR	150	25
MGTR	103	25	MGTR	127	25			
MGTR	104	25	MGTR	128	25			
MGTR	105	25	MGTR	129	25			
MGTR	106	25	MGTR	130	25			
MGTR	107	25	MGTR	131	25			

Ordering example | : **Model - ( D x L )**

| **Minimum order q.ty 10 pieces**



# CARBIDE TIPPED THICK PLATE HOLE SAW WITH TRIANGLE SHANK

\* Carbide Tips cutter with Triangle shank

## MGTL( 50mm )Type

Model	MGTR	MGTL
Diameter/D ( mm )	Ø12-150	Ø19-100
Cutting Depl't L ( mm )	25	50
Dia shank Shape d ( mm )	Ø12-69 : d = 10mm Ø70-150 : d = 13mm	Ø19-69 : d = 10mm Ø70-100 : d = 13mm

- Newly developed step center drill .
- Cutting waste drainage groove .
- It is applicable to drilling through 25mm, 50mm height round tube, square tube, thin plate and other metal materials.

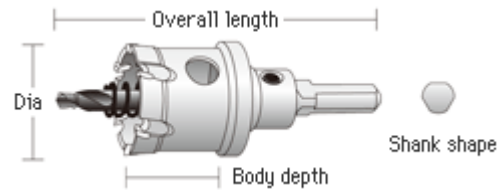

Model	Dia	L	Model	Dia	L	Model	Dia	L
MGTL	19	50	MGTL	47	50	MGTL	76	50
MGTL	20	50	MGTL	48	50	MGTL	77	50
MGTL	21	50	MGTL	49	50	MGTL	78	50
MGTL	22	50	MGTL	50	50	MGTL	79	50
MGTL	23	50	MGTL	51	50	MGTL	80	50
MGTL	24	50	MGTL	52	50	MGTL	81	50
MGTL	25	50	MGTL	53	50	MGTL	82	50
MGTL	26	50	MGTL	54	50	MGTL	83	50
MGTL	27	50	MGTL	55	50	MGTL	84	50
MGTL	28	50	MGTL	56	50	MGTL	85	50
MGTL	29	50	MGTL	57	50	MGTL	86	50
MGTL	30	50	MGTL	58	50	MGTL	87	50
MGTL	31	50	MGTL	59	50	MGTL	88	50
MGTL	32	50	MGTL	60	50	MGTL	89	50
MGTL	33	50	MGTL	61	50	MGTL	90	50
MGTL	34	50	MGTL	62	50	MGTL	91	50
MGTL	35	50	MGTL	63	50	MGTL	92	50
MGTL	36	50	MGTL	64	50	MGTL	93	50
MGTL	37	50	MGTL	65	50	MGTL	94	50
MGTL	38	50	MGTL	66	50	MGTL	95	50
MGTL	39	50	MGTL	67	50	MGTL	96	50
MGTL	40	50	MGTL	68	50	MGTL	97	50
MGTL	41	50	MGTL	69	50	MGTL	98	50
MGTL	42	50	MGTL	70	50	MGTL	99	50
MGTL	43	50	MGTL	71	50	MGTL	100	50
MGTL	44	50	MGTL	72	50			
MGTL	45	50	MGTL	73	50			
MGTL	46	50	MGTL	74	50			

Ordering example | : Model - ( D x L )

| Minimum order q.ty 10 pieces



# MEGACUT

## BROACHING TOOL

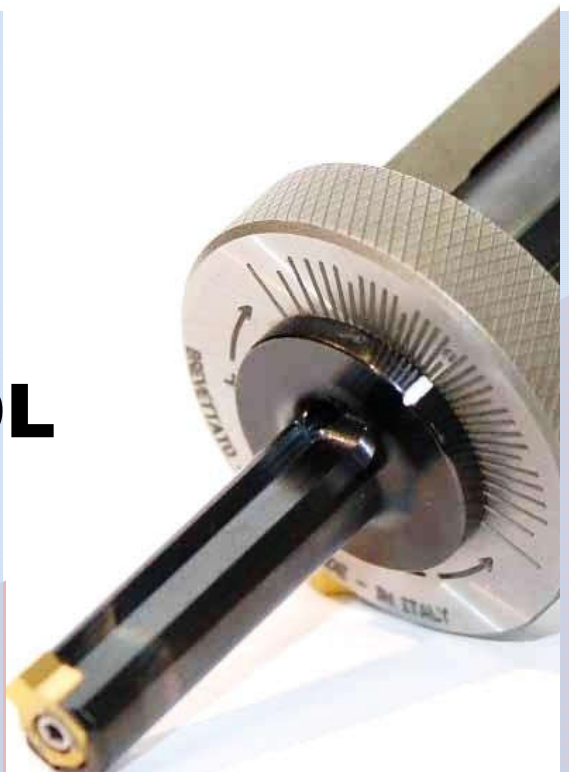

## BROACHING TOOL

### TOOLS FOR INTERNAL





## BROACHING TOOL

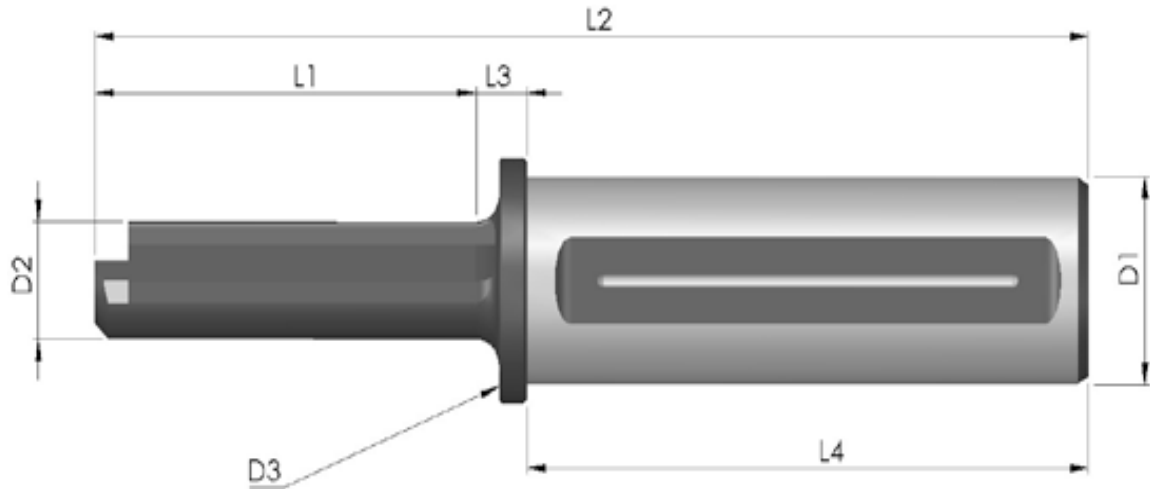

Model	L1 (mm)	L2 (mm)	L3 (mm)	L4 (mm)	D1 (mm)	D2 (mm)	D3 (mm)	Screwdriver	Minimum hole (mm)
UT-02-25*	25	124	9	90	25	6	30	T08	7
UT-02-25-L*	34,5	133,5	9	90	25	6	30	T08	7
UT-02-32*	25	134	9	100	32	6	37	T08	7
UT-02-32-L*	34,5	143,5	9	100	32	6	37	T08	7
UT-03-25*	30	129	9	90	25	8	30	T08	8,7
UT-03-25-L*	40	139	9	90	25	8	30	T08	8,7
UT-03-32*	30	139	9	100	32	8	37	T08	8,7
UT-03-32-L*	40	149	9	100	32	8	37	T08	8,7
UT-04-25*	40	139	9	90	25	10	30	T08	11
UT-04-25-L*	56	155	9	90	25	10	30	T08	11
UT-04-32*	40	149	9	100	32	10	37	T08	11
UT-04-32-L*	56	165	9	100	32	10	37	T08	11
UT-05-25*	46	145	9	90	25	12	30	T08	13
UT-05-25-L*	66	165	9	90	25	12	30	T08	13
UT-05-32*	46	155	9	100	32	12	37	T08	13
UT-05-32-L*	66	175	9	100	32	12	37	T08	13
UT-06-25*	56	155	9	90	25	16	30	T15	17
UT-06-25-L*	81	180	9	90	25	16	30	T15	17
UT-06-32*	56	165	9	100	32	16	37	T15	17
UT-06-32-L*	81	190	9	100	32	16	37	T15	17
UT-08-25*	68	167	9	90	25	20	30	T15	21,5
UT-08-25-L*	100	199	9	90	25	20	30	T15	21,5

Ordering example | : **Model**



## BROACHING TOOL

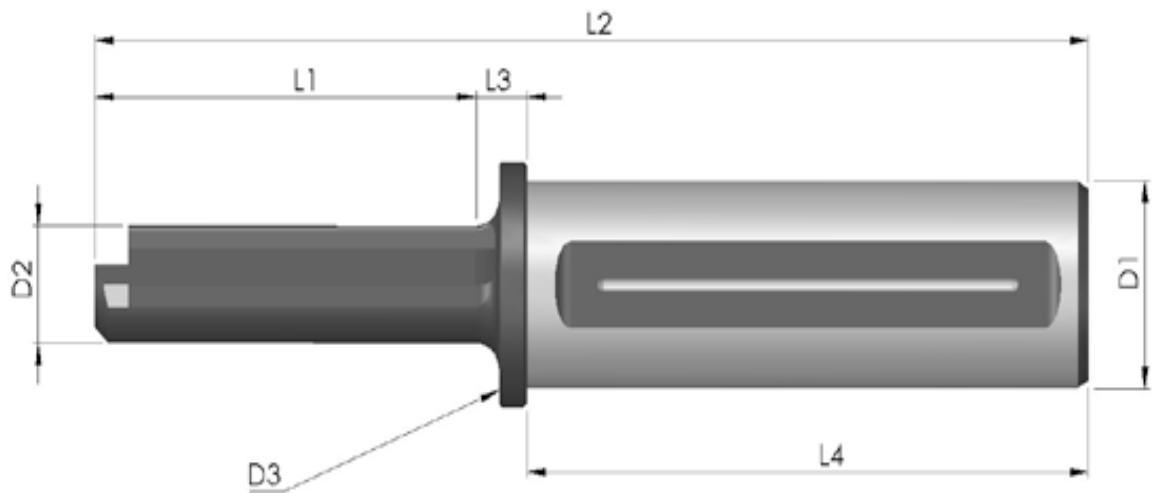

Model	L1 (mm)	L2 (mm)	L3 (mm)	L4 (mm)	D1 (mm)	D2 (mm)	D3 (mm)	Screwdriver	Minimum hole (mm)
UT-08-32*	68	177	9	100	32	20	37	T15	21,5
UT-08-32-L*	100	209	9	100	32	20	37	T15	21,5
UT-10-25	86	185	9	90	25	25	32	T20	28
UT-10-25-L	126	225	9	90	25	25	32	T20	28
UT-10-32*	86	195	9	100	32	25	37	T20	28
UT-10-32-L*	126	235	9	100	32	25	37	T20	28
UT-12-25	104	203	9	90	25	30	35	T20	32
UT-12-25-L	161	260	9	90	25	30	35	T20	32
UT-12-32*	104	213	9	100	32	30	37	T20	32
UT-12-32-L*	161	270	9	100	32	30	37	T20	32
UT-14/16-25	126	225	9	90	25	35	37	T20	37
UT-14/16-25-L	180	279	9	90	25	35	37	T20	37
UT-14/16-32	126	235	9	100	32	35	37	T20	37
UT-14/16-32-L	180	289	9	100	32	35	37	T20	37
UT-18/25-32	140	249	9	100	32	40	45	BRUG.5	45
UT-18/25-32-L	200	309	9	100	32	40	45	BRUG.5	45

Ordering example | : **Model**



## BROACHING TOOL

### INSERTS (MM)

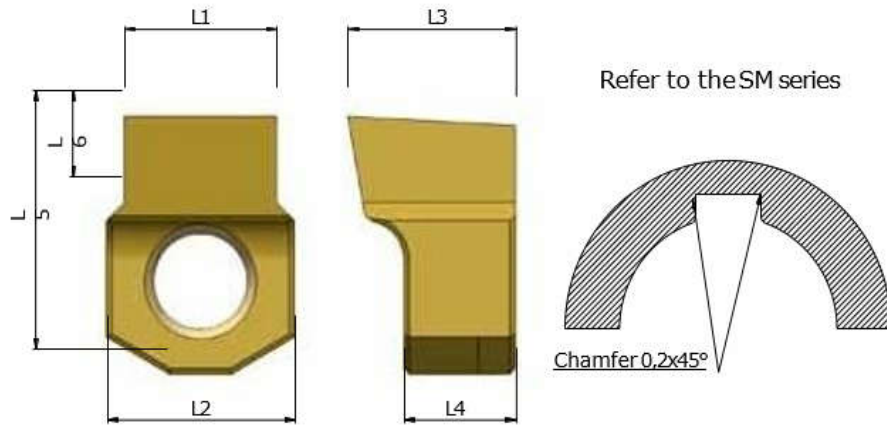

Model	L1 (mm)	L2 (mm)	L3 (mm)	L4 (mm)	L5 (mm)	L6 (mm)	Tool
IN-02 P9	1,994	5	6,5	5	6	1,3	UT-02
IN-02 P9-SM	1,994	5	6,5	5	6	1,09	UT-02
IN-02 H7	2,010	5	6,5	5	6	1,3	UT-02
IN-02 H7-SM	2,010	5	6,5	5	6	1,09	UT-02
IN-02 D10	2,060	5	6,5	5	6	1,3	UT-02
IN-02 C11	2,120	5	6,5	5	6	1,3	UT-02
IN-03 P9	2,994	6,08	6,5	5	7,5	2	UT-03
IN-03 P9-SM	2,994	6,08	6,5	5	7,5	1,42	UT-03
IN-03 H7	3,010	6,08	6,5	5	7,5	2	UT-03
IN-03 H7-SM	3,010	6,08	6,5	5	7,5	1,42	UT-03
IN-03 D10	3,06	6,08	6,5	5	7,5	2	UT-03
IN-03 C11	3,120	6,08	6,5	5	7,5	2	UT-03
IN-04 P9	3,988	6,08	7	5	8	2,6	UT-04
IN-04 P9-SM	3,988	6,08	7	5	8	2,07	UT-04
IN-04 H7	4,012	6,08	7	5	8	2,6	UT-04
IN-04 H7-SM	4,012	6,08	7	5	8	2,07	UT-04
IN-04 D10	4,078	6,08	7	5	8	2,6	UT-04
IN-04 C11	4,145	6,08	7	5	8	2,6	UT-04
IN-05 P9	4,988	6,08	7	5	8	3	UT-05
IN-05 P9-SM	4,988	6,08	7	5	8	2,74	UT-05
IN-05 H7	5,012	6,08	7	5	8	3	UT-05
IN-05 H7-SM	5,012	6,08	7	5	8	2,74	UT-05
IN-05 D10	5,078	6,08	7	5	8	3	UT-05
IN-05 C11	5,145	6,08	7	5	8	3	UT-05
IN-06 P9	5,988	10,08	9	6	13,5	4	UT-06
IN-06 P9-SM	5,988	10,08	9	6	13,5	3	UT-06
IN-06 H7	6,012	10,08	9	6	13,5	4	UT-06
IN-06 H7-SM	6,012	10,08	9	6	13,5	3	UT-06
IN-06 D10	6,078	10,08	9	6	13,5	4	UT-06
IN-06 C11	6,145	10,08	9	6	13,5	4	UT-06

Ordering example | : **Model**



## BROACHING TOOL

### INSERTS (MM)

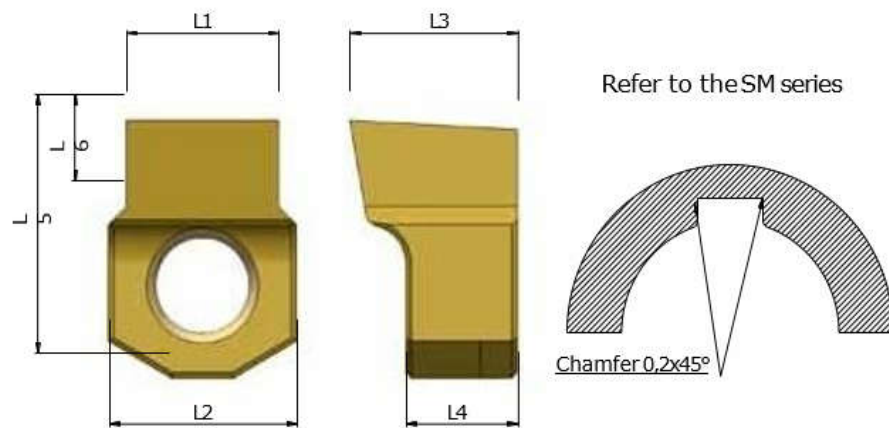

Model	L1 (mm)	L2 (mm)	L3 (mm)	L4 (mm)	L5 (mm)	L6 (mm)	Tool
IN-08 P9	7,985	10,08	9	6	13,5	4,5	UT-08
IN-08 P9-SM	7,985	10,08	9	6	13,5	3,78	UT-08
IN-08 H7	8,015	10,08	9	6	13,5	4,5	UT-08
IN-08 H7-SM	8,015	10,08	9	6	13,5	3,78	UT-08
IN-08 D10	8,098	10,08	9	6	13,5	4,5	UT-08
IN-08 C11	8,170	10,08	9	6	13,5	4,5	UT-08
IN-10 P9	9,985	13,1	14	10	18,5	6	UT-10
IN-10 P9-SM	9,985	13,1	14	10	18,5	3,88	UT-10
IN-10 H7	10,015	13,1	14	10	18,5	6	UT-10
IN-10 H7-SM	10,015	13,1	14	10	18,5	3,88	UT-10
IN-10 D10	10,098	13,1	14	10	18,5	6	UT-10
IN-10 C11	10,170	13,1	14	10	18,5	6	UT-10
IN-12 P9	11,982	13,1	14	10	18,5	6,5	UT-12
IN-12 P9-SM	11,982	13,1	14	10	18,5	3,89	UT-12
IN-12 H7	12,018	13,1	14	10	18,5	6,5	UT-12
IN-12 H7-SM	12,018	13,1	14	10	18,5	3,89	UT-12
IN-12 D10	12,12	13,1	14	10	18,5	6,5	UT-12
IN-12 C11	12,205	13,1	14	10	18,5	6,5	UT-12
IN-14 P9	13,982	18	14	10	22	7	UT-14/16
IN-14 P9-SM	13,982	18	14	10	22	4,71	UT-14/16
IN-14 H7	14,018	18	14	10	22	7	UT-14/16
IN-14 H7-SM	14,018	18	14	10	22	4,71	UT-14/16
IN-14 D10	14,120	18	14	10	22	7	UT-14/16
IN-14 C11	14,205	18	14	10	22	7	UT-14/16
IN-16 P9	15,982	18	14	10	22	8	UT-14/16
IN-16 P9-SM	15,982	18	14	10	22	5,53	UT-14/16
IN-16 H7	16,018	18	14	10	22	8	UT-14/16
IN-16 H7-SM	16,018	18	14	10	22	5,53	UT-14/16
IN-16 D10	16,120	18	14	10	22	8	UT-14/16
IN-16 C11	16,205	18	14	10	22	8	UT-14/16

Ordering example | : **Model**



## BROACHING TOOL

### INSERTS (MM)

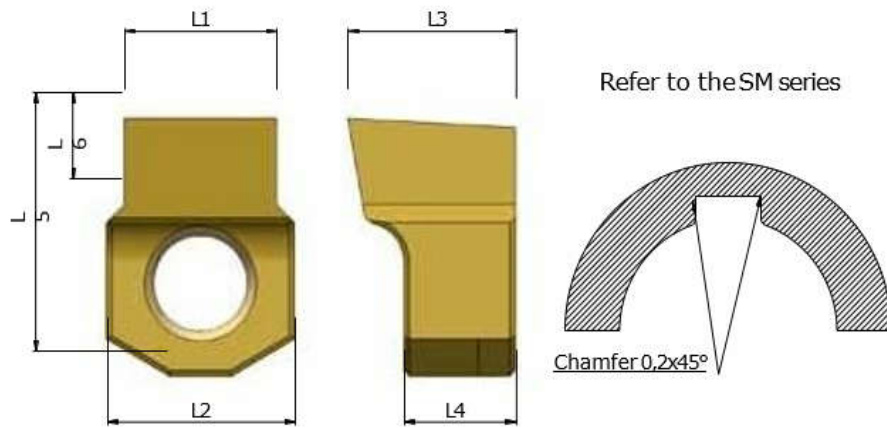

Model	L1 (mm)	L2 (mm)	L3 (mm)	L4 (mm)	L5 (mm)	L6 (mm)	Tool
IN-18P9**	17,982	26	18	10	30	9	UT-18/25
IN-18 P9-SM**	17,982	26	18	10	30	5,67	UT-18/25
IN-18H7**	18,018	26	18	10	30	9	UT-18/25
IN-18H7-SM**	18,018	26	18	10	30	5,67	UT-18/25
IN-18D10**	18,120	26	18	10	30	9	UT-18/25
IN-18C11**	18,205	26	18	10	30	9	UT-18/25
IN-20P9**	19,978	26	18	10	30	10	UT-18/25
IN-20 P9-SM**	19,978	26	18	10	30	6,29	UT-18/25
IN-20H7**	20,021	26	18	10	30	10	UT-18/25
IN-20 H7-SM**	20,021	26	18	10	30	6,29	UT-18/25
IN-20D10**	20,149	26	18	10	30	10	UT-18/25
IN-20C11**	20,240	26	18	10	30	10	UT-18/25
IN-22P9**	21,978	26	18	10	30	11	UT-18/25
IN-22 P9-SM**	21,978	26	18	10	30	6,79	UT-18/25
IN-22H7**	22,021	26	18	10	30	11	UT-18/25
IN-22 H7-SM**	22,021	26	18	10	30	6,79	UT-18/25
IN-22D10**	22,149	26	18	10	30	11	UT-18/25
IN-22C11**	22,240	26	18	10	30	11	UT-18/25
IN-25P9**	24,978	26	18	10	30	12	UT-18/25
IN-25 P9-SM**	24,978	26	18	10	30	7,02	UT-18/25
IN-25H7**	25,021	26	18	10	30	12	UT-18/25
IN-25 H7-SM**	25,021	26	18	10	30	7,02	UT-18/25
IN-25D10**	25,149	26	18	10	30	12	UT-18/25
IN-25C11**	25,240	26	18	10	30	12	UT-18/25

Ordering example | : **Model**





## BROACHING TOOL

### INSERTS (INCHES)

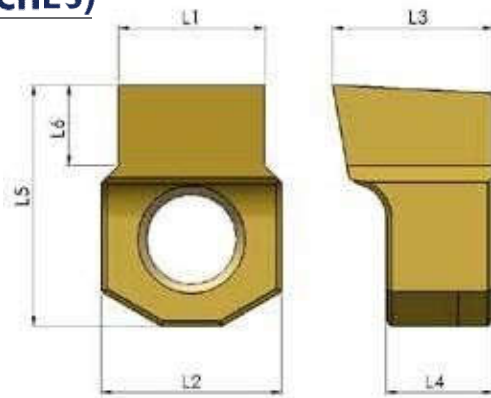

Model	L1 (inch)	L2 (inch)	L3 (inch)	L4 (inch)	L5 (inch)	L6 (inch)	Tool
IN-3/32"-P9	0,0932	0,1968	0,2362	0,1968	0,2559	0,0551	UT-02
IN-3/32"-H7	0,0941	0,1968	0,2362	0,1968	0,2559	0,0551	UT-02
IN-3/32"-D10	0,0961	0,1968	0,2362	0,1968	0,2559	0,0551	UT-02
IN-3/32"-C11	0,0984	0,1968	0,2362	0,1968	0,2559	0,0551	UT-02
IN-1/8"-P9	0,1243	0,2393	0,2559	0,1968	0,2952	0,0905	UT-03
IN-1/8"-H7	0,1254	0,2393	0,2559	0,1968	0,2952	0,0905	UT-03
IN-1/8"-D10	0,128	0,2393	0,2559	0,1968	0,2952	0,0905	UT-03
IN-1/8"-C11	0,1307	0,2393	0,2559	0,1968	0,2952	0,0905	UT-03
IN-5/32"-P9	0,1555	0,2393	0,2755	0,1968	0,3149	0,1141	UT-04
IN-5/32"-H7	0,1567	0,2393	0,2755	0,1968	0,3149	0,1141	UT-04
IN-5/32"-D10	0,1593	0,2393	0,2755	0,1968	0,3149	0,1141	UT-04
IN-5/32"-C11	0,1619	0,2393	0,2755	0,1968	0,3149	0,1141	UT-04
IN-3/16"-P9	0,1868	0,2393	0,2755	0,1968	0,3149	0,1299	UT-05
IN-3/16"-H7	0,1879	0,2393	0,2755	0,1968	0,3149	0,1299	UT-05
IN-3/16"-D10	0,1905	0,2393	0,2755	0,1968	0,3149	0,1299	UT-05
IN-3/16"-C11	0,1932	0,2393	0,2755	0,1968	0,3149	0,1299	UT-05
IN-1/4"-P9	0,2491	0,3968	0,3543	0,2362	0,5314	0,1587	UT-06
IN-1/4"-H7	0,2505	0,3968	0,3543	0,2362	0,5314	0,1587	UT-06
IN-1/4"-D10	0,2538	0,3968	0,3543	0,2362	0,5314	0,1587	UT-06
IN-1/4"-C11	0,2566	0,3968	0,3543	0,2362	0,5314	0,1587	UT-06
IN-9/32"-P9	0,2804	0,3968	0,3543	0,2362	0,5314	0,1692	UT-08
IN-9/32"-H7	0,2818	0,3968	0,3543	0,2362	0,5314	0,1692	UT-08
IN-9/32"-D10	0,2851	0,3968	0,3543	0,2362	0,5314	0,1692	UT-08
IN-9/32"-C11	0,2879	0,3968	0,3543	0,2362	0,5314	0,1692	UT-08
IN-5/16"-P9	0,3116	0,3968	0,3543	0,2362	0,5314	0,1875	UT-08
IN-5/16"-H7	0,313	0,3968	0,3543	0,2362	0,5314	0,1875	UT-08
IN-5/16"-D10	0,3163	0,3968	0,3543	0,2362	0,5314	0,1875	UT-08
IN-5/16"-C11	0,3191	0,3968	0,3543	0,2362	0,5314	0,1875	UT-08
IN-3/8"-P9	0,3741	0,5157	0,5511	0,3937	0,7283	0,2500	UT-10
IN-3/8"-H7	0,3755	0,5157	0,5511	0,3937	0,7283	0,250	UT-10

Ordering example | : **Model**



## BROACHING TOOL

### INSERTS (INCHES)

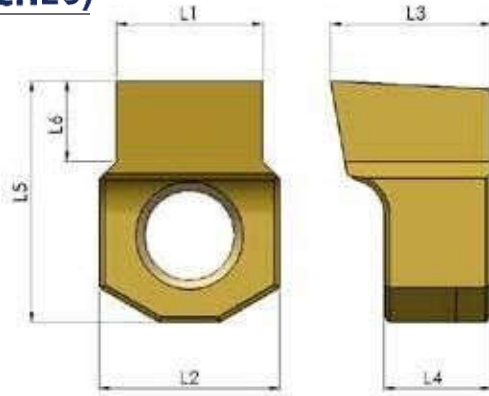

Model	L1 (inch)	L2 (inch)	L3 (inch)	L4 (inch)	L5 (inch)	L6 (inch)	Tool
IN-3/8"-D10	0,3788	0,5157	0,5511	0,3937	0,7283	0,250	UT-10
IN-3/8"-C11	0,3816	0,5157	0,5511	0,3937	0,7283	0,250	UT-10
IN-7/16"-P9	0,4364	0,5157	0,5511	0,3937	0,7283	0,250	UT-12
IN-7/16"-H7	0,4382	0,5157	0,5511	0,3937	0,7283	0,250	UT-12
IN-7/16"-D10	0,4422	0,5157	0,5511	0,3937	0,7283	0,250	UT-12
IN-7/16"-C11	0,4455	0,5157	0,5511	0,3937	0,7283	0,250	UT-12
IN-1/2"-P9	0,4989	0,5157	0,5511	0,3937	0,7283	0,300	UT-12
IN-1/2"-H7	0,5007	0,5157	0,5511	0,3937	0,7283	0,300	UT-12
IN-1/2"-D10	0,5047	0,5157	0,5511	0,3937	0,7283	0,300	UT-12
IN-1/2"-C11	0,508	0,5157	0,5511	0,3937	0,7283	0,300	UT-12
IN-9/16"-P9	0,5614	0,7086	0,5511	0,3937	0,8661	0,275	UT-14/16
IN-9/16"-H7	0,5632	0,7086	0,5511	0,3937	0,8661	0,275	UT-14/16
IN-9/16"-D10	0,5672	0,7086	0,5511	0,3937	0,8661	0,275	UT-14/16
IN-9/16"-C11	0,5705	0,7086	0,5511	0,3937	0,8661	0,275	UT-14/16
IN-5/8"-P9	0,6239	0,7086	0,5511	0,3937	0,8661	0,312	UT-14/16
IN-5/8"-H7	0,6257	0,7086	0,5511	0,3937	0,8661	0,312	UT-14/16
IN-5/8"-D10	0,6297	0,7086	0,5511	0,3937	0,8661	0,312	UT-14/16
IN-5/8"-C11	0,633	0,7086	0,5511	0,3937	0,8661	0,312	UT-14/16
IN-3/4"-P9**	0,7487	1,024	0,7086	0,3937	1,181	0,393	UT-18/25
IN-3/4"-H7**	0,7508	1,024	0,7086	0,3937	1,181	0,393	UT-18/25
IN-3/4"-D10**	0,7558	1,024	0,7086	0,3937	1,181	0,393	UT-18/25
IN-3/4"-C11**	0,7594	1,024	0,7086	0,3937	1,181	0,393	UT-18/25

### TOOLS AND INSERTS FOR SQUARE

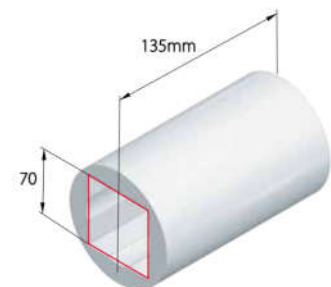

Ordering example | : **Model**



## BROACHING TOOL

### TOOLS FOR SQUARE

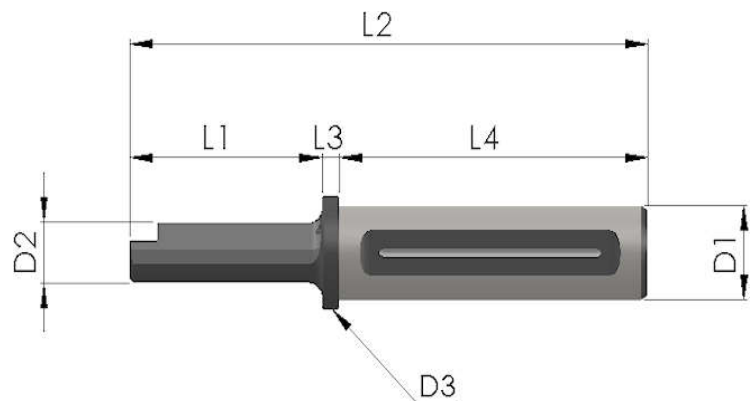

CODE	L1 (mm)	L2 (mm)	L3 (mm)	L4 (mm)	D1 (mm)	D2 (mm)	D3 (mm)	Minimum hole (mm)
UT-SQ-8/10-25	30	129	9	90	25	7,25	30	8
UT-SQ-8/10-32	30	139	9	100	32	7,25	38	8
UT-SQ-10/13-25	40	139	9	90	25	8,6	30	10
UT-SQ-10/13-32	40	149	9	100	32	8,6	38	10
UT-SQ-13/16-25	50	149	9	90	25	12	30	13
UT-SQ-13/16-32	50	159	9	100	32	12	38	13
UT-SQ-16/19-25	52	151	9	90	25	15	30	16
UT-SQ-16/19-32	52	161	9	100	32	15	38	16
UT-SQ-19/27-25	86	185	9	90	25	18,50	30	19
UT-SQ-19/27-32	86	195	9	100	32	18,50	38	19
UT-SQ-27/37-25	100	199	9	90	25	25	30	27
UT-SQ-27/37-32	100	209	9	100	32	25	38	27
UT-SQ-37/50-32	140	249	9	100	32	35	45	37

### INSERTS FOR SQUARE

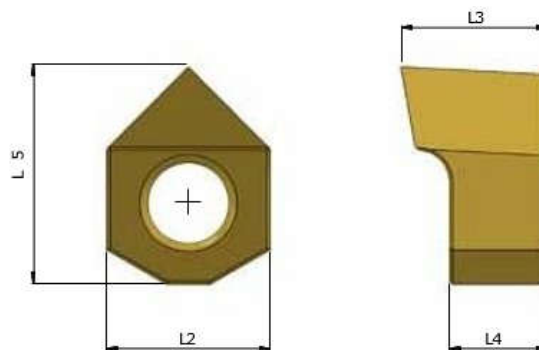

CODE	Working range (mm)	Working range (inches)	L2 (mm)	L3 (mm)	L4 (mm)	L5 (mm)	Tool
IN-SQ-8/10	8mm/10mm	0,314/0,393	6	7	5	7	UT-SQ-8/10
IN-SQ-10/13	10mm/13mm	0,393/0,511	6	7	5	7,5	UT-SQ-10/13
IN-SQ-13/16	13mm/16mm	0,511/0,629	10	8	6	12	UT-SQ-13/16
IN-SQ-16/19	16mm/19mm	0,629/0,748	10	8	6	12,5	UT-SQ-16/19
IN-SQ-19/27	19mm/27mm	0,748/1,062	13	13	10	17	UT-SQ-19/27
IN-SQ-27/37	27mm/37mm	1,062/1,456	18	14	10	22	UT-SQ-27/37
IN-SQ-37/50	37mm/50mm	1,456/1,968	26	18	10	30	UT-SQ-37/50

Ordering example | : **Model**



## BROACHING TOOL

### TOOLS AND INSERTS FOR HEXAGON



### TOOLS FOR HEXAGON

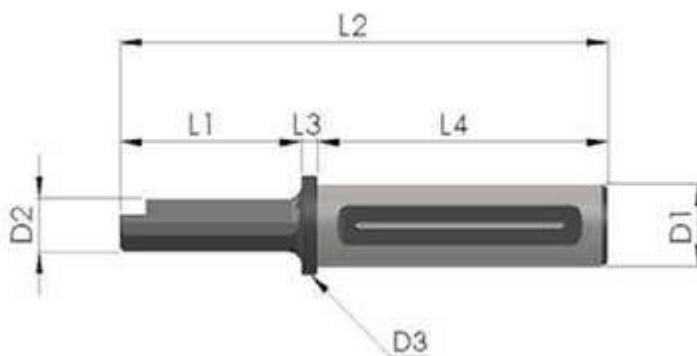

CODE	L1 (mm)	L2 (mm)	L3 (mm)	L4 (mm)	D1 (mm)	D2 (mm)	D3 (mm)	Minimum hole (mm)
UT-HEX-9/11-25	30	129	9	90	25	8	30	9
UT-HEX-9/11-32	30	139	9	100	32	8	38	9
UT-HEX-11/17-25	40	139	9	90	25	10	30	11
UT-HEX-11/17-32	40	149	9	100	32	10	38	11
UT-HEX-17/28-25	56	155	9	90	25	15	30	17
UT-HEX-17/28-32	56	165	9	100	32	15	38	17
UT-HEX-28/37-25	86	185	9	90	25	25	30	28
UT-HEX-28/37-32	86	195	9	100	32	25	38	28
UT-HEX-37/45-25	126	225	9	90	25	35	45	37
UT-HEX-37/45-32	126	235	9	100	32	35	45	37
UT-HEX-45/70-32	140	249	9	100	32	40	45	45

Ordering example | : **Model**



## BROACHING TOOL

### INSERTS FOR HEXAGON

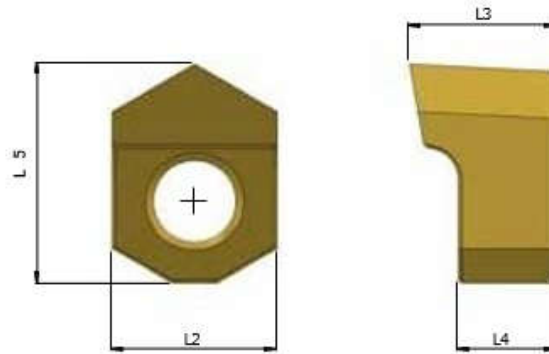

CODE	Working range (mm)	Working range (inches)	L2 (mm)	L3 (mm)	L4 (mm)	L5 (mm)	Tool
IN-HEX-9/11	9mm/11mm	0,354/0,433	6	7	5	7,5	UT-HEX- 9/11
IN-HEX-11/17	11mm/17mm	0,433/0,669	6	7	5	8	UT-HEX- 11/17
IN-HEX-17/28	17mm/28mm	0,669/1,102	10	9	6	13,5	UT-HEX- 17/28
IN-HEX-28/37	28mm/37mm	1,102/1,456	13	14	10	18,5	UT-HEX- 28/37
IN-HEX-37/45	37mm/45mm	1,456/1,771	18	14	10	22	UT-HEX- 37/45
IN-HEX-45/70	45mm/70mm	1,771/2,755	26	16	10	30	UT-HEX- 45/70

Ordering example | : **Model**





## BROACHING TOOL

### BUSHINGS FOR LATHES

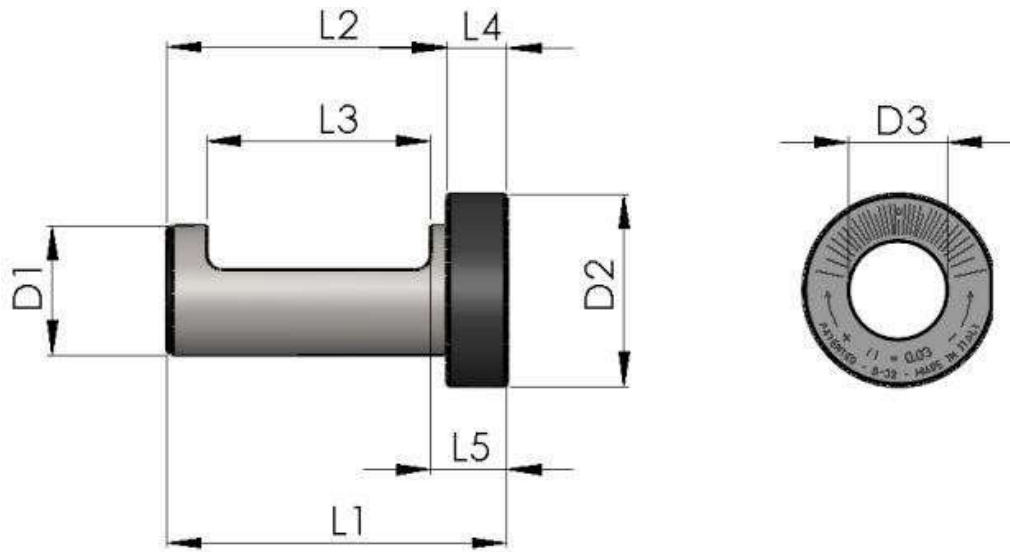

### BUSHINGS FOR LATHES (mm)

Model	L1(mm)	L2(mm)	L3(mm)	L4(mm)	L5(mm)	D1(mm)	D2(mm)	D3(mm)
B-32	85	70	58	15	20	32H7	48	25
B-40	95	80	66	15	20	40H7	55	32
B-50	115	100	75	15	20	50H7	65	32
B-60	115	100	75	15	20	60H7	80	32
B-32VDI	65	50	38	15	20	32H7	48	25
B-40VDI	80	65	51	15	20	40H7	55	32
B-50VDI	95	80	55	15	20	50H7	65	32
B-60VDI	105	80	65	15	20	60H7	80	32

### BUSHINGS FOR LATHES (inches)

Model	L1(inches)	L2(inches)	L3(inches)	L4(inches)	L5(inches)	D1(inches)	D2(inches)	D3(inches)
B-1-1/4"	3,346	2,756	2,283	0,591	0,787	1,250	2,165	0,984
B-1-1/2"	3,740	3,150	2,598	0,591	0,787	1,500	2,165	1,260
B-2"	4,528	3,937	2,953	0,591	0,787	2,000	2,559	1,260
B-1-1/4"-VDI	2,559	1,969	1,496	0,591	0,787	1,250	2,165	0,984
B-1-1/2"-VDI	3,150	2,559	2,008	0,591	0,787	1,500	2,165	1,260
B-2"-VDI	3,740	3,150	2,165	0,591	0,787	2,000	2,559	1,260

Ordering example | : **Model**



# LAME A NASTRO BIMETALLICHE

## BIMETAL BANDSAW BLADES

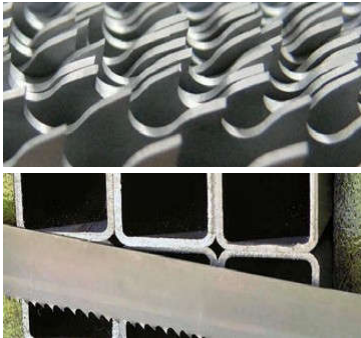

Le nostre seghe a nastro bimetalliche sono fornite in M42 con l'8 di Cobalto (durezza 68-69 HRC) adatte per il taglio di acciai da costruzione e inossidabili ed in M51 con il 10 di Cobalto (durezza 69-70 HRC) per il taglio di acciai molto duri e acciai speciali come inconel, titanio, nimonic e bronzi speciali. La qualità delle nostre lame a nastro garantiscono le più elevate performance di rendimento nel taglio di tutti i materiali impiegati nella meccanica. Possono essere fornite con dentatura fissa o variabile e con tipologie di denti e stradature diverse in base alle applicazioni richieste dal cliente.

*Our bimetal bandsaw blades are supplied in M42 8 Cobalt (hardness 68-69 HRC) suitable for cutting steels and stainless steels and in M51 with 10 Cobalt (hardness 69-70 HRC) for cutting very hard steels and special steels such as Inconel, Titanium, Nimonic and special bronzes. The quality of our bandsaw blades ensure the highest performance efficiency in the cutting of all materials used in mechanical applications. They can be supplied with fixed or variable teeth with different types of teeth and stradature in order of the applications required from the customer.*

### Forma del dente – Tooth form

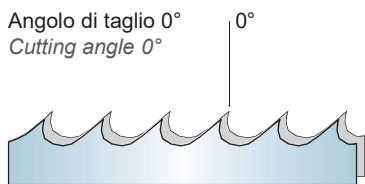

Angolo di taglio 0°  
Cutting angle 0°

Fornibile con dentatura fissa o variabile  
Available with constant and vario teeth

#### Dente tipo N – Tooth type N

La dentatura standard tipo N ha un angolo di taglio di 0°.

Questo tipo di dente è adatto per il taglio di piccole e medie sezioni di acciaio, tubi o profilati con sezioni irregolari.

*The standard teeth (N) have a 0° cutting angle.*

*This tooth form is suitable for cutting small and medium steel sections, tubes or profiles with irregular sections.*

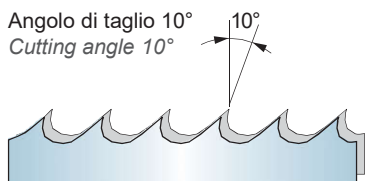

Angolo di taglio 10°  
Cutting angle 10°

Fornibile con dentatura fissa o variabile  
Available with constant and vario teeth

#### Dente tipo H – Tooth type H

Le differenze tra il dente H (Hook) e il dente N sono: l'angolo di taglio di 10° e la capacità di tagliare grandi sezioni.

Il dente è adatto per il taglio di grandi sezioni di acciaio o lavorazioni generiche. La dentatura H permette di aumentare l'avanzamento aumentando la velocità di taglio (a seconda del materiale da tagliare).

*The differences between H (Hook) and N tooth type are: the tooth angle of 10° and the possibility of cutting big sections.*

*This tooth type is used for cutting big steel sections or general use. H tooth type allows feed increase, increasing the cutting speed (depending from the material to cut).*

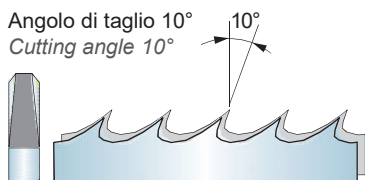

Angolo di taglio 10°  
Cutting angle 10°

Fornibile con dentatura fissa o variabile  
Available with constant and vario teeth

#### Dente tipo T – Tooth type T

Il dente T è stato introdotto per il taglio di materiali difficili.

Questo speciale dente è dotato di smussi laterali per migliorare la rottura del truciolo. Questo particolare permette di rimuovere più materiale e meglio distribuire la forza sulla lama. Il dente T è consigliato per il taglio di grandi sezioni di materiale impegnativo quale acciaio inox, acciaio altamente legato e acciaio temperato.

*T tooth form was introduced for cutting difficult materials.*

*This special tooth form has side chamfers to improve chip removal. This particular allows more chip removal and better distribution of the force on the blade. The T tooth form is suggested for cutting big sections of difficult materials such as stainless steel, high alloy steels and tempered steels.*

### Passo del dente – Tooth pitch



Passo fisso: distanza costante fra i denti  
Constant pitch: constant tooth spacing



Passo variabile: gruppi di denti con passo variabile  
Variable pitch: groups of teeth with variable pitch

Ordering example | : **Model**



# LAME A NASTRO BIMETALLICHE

## BIMETAL BANDSAW BLADES

### Scelta passo per taglio sezioni piene – Pitch selection for solid section cutting

Dentatura regolare – Constant pitch		Dentatura passo variabile – Variable pitch	
Sezione da tagliare Section to cut mm	Dente fisso Constant pitch	Sezione da tagliare Section to cut mm	Passo variabile Variable pitch
<10	14	<20	10/14
10 ÷ 30	10	15 ÷ 40	8/12
30 ÷ 50	8	25 ÷ 50	6/10
50 ÷ 80	6	35 ÷ 90	5/8
80 ÷ 120	4	70 ÷ 120	4/6
120 ÷ 200	3	80 ÷ 180	3/4
200 ÷ 400	2	130 ÷ 400	2/3

### Scelta passo per taglio tubi e profilati – Pitch selection for tubes and profiles cutting

Spessore parete Wall-thickness mm	Diametro esterno (mm) / Selezione della dentatura Outside diameter / Tooth selection								
	20	40	60	80	100	120	150	200	300
2÷3	14	10/14	10/14	10/14	10/14	10/14	10/14	10/14	10/14
3÷4	14	10/14	8/12	8/12	8/12	8/12	8/12	8/12	8/12
5÷6	10/14	8/12	8/12	6/10	6/10	6/10	6/10	6/10	6/10
8÷10	10/14	8/12	6/10	5/8	5/8	5/8	5/8	5/8	5/8
12÷15		8/12	6/10	4/6	4/6	4/6	4/6	4/6	4/6

### Regole per la fornitura – Supply rules

Altezza e spessore Height and thickness mm	Materiale Material	Fornitura minima Minimum order Pz	Sviluppi minimi dei rotoli Minimum coil length mt
13 x 0,65	M42	5 anelli _ 5 rings	100
13 x 0,90	M42	5 anelli _ 5 rings	100
20 x 0,90	M42	5 anelli _ 5 rings	150
27 x 0,90	M42-M51	5 anelli _ 5 rings	150
34 x 1,10	M42-M51	5 anelli _ 5 rings	130
41 x 1,30	M42-M51	5 anelli _ 5 rings	90
54 x 1,3/1,6	M42-M51	5 anelli _ 5 rings	50

Gli anelli saldati vengono forniti con sviluppi incrementali di 5 mm – The rings are supplied with incremental length of 5 mm

### Disponibilità indicative delle tipologie di dente – Approx. availability of the teeth

Dimensioni Dimensions mm	Denti per pollice – Tooth per inch														
	1,25	2	3	4	6	8	10	14	2/3	3/4	4/6	5/8	6/10	8/12	10/14
13 x 0,6					H	N	N	N						N	N
13 x 0,9					H	N	N	N						N	N
20 x 0,9			H	H							H	N	N	N	N
27 x 0,9			N+H+T	N+H+T	N	N	N	N	H	N+H+T	N+H	N	N	N	N
34 x 1,1			N+H+T	N+H+T	N	N	N		H+T	H+T	N+H	N	N	N	
41 x 1,3	T	T	N+T	N+T	N				H+T	H+T	N+T		N		
54 x 1,3															

Ordering example | : **Model**



